

CAPITAL COST FOR SOLID WASTE MANAGEMENT OF KOTBA NAGAR PANCHAYAT KOTBA, DIST-JASHPUR, C.G		
S.NO.	ESTIMATE	AMOUNT (Rs.)
<b>A</b>	<b>DESCRIPTION</b>	
<b>I</b>	<b>Cost for Compost Plant</b>	
	<b>Windrow Compost Plant-W.no-08</b>	
1	WINDROW-1 No(2 TPD)	8,50,532.10
2	LEACHATE COLLECTION TANK	77,425.82
3	FENCING	1,66,966.84
	Total a)	10,94,924.76
<b>b)</b>	<b>Machinery/Equipment's (Non Sor Items)</b>	
1	WHEEL BARROW - 02 No.	11,000.00
2	SURVEILLANCE CAMERA	17,813.00
3	COMPOST SIEVE MACHINE	47,500.00
	Total b)	76,313.00
	Add 18% GST	13,736.34
	Grand Total b)	90,049.34
	<b>Total of Compost Plant-I (a+b)</b>	<b>11,84,974.10</b>
<b>B</b>	<b>Cost for MRF/SLRM Plant</b>	
<b>I</b>	<b>MRF/SLRM I -W.no-08</b>	
<b>a)</b>	<b>Civil Work ( Sor Items)</b>	
1	REVAMPING OF CIVIL INFRASTRUCTURE	3,33,809.92
2	RAINWATER HARVESTING	28,004.92
3	SHED FOR STORAGE OF BALED AND RECYCLABLE MATERIAL	5,86,766.20
	Total a)	9,48,581.04
<b>b)</b>	<b>Machinery/Equipment's (Non Sor Items)</b>	
1	BALE TROLLEY-03 No	20,400.00
2	WEIGHBRIDGE - 1 No	2,25,000.00
3	TURBINE VENTILATOR	15,000.00
4	SURVEILLIANCE CAMERA	17,813.00
5	FLAT CONVEYOR BELT	1,55,000.00

6	HDPE WHEELED CONTAINER 100 LITRE-10 NO.	13,750.00
	Total b)	4,46,963.00
	Add 18% GST	80,453.34
	Grand Total b)	5,27,416.34
	Total of MRF/SLRM-I (a+b)	14,75,997.38
	Total Capital Cost (A+B)	26,60,971.48
	Contingency @1%	26,609.71
	Add Consultancy Charges on Capital Cost @ 1.16%	30,867.27
	Grand Total	27,18,448.46



SOR = 20.44 lac  
 Non SOR = 5.23 lac  
 Cost Cont. = 1.52 lac  
 22-19 lac  
 Sub.Engineer  
 Nagar Panchayat  
 Kotba  
 C.M.O  
 Nagar Panchayat  
 Kotba

सलग्न पत्र के शर्तों के अधीन जारी।

T.S. No. 17 Date 02.04.26  
 Technical Sanction of Nagar Nigam/Palika/  
 Panchayat Kotba Hereby Granted  
 for the Construction of Ramping work of SRM &  
 Comfort shed  
 In Ward No. For Rs. 22.19 Lacs  
 (In Words) Rs. Twenty seven lac nineteen  
 thousands  
 02.04.26  
 Checked by A.E. Superintending Engineer  
 U & D. Ambikapur (C.G.)

# **NAGAR PANCHAYAT, KOTBA, DIST-JASHPUR, C.G**

## **GENERAL ABSTRACT OF COST FOR REVAMPING WORK OF EXISTING SLRM CENTRE AT WARD NO-08**

Based on C. G. P.W.D S.O.R. IN FORCE FROM 1 JAN 2015

SN	DESCRIPTION OF ITEM	TOTAL
<b>a</b>		
I	REVAMPING OF CIVIL INFRASTRUCTURE	3,33,809.92
II	RAINWATER HARVESTING	28,004.92
III	SHED FOR STORAGE OF BALED AND RECYCLABLE MATERIAL	5,86,766.20
<b>Total</b>		<b>9,48,581.04</b>
<b>b</b>	<b>Machinery/Equipment's (Non Sor Items)</b>	
I	BALE TROLLEY-03 No	20,400.00
II	WEIGHBRIDGE - 1 No	2,25,000.00
III	TURBINE VENTILATOR	15,000.00
IV	SURVEILLIANCE CAMERA	17,813.00
V	FLAT CONVEYOR BELT	1,55,000.00
VI	HDPE WHEELED CONTAINER 100 LITRE-10 NO.	13,750.00
Total b)		4,46,963.00
Add 18% Gst		80,453.34
Grand Total b)		5,27,416.34
<b>Total of MRF/SLRM-I (a+b)</b>		<b>14,75,997.38</b>



*Signature*  
**Sub.Engineer**  
Nagar Panchayat  
Kotba

*Signature*  
**C.M.O**  
Nagar Panchayat  
Kotba



## NAGAR PANCHAYAT, KOTBA, DIST-JASHPUR, C.G

## DETAILED ESTIMATE FOR REVAMPING WORK OF EXISTING SLRM CENTRE AT WARD NO.08

Based on C. G. P.W.D ROAD S.O.R. IN FORCE FROM 1 JAN 2015

SN	DESCRIPTION OF ITEM	NO	MEASUREMENT			QTY	RATE	UNIT	AMOUNT
			L	B	H/D				
1	12.49 25 mm thick KOTA stone slab flooring over 20mm (Average) thick base of cement mortar 1:4 laid over and jointed with grey cement slurry mixed with pigment to match the shade of the slab including grinding rubbing and polishing etc. complete (Area of slab to be over 0.20 sqm and upto 0.50 sqm)								
	Flooring	1	27.50	10.00		275.00			
	<b>total</b>					<b>275.00</b>	<b>897.00</b>	<b>sqm</b>	<b>2,46,675.00</b>
2	19.42 Providing and placing on terrace (at all floor levels) polyethylene water storage tank ISI : 12701 marked with cover and suitable locking arrangement and making necessary holes for inlet, outlet and overflow pipes but without fittings and the base support for tank <b>PWD S.O.R.-P-184/I-19.42</b>								
	Water Tank	1	1200.00			1200.00			
	<b>total</b>					<b>1200.00</b>	<b>7.30</b>	<b>Litre</b>	<b>8,760.00</b>
3	12.10 Providing and laying rectified ceramic glazed floor tiles of size 300x 300mm and above conforming to IS : 15622 of approved make, colour, shade laid on 20 mm thick Cement Mortar 1:4 (1 cement : 4 coarse sand) including pointing the joints with white cement mixed with matching pigment etc.  12.10.2 Size above 300x300mm <b>PWD S.O.R.-P-112/I-12.10.1</b>								
	TOILET	1	3	2.00	1.20	7.20			
	<b>total</b>					<b>7.20</b>	<b>905.00</b>	<b>sqm</b>	<b>6,516.00</b>
4	Providing and applying Aluminium paint minimum 2 coats in all metal surface applying @ 0.75 li/ 10 Sqm up to required finish as per relevant I.S. code 2932: 2013 of (Product such as Asian Apcolite aluminium paint, Dulux Aluminium paint, Burger Superior Aluminium Paint) with all tools tackle and labour etc. complete for the work  <b>As per Ammendment no 08, 05/05/2025 item no.14.76</b>								
	Main Gate	2	1	3.50	1.80	12.60			
	Fencing	2	1	95.00	1.80	342.00			
	<b>total</b>					<b>354.60</b>	<b>43.00</b>	<b>sqm</b>	<b>15247.80</b>
5	Providing and applying Acrylic washable Distemper or lite economy Plastic emulsion paint having VOC content less than 50gms/ lit Minimum two coats up to final finish applied @ 1.25 Kg/ 10Sqm as per relevant L.S. Code 428:2000 (product such as Tractor Uno, Dulux Duval, Berger Bison, Opus Style/lite economy emulsion product such as Asian Tactor Spark Dulux Pomise sheen, Neroloc Lital Master, Berger Bison Lite, Nippon Superio.) inclusive of providing abro tape on edges and article and cleaning of door, windows, floor and surface as required with all tools tackles and labour complete for the work.  <b>As per Ammendment no 08, 05/05/2025 item no.14.62</b>								
		1	2	24.00	0.90	43.20			
		1	6	3.00	3.00	54.00			
		1	3	10.00	3.00	90.00			
		1	1	10.00	0.90	9.00			
	<b>Subtotal</b>					<b>196.20</b>			
	<b>Deductions</b>								
	D1(3500X2100)	1	3.50	1.80	6.30				
	D2(1200X2100)	3	1.20	2.10	7.56				



[illegible]

## EXTERNAL DEVELOPMENT-RAIN HARVESTING

Based on C. G. P.W.D ROAD S.O.R. IN FORCE FROM 1 JAN 2015

SN	DESCRIPTION OF ITEM	1	NO	MEASUREMENT				QTY	RATE	UNIT	AMOUNT
I	II		III	IV	V	VI	VII	VIII	IX	X	
1	Excavation for all types and sizes of foundations, trenches and drains or for any other purpose including disposal of excavated stuff upto 1.5 m lift and lead upto 50m (at least 5m away from the excavated area), including dressing and leveling of pits.  [PWD SOR I - 8 , P-1.1]		1	1.40	1.40	1.50	2.94				
	total						2.94	185.00	cum	543.90	
2	Providing and laying nominal mix cement concrete with crushed stone aggregate using concrete mixer in all works upto floor five level excluding cost of form work. (i) 1:3:6 (1 cement : 3 coarse sand : 6 graded stone aggregate 20mm nominal size) [S.O.R. Page no.23 Item no 3.1.3]		1 1	1.00 1.00	0.30 0.30	0.15 0.15	0.05 0.05				
	total						0.09	2970.00	cum	267.30	
3	Brick work with modular well burnt clay bricks of crushing strength not less than 25 kg/sqcm and water absorption not more than 20% in foundation and plinth in: Cement Mortar 1:6 (1 Cement : 6 Coarse Sand) [S.O.R. Page no.44 Item no 7.2.2]		2 2	1.00 1.00	0.20 0.20	1.50 1.50	0.60 0.60				
	total						1.20	3635.00	cum	4,362.00	
4	Providing and filling in plinth with sand/ Crusher dust and hard moorum under floor in layers not exceeding 20cm in depth consolidating each deposited layer by ramming and watering, including dressing etc. complete. [S.O.R. Page no. 9 Item no. 1.18]		1	1.00	1.00	1.40	1.40				
	total						1.40	371.00	cum	519.40	
5	Providing and fixing form work including centring, shuttering, strutting, staging, propping bracing etc. complete and including its removal at all levels, for: Suspended floors, roofs, access platform, balconies (plain surfaces) and shelves (cast in situ) [S.O.R. Page no. 16 Item no. 2.1.7]		4	1.40	1.50	-	8.40	235.00			
	total						8.40	235.00	sqm	1,974.00	
6	Providing and laying nominal mix reinforcement cement concrete with crushed stone aggregate using concrete mixer in all works upto floor five level excluding cost of reinforcement and form work. 1:1½:3 (1 cement : 1½ coarse sand : 3 graded stone aggregate 20mm nominal size). [PWD SOR Page No. 23 I No. 3.2.1]		1	1.40	1.40	0.15	0.29				
	total						0.29	4163.00	cum	1,223.92	
7	Providing and placing in position cold tor steel and hot rolled deform steel reinforcement of R.C.C. work including cutting binding etc. complete as per drawing including cost of binding wire and all wastages etc. complete. PWD S.O.R.-P-24/I-3.12.1		-	-	-	-	23.20				
	total						23.20	54.50	Kg	1,264.40	
8	providing, laying and jointing following UPVC pipes with solvent cement joint for 4, 6, 8 and 10 Kg / sqm pressures including, testing of joints, complete in all respect.	1	1	50.00	-	-	50.00	357.00			
	total						50.00	357.00	mtr	17,850.00	
Total										28,004.92	

**NAGAR PANCHAYAT KOTBA, JASHPUR, C.G**  
**DETAILED ESTIMATE FOR CONSTRUCTION OF SHED FOR BALED & RECYCLABLE MATERIAL AT EXISTING SLRM CENTER AT KOTBA**  
**(10.00MX5.00M)**

Based on C. G. P.W.D BUILDING S.O.R. IN FORCE FROM 1 JAN 2015

SN	DESCRIPTION OF ITEM	NOS	MEASUREMENT			QTY	RATE	UNIT	AMOUNT
			L	B	H/D				
I	II	III	IV	V	VI	VII	VIII	IX	X
(I) Foundation level of Ground Floor									
1	1.1 Excavation for all types and sizes of foundations, trenches and drains or for any other purpose including disposal of excavated stuff upto 1.5 m lift and lead upto 50m (at least 5m away from the excavated area), including dressing and level 1.1.1 In all types of soils. F1(1500X1500)	12	1.50	1.50	1.50	40.50			
	<b>total</b>					<b>40.50</b>	<b>185.00</b>	<b>cum</b>	<b>7,492.50</b>
2	1.18 Providing and filling in plinth with sand/ Crusher dust and hard moorum under floor in layers not exceeding 20cm in depth consolidating each deposited layer by ramming and watering, including dressing etc complete. F1(1500X1500)	12	1.50	1.50	0.10	2.70			
	<b>total</b>					<b>2.70</b>	<b>371.00</b>	<b>cum</b>	<b>1,001.70</b>
3	3.1 Providing and laying nominal mix plain cement concrete with crushed stone aggregate using concrete mixer in all works upto plinth level excluding cost of form work. 3.1.3 1:3:6 (1 cement : 3 coarse sand : 6 graded stone aggregate 40mm nominal size). F1(1500X1500)	12	1.50	1.50	0.15	4.05			
	<b>total</b>					<b>4.05</b>	<b>2970.00</b>	<b>cum</b>	<b>12,028.50</b>
4	2.1 Providing and fixing form work including centring, shuttering, strutting, staging, propping bracing etc. complete and including its removal 2.1.1 Foundations, footings, bases of columns plinth beam, curtain wall in any shape and size and all type of wall below plinth level. <b>Footing</b> F1(1500X1500) C1(200X300) <b>Ground Beam</b> PB1(200X300) PB2(200X300)	2 2 2 2 2 2 2 2	12 12 12 12 8 3 4	1.20   0.30  2.25 4.40 2.05	  0.20 0.20 1.30 1.30  0.30 0.30 0.30	5.76 5.76 6.24 9.36  10.80 7.92 4.92			
	<b>total</b>					<b>50.76</b>	<b>139.00</b>	<b>sqm</b>	<b>7,055.64</b>
5	3.2 Providing and laying nominal mix reinforced cement concrete with crushed stone aggregate using concrete mixer in all works up to plinth level excluding cost of form work 3.2.1 1:1½:3 (1 cement : 1½ coarse sand : 3 graded stone aggregate 20mm nominal size). <b>Column</b> F1(1500X1500) $0.3/6*((1.2*1.2)+(0.3*0.2)+(4*(1.2+0.3)/2*(1.2+0.2)/2))$ C1(200X300) <b>Sub Total</b> <b>Ground beam</b> X-WALL L-WALL <b>Sub Total</b>	12 12 12 8 3 4	1.20 0.20 0.20 2.25 4.40 2.05	1.20 0.30 0.30 0.20 0.20 0.20	0.20 0.18 1.30  0.30 0.30 0.30	3.46 2.16 0.94  1.08 0.79 0.49			
	<b>total</b>					<b>8.92</b>	<b>4163.00</b>	<b>cum</b>	<b>41,421.85</b>



SN	DESCRIPTION OF ITEM	NOS	MEASUREMENT			QTY	RATE	UNIT	AMOUNT
			L	B	H/D				
I	II	III	IV	V	VI	VII	VIII	IX	X
6	3.12 Providing and placing in position reinforcement for R.C.C. work including straightening, cutting, bending, binding etc. complete as per drawings including cost of binding wire in foundation 3.12.1 Thermo-Mechanically treated bars FE 415 (1.5% of R.C.C. area)		8.92	1.50	78.50	1049.86			
	<b>total</b>					<b>1171.61</b>	<b>54.50</b>	<b>Kg</b>	<b>63,852.75</b>
7	1.17 Filling from available excavated stuff (Excluding rock) in trenches, plinth, sides of foundation etc. in layers not exceeding 20cm in depth consolidating each deposited layer by ramming and watering with a lead upto 50 M. and lift upto 1.5 M. Total qty of excavation - sand filling+PCC+RCC upto GL					27.20			
	<b>total</b>					<b>27.20</b>	<b>65.00</b>	<b>cum</b>	<b>1,767.87</b>
8	7.5 Brick work with modular fly-ash lime bricks (FaLG Bricks) confirming to IS:12894-2002 of class designation 4.0 in foundation and plinth in: 7.5.4 Cement Mortar 1:6 (1 cement : 6 coarse sand) Below plinth	8 3 4	2.25 4.40 2.05	0.20 0.20 0.20	0.60 0.60 0.60	2.16 1.58 0.98			
	<b>total</b>					<b>4.73</b>	<b>3263.00</b>	<b>cum</b>	<b>15,427.46</b>
9	2.1 Providing and fixing form work including centring, shuttering, strutting, staging, propping bracing etc. complete and including its removal 2.1.5 Columns, Pillars, Piers and likes- rectangular or square in shape <b>Column</b> C1(200X300)	2 2	12 12	0.20 0.30	3.50 3.50	16.80 25.20			
	<b>total</b>					<b>42.00</b>	<b>297.00</b>	<b>sqm</b>	<b>12,474.00</b>
11.1	2.1.8 Beams, lintels, cantilevers & walls <b>Lintel Beam</b> LB1 LB2	2 2	1 11	1.80 1.20	0.15 0.15	0.54 3.96			
	<b>total</b>					<b>4.50</b>	<b>202.00</b>	<b>sqm</b>	<b>909.00</b>
10	3.2 Providing and laying nominal mix reinforced cement concrete with crushed stone aggregate using concrete mixer in all works up to plinth level excluding cost of form work 3.2.1 1:1½:3 (1 cement : 1½ coarse sand : 3 graded stone aggregate 20mm nominal size). <b>Column</b> C1(200X300) <b>Lintel Beam</b> LB1 LB2	12 1 11	0.20 1.80 1.20	0.30 0.20 0.20	3.50 0.15 0.15	2.52 0.05 0.40			
	<b>total</b>					<b>2.97</b>	<b>4163.00</b>	<b>cum</b>	<b>9,824.68</b>
11	3.12 Providing and placing in position reinforcement for R.C.C. work including straightening, cutting, bending, binding etc. complete as per drawings including cost of binding wire in foundation and plinth all complete: 3.12.1 Thermo-Mechanically treated bars FE 415 (1.5% of R.C.C. area)		2.97	1.50	78.50	277.89			
	<b>total</b>					<b>277.89</b>	<b>54.50</b>	<b>Kg</b>	<b>15,145.01</b>
12	7.5 Brick work with modular fly-ash lime bricks (FaLG Bricks) confirming to IS:12894-2002 of class designation 4.0 in foundation and plinth in: 7.5.4 Cement Mortar 1:6 (1 cement : 6 coarse sand)								

SN	DESCRIPTION OF ITEM	NOS	MEASUREMENT			QTY	RATE	UNIT	AMOUNT
			L	B	H/D				
I	II	III	IV	V	VI	VII	VIII	IX	X
	7.6 Extra for brick work in superstructure above plinth level for every floor or part thereof in addition to rate for foundation and plinth: <b>PWD S.O.R.-P-45/I-7.5+7.6</b> Above Plinth	8	2.25	0.20	3.50	12.60			
		3	4.40	0.20	3.50	9.24			
		4	2.05	0.20	3.50	5.74			
	<b>Subtotal</b>					<b>27.58</b>			
	Deductions	1	1.80	0.20	2.10	0.76			
	D1(1800X2100)	11	1.20	0.20	1.20	3.17			
	W1(1200X1200)					<b>3.92</b>			
	<b>Subtotal</b>					<b>23.66</b>	<b>3384.00</b>	<b>cum</b>	<b>80,051.90</b>
	<b>total</b>								
13	8.52 Providing, and fixing M.S. round and square bars with MS flat of required pattern in wooden frames for windows & clerestory windows including applying a priming coat of red oxide zinc chromate primer, welding etc complete								
	8.52.1 Plain grill W1(1200X1200)	11	1.20	0.20	1.20	3.17			
	<b>total</b>					<b>3.17</b>	<b>68.00</b>	<b>Kg</b>	<b>215.42</b>
14	<b>Plaster</b>								
	<b>Internal Plaster</b>								
	Store Room	1	2	10.00	3.50	70.00			
		1	2	5.00	3.50	35.00			
	<b>subtotal</b>					<b>105.00</b>			
	<b>Deductions</b>								
	D1(1800X2100)	1	1.80	2.10	3.78				
	W1(1200X1200)	11	1.20	1.20	15.84				
	<b>subtotal</b>					<b>19.62</b>			
	<b>Total Internal Plaster</b>					<b>85.38</b>		<b>sqm</b>	
	<b>External Plaster</b>								
	External Wall	2	10.40	3.50	72.80				
		2	5.40	3.50	37.80				
	<b>subtotal</b>					<b>110.60</b>		<b>sqm</b>	
	<b>Deductions</b>								
	D1(1800X2100)	1	1.80	2.10	3.78				
	W1(1200X1200)	11	1.20	1.20	15.84				
	<b>subtotal</b>					<b>19.62</b>			
	<b>Total External Plaster</b>					<b>90.98</b>		<b>sqm</b>	
	<b>Total Quantity of Plaster (External+Internal)</b>					<b>176.36</b>		<b>sqm</b>	
14.1	11.2 Providing and making 12mm thick cement plaster of mix:								
	11.2.3 In Cement Mortar 1:5 (1 cement : 5 fine sand)								
	<b>total</b>					<b>85.38</b>			
	<b>total</b>					<b>85.38</b>	<b>91.50</b>	<b>sqm</b>	<b>7,812.27</b>
14.2	11.3 Providing and making 15mm thick cement plaster on the rough side of single or half brick wall of mix:								
	11.3.3 In Cement Mortar 1:5 (1 cement : 5 fine sand)								
	<b>total</b>					<b>90.98</b>			
	<b>total</b>					<b>90.98</b>	<b>113.00</b>	<b>sqm</b>	<b>10,280.74</b>
15	12.4 52 mm thick cement concrete flooring with under layer of 40mm thick cement concrete 1:2:4 (1 cement : 2 coarse sand : 4 graded stone aggregate 20mm nominal size) and top layer of 12 mm thick cement metallic hardener concrete mix 1:2 (1 cement hardener mix : 2 stone aggregate of 6 mm size by volume) with metallic hardening compound of approved quality mixed with cement in ratio of 4:1 (4 cement : 1 metallic floor hardening compound by weight) including finishing etc. complete.								
		1	10.00	5.00		50.00			

SN	DESCRIPTION OF ITEM	NOS	MEASUREMENT			QTY	RATE	UNIT	AMOUNT
			L	B	H/D				
I	II	III	IV	V	VI	VII	VIII	IX	X
	<b>total</b>					<b>50.00</b>	<b>441.00</b>	<b>sqm</b>	<b>22,050.00</b>
16	<p>9.10 Providing and fixing M.S. grill of approved pattern made of M.S. flats or square or round bars welded to steel frame of windows etc. including applying a priming coat of red oxide zinc</p> <p><b>PWD S.O.R.-P-81/I-9.15</b></p> <p>W1(1200X1200)</p> <p><b>_@15.0Kg/sqm approx</b></p>	11	1.20		1.20	15.84 15.84 228.89			
	<b>total</b>					<b>228.89</b>	<b>67.50</b>	<b>KG</b>	<b>15,449.94</b>
17	<p>9.47 Providing and fixing aluminium work for doors, windows, ventilators and partitions made out of extruded aluminium standard sections (main section with minimum 1.5mm thickness) conforming to IS: 733, IS: 1285 mitred and jointed mechanically including aluminium cleats, neoprene weather stripping gasket beveled edge beading, screws duly fixed in wall/ floor with fixing clips or hold fasteners or bolts and nuts as required aluminium sections shall be anodized transparent or dyed to approved shade according to IS: 1868, minimum anodic coating shall be of grade AC-15. (Glazing to be paid for separately:</p> <p>9.47.2 For shutter of doors, windows &amp; ventilators including providing and making provision for fixing of fitting wherever required including the cost of PVC/ neoprene gasket required (Fittings shall be paid for separately).</p> <p><b>PWD S.O.R.-P-85/I-9.47.2</b></p> <p>W1(1200X1200)</p> <p><b>_@5.0Kg/sqm approx</b></p>	11	1.20		1.20	15.84 15.84 79.20			
	<b>total</b>					<b>79.20</b>	<b>338.00</b>	<b>Kg</b>	<b>26,769.60</b>
18	<p>9.51 Providing and fixing glazing in aluminium door, window, ventilator shutters and partitions etc. with PVC/ neoprene gasket etc. complete. (Cost of aluminium snap beading shall be paid in basic item):</p> <p>9.51.1 With float glass panes of 5 mm thickness</p> <p>W1(1200X1200)</p>	11	1.20		1.20	15.84			
	<b>total</b>					<b>15.84</b>	<b>611.00</b>	<b>sqm</b>	<b>9,678.24</b>
19	<p>14.22.1 Providing and applying Aluminium paint minimum 2 coats in all metal surface applying @ 0.75 li/ 10 Sqm up to required finish as per relevent I.S. code 2932: 2013 of (Product such as Asian Apcolite aluminium paint, Dulux Aluminium paint, Burger Superior Aluminium Paint) with all tools tackle and labour etc. complete for the work</p> <p><b>As per Ammendment no 08, 05/05/2025 item no.14.76</b></p> <p>Grill</p> <p>W1(1200X1200)</p> <p>Door</p>	11	1.20		1.20	15.84			
	<b>total</b>	1	1.8		2.1	3.78			
	<b>total</b>					<b>19.62</b>	<b>43.00</b>	<b>sqm</b>	<b>843.66</b>



SN	DESCRIPTION OF ITEM	NOS	MEASUREMENT			QTY	RATE	UNIT	AMOUNT
			L	B	H/D				
I	II	III	IV	V	VI	VII	VIII	IX	X
20	14.56 Providing and applying 2mm thick white cement based polymeric Exterior grade Putty with minimum 3 coats applied @ 5.4 kg/ 10Sqm as per relevant IS code 17545 2021 (Product such as Birla wall care, Asian trucare,JK wall putty, Berger Bison wall putty) to make the surface smooth and even with all tools tackles and labour etc. complete for the work  As per Ammendment no 08, 05/05/2025 item no.14.56								
						Area of internal Plaster	85.38		
						Area of External Plaster	90.98		
						85.38	86.00	sqm	7,342.68
	total								
21	14.59 Providing and applying Polymaric cement primer on all surface applied @ 0.80 litres/10 sqm as per relevant IS. code 15489:1974 (product such as Birla white primacoat/activcoat, Asian Trucare , Dulux interior cement primer, Opus Calista / 110) with all tool tackles and labour etc. complete for the work.  As per Ammendment no 08, 05/05/2025 item no.14.59								
						Area of internal Plaster	85.38		
						85.38	29.00	sqm	2,476.02
	total								
22	14.63 Providing and applying Economy Plastic emulsion paint with roller application minimum three coats applied @ 1.25 lit / 10 Sqm up to final finish as per relevant I.S. Code 15489:2013_Type -1 Class D & C (Glossy and Semi Glossy Finish) of required shade (product such as Tractor emulsion, Dulux Promise, Nerolac Bueaty Silver, Berger bison/breeze , Opus 130/ Style Paint) inclusive of providing abro tape on edges and article and cleaning of door, windows, floor and surface as required with all tools tackles and labour complete for the work . (With 2 Year warranty).  As per Ammendment no 08, 05/05/2025 item no.14.63								
						Area of internal Plaster	85.38		
						85.38	74.00	sqm	6,318.12
	total								
23	14.67 Providing and applying on exterior surface with ECONOMY Exterior Emulsion paint of required shades to give protective and water proof finish minimum three coats applied @ 1.43 lit / 10Sqm up to final finish as per relevant I.S. Code 15489:2013 Type -2 Class D,C (Glossy /Semi Glossy finish ) (Product such as Asian Ace,Dulux Promise Exterior Berger Wall Masta ,Nerolac Suraksha Plus , Nippon Shogun Opus, One Style Power Bright) inclusive of providing abro tape on edges and article and cleaning of door, windows, floor and surface as required with all tools tackles and labour etc. complete for the work (With 2 Year Warranty)  As per Ammendment no 08, 05/05/2025 item no.14.67								
						Area of External Plaster	90.98		
						90.98	70.00	sqm	6,368.60
	total								
24	9.3 Steel work in tubular (round, square or rectangular hollow tubes etc.) structure in built-up sections, trusses and frame work including cutting, hoisting, fixing in position upto a height of 5m above plinth level, consisting of columns trusses, roof and bottom purlins, base plate, holding down bolts, wind ties bracing (if required), bolts, nuts and washers for fastening etc. complete with applying a priming coat of red oxide zinc chromate primer.  9.3.1 Electric resistance or induction butt welded tubes Grade-250 PWD S.O.R.-P-80/I-9.3.1								

SN	DESCRIPTION OF ITEM	NOS	MEASUREMENT				QTY	RATE	UNIT	AMOUNT
			L	B	H/D					
I	II	III	IV	V	VI		VII	VIII	IX	X
	Truss On Store Room									
	Tie Beam 50mm dia @6.19Kg/meter	5	1	6.00	6.19	-	185.70			
	Rafter 50mm dia @6.19Kg/meter	5	2	3.26	6.19	-	201.79			
	Intermediate members 50mm dia @6.19Kg/meter	5	2	3.96	6.19	-	245.12			
	Purlins 40mm dia @ 4.37Kg/meter	2	2	6.00	4.37	-	104.88			
	Gusset Plate, Fixing Bolt and Base Plate Etc						200.00			
	<b>total</b>						<b>937.49</b>	<b>88.50</b>	<b>Kg</b>	<b>82,967.87</b>
25	10.12 Supply and fixing of polymer pre-coated galvalume profile sheets (PPGL) of approved size, shape and pitch of corrugation, total coated thickness (TCT) 0.60 mm +/- 5%, epoxy primer on both side of the sheet and colour polyester top coat 18-20 microns and 6-7 microns on bottom. Sheet should have protective guard film of 25 microns minimum to avoid scratches while transportation and should be supplied in single length upto 12 metre or as desired by Engineer-in-charge. The sheet shall be fixed using self drilling /self tapping screws of size (5.5x 55mm) with EPDM seal or with polymer coated J or L hooks, bolts and nuts 8mm diameter with bitumen and G.I. limpet washers or with G.I. limpet washers filled with white lead complete upto any pitch in horizontal/ vertical or curved surfaces excluding the cost of purlins, rafters and trusses and including cutting to size and shape wherever required.									
	<b>PWD S.O.R.-P-91/I-10.12</b>									
	Roofing	2	3.26	6			39.12			
	<b>total</b>						<b>39.12</b>	<b>693.00</b>	<b>sqm</b>	<b>27,110.16</b>
26	10.16 Providing and fixing pre-coated galvanised steel sheet roofing accessories 0.50 mm +/- 5% total coated thickness (TCT), Zinc coating 120gsm as per IS: 277 in 240mpa steel grade, 5-7 microns epoxy primer on both side of the sheet and polyester top coat 15-18 microns using self drilling/ self tapping screws or with polymer coated J or L hooks, bolts and nuts and or G.I. seam bolts and nuts, G.I. plain and bitumen washers complete :									
	10.16.1 Ridges plain (500-600mm) Ridge	1	3.26				3.26			
	<b>total</b>						<b>3.26</b>	<b>552.00</b>	<b>mtr</b>	<b>1,799.52</b>
27	10.16.6 Gutter. (600 mm over all girth). Gutter	2	12				24			
	<b>total</b>						<b>24.00</b>	<b>629.00</b>	<b>mtr</b>	<b>15,096.00</b>
28	18.76 Providing and fixing on wall face or under floor UV stabilized Unplasticised Rigid PVC pipes (single socketed) having 3.2mm wall thickness conforming to IS : 13592 (4kg/sqcm) including required couplers, jointing with seal ring conforming to IS : 5382 leaving 10 mm gap for thermal expansion etc complete.									
	<b>18.76.2 110 mm dia pipe.</b> Rain water Pipe	4	3.5				14			
	<b>total</b>						<b>14.00</b>	<b>267.00</b>	<b>mtr</b>	<b>3,738.00</b>

SN	DESCRIPTION OF ITEM	NOS	MEASUREMENT			QTY	RATE	UNIT	AMOUNT
		L	B	H/D					
I	II	III	IV	V	VI	VII	VIII	IX	X
29	9.16 Providing and fixing M.S. frames of doors, windows, ventilators and cupboards joints mitred and welded with 15x3 mm lugs 10cm long embedded in cement concrete blocks 15x10x10cm of grade M-10 or with wooden plugs and screws or with dash fastener or rawl plugs and screws or with fixing clips or with bolts and nuts as required including fixing of necessary butt hinges and screws and applying a priming coat of approved steel primer.								
	9.16.3 M.S tubular frames	1	1.80		2.10	3.78			
	@30.0Kg/sqm approx					113.40			
	total					113.40	80.50	KG	9,128.70
Total									5,23,898.40
Add 12% Ground floor electrical Works (i*12/100)									62,867.81
Total									5,86,766.20



# **NAGAR PANCHAYAT, KOTBA, DIST-JASHPUR, C.G**

## **GENERAL ABSTRACT OF COST FOR REVAMPING WORK OF EXISTING SLRM CENTRE AT WARD NO-08**

SN	DESCRIPTION OF ITEM	TOTAL
<b>a</b>	<b>Machinery/Equipment's (Non Sor Items)</b>	
I	BALE TROLLEY-03 No	20,400.00
II	WEIGHBRIDGE - 1 No	2,25,000.00
III	TURBINE VENTILATOR	15,000.00
IV	SURVEILLIANCE CAMERA	17,813.00
V	FLAT CONVEYOR BELT	1,55,000.00
VI	HDPE WHEELED CONTAINER 100 LITRE-10 NO.	13,750.00
	Total a)	4,46,963.00
	Add 18% Gst	80,453.34
	Grand Total b)	5,27,416.34



*[Signature]*  
**Sub.Engineer**  
Nagar Panchayat  
Kotba

*[Signature]*  
**C.M.O**  
Nagar Panchayat  
Kotba

# NAGAR PANCHAYAT, KOTBA, DIST-JASHPUR, C.G

## GENERAL ABSTRACT OF COST FOR PROPOSED WINDROW COMPOST PLANT

Based on C. G. P.W.D S.O.R. IN FORCE FROM 1 JAN 2015

SN	DESCRIPTION OF ITEM	TOTAL
<b>a</b>		
I	WINDROW-1 No(2 TPD)	8,50,532.10
II	LEACHATE COLLECTION TANK	77,425.82
III	FENCING	1,66,966.84
<b>Total</b>		<b>10,94,924.76</b>
<b>b</b>	<b>Machinery/Equipment's (Non Sor Items)</b>	
I	WHEEL BARROW - 02 No.	11,000.00
II	SURVEILLANCE CAMERA	17,813.00
III	COMPOST SIEVE MACHINE	47,500.00
<b>Total b)</b>		<b>76,313.00</b>
<b>Add 18% Gst</b>		<b>13,736.34</b>
<b>Grand Total b)</b>		<b>90,049.34</b>
<b>Total of MRF/COMPOST-I (a+b)</b>		<b>11,84,974.10</b>



*Signature*  
Sub.Engineer  
Nagar Panchayat  
Kotba

*Signature*  
C.M.O  
Nagar Panchayat  
Kotba

NAGAR PANCHAYAT,KOTBA,DIST-JASHPUR,C.G									
DETAILED ESTIMATE FOR CONSTRUCTION OF WINDROW SHED (2 TPD CAPACITY) AND WET TIPPING SHED (21.50x6.80 m.)									
Based on C. G. P.W.D BUILDING S.O.R. IN FORCE FROM 1 JAN 2015									
SN	DESCRIPTION OF ITEM	NO	MEASUREMENT			QTY	RATE	UNIT	AMOUNT
I	II	III	L	B	H/D	VII	VIII	IX	X
			IV	V	VI				
1	1.1 Excavation for all types and sizes of foundations, trenches and drains or for any other purpose including disposal of excavated stuff upto 1.5 m lift and lead upto 50m (at least 5m away from the excavated area), including dressing and level  1.1.1 In all types of soils. F1(1500X1500) For Beam	12 1	1.50 51.80	1.50 0.40	1.70 0.20	45.90 4.14			
total						50.04	185.00	cum	9258.14
2	1.18 Providing and filling in plinth with sand/ Crusher dust and hard moorum under floor in layers not exceeding 20cm in depth consolidating each deposited layer by ramming and watering, including dressing etc complete.  Footing F1(1500X1500) For Beam	12 1	1.50 51.80	1.50 0.40	0.10 0.10	2.70 2.07			
total						4.77	371.00	cum	1770.41
3	3.1 Providing and laying nominal mix plain cement concrete with crushed stone aggregate using concrete mixer in all works upto plinth level excluding cost of form work.  3.1.3 1:3:6 (1 cement : 3 coarse sand : 6 graded stone aggregate 40mm nominal size). Footing F1(1500X1500) For Beam	12 1	1.50 51.80	1.50 0.40	0.10 0.10	2.70 2.07			
total						4.77	2970.00	cum	14172.84
4	3.2 Providing and laying nominal mix reinforced cement concrete with crushed stone aggregate using concrete mixer in all works up to plinth level excluding cost of form work  3.2.1 1:1½:3 (1 cement : 1½ coarse sand : 3 graded stone aggregate 20mm nominal size). F1(1500X1500)  Column upto G L C1(300X300)  Column above G L C1(300X300)  Plinth Beam	12  12  12  1	1.30  0.30  0.30  51.80	1.30  0.30  0.30  0.30	0.30  1.20  0.75  0.40	6.08  1.30  0.81  6.22	6.08  1.30  0.81  6.22		
total						14.41	4163.00	cum	59972.18
5	2.1 Providing and fixing form work including centring, shuttering, strutting, staging, propping bracing etc. complete and including its removal 2.1.1 Foundations, footings, bases of columns plinth beam, curtain wall in any shape and size and all type of wall below plinth level. Footings F1(1500X1500) Column upto G L C1(300X300) Column above G L	1  1	12  12	5.20  1.20	0.30  1.20	18.72  17.28			



	C1(300X300)	1	12	1.20	0.75	10.80				
	Plinth Beam	1	2	51.80	0.40	41.44				
	<b>total</b>					<b>88.24</b>	<b>139.00</b>	<b>sqm</b>	<b>12265.36</b>	
6	3.12 Providing and placing in position reinforcement for R.C.C. work including straightening, cutting, bending, binding etc. complete as per drawings including cost of binding wire in foundation and plinth all complete:									
	3.12.1 Thermo-Mechanically treated bars FE 415									
	Footing			6.08	80.00	486.72				
	Column			2.11	80.00	168.48				
	Plinth Beam			6.22	80.00	497.28				
	<b>total</b>					<b>1152.48</b>	<b>54.50</b>	<b>Kg</b>	<b>62810.16</b>	
7	1.17 Filling from available excavated stuff (Excluding rock) in trenches, plinth, sides of foundation etc. in layers not exceeding 20cm in depth consolidating each deposited layer by ramming and watering with a lead upto 50 M.									
	60% of excavated Qty.					30.03				
	<b>total</b>					<b>30.03</b>	<b>65.00</b>	<b>cum</b>	<b>1951.72</b>	
8	1.18 Providing and filling in plinth with sand/ Crusher dust and hard moorum under floor in layers not exceeding 20cm in depth consolidating each deposited layer by ramming and watering, including dressing etc complete.									
	Windrow Shed and Wet Tipping Platform	1	20.90	6.20	0.30	38.87				
	<b>total</b>					<b>38.87</b>	<b>371.00</b>	<b>cum</b>	<b>14422.25</b>	
9	12.4 52 mm thick cement concrete flooring with under layer of 40mm thick cement concrete 1:2:4 (1 cement : 2 coarse sand : 4 graded stone aggregate 20mm nominal size) and top layer of 12 mm thick cement metallic hardener concrete mix 1:2 (1 cement hardener mix : 2 stone aggregate of 6 mm size by volume) with metallic hardening compound of approved quality mixed with cement in ratio of 4:1 (4 cement : 1 metallic floor hardening compound by weight) including finishing etc. complete.									
	Windrow Shed and Wet Tipping Platform	1	20.90	6.20		129.58				
	<b>total</b>					<b>129.58</b>	<b>441.00</b>	<b>cum</b>	<b>57144.78</b>	
10	7.5 Brick work with modular fly-ash lime bricks (FaLG Bricks) confirming to IS:12894-2002 of class designation 4.0 in foundation and plinth in:									
	7.5.3 Cement Mortar 1:4 (1 cement : 4 coarse sand)									
	Wall	1	51.80	0.20	0.35	3.63				
	<b>Subtotal</b>					<b>3.63</b>				
	<b>Deductions</b>									
	Opening	2	6.20	0.20	0.35	0.87				
	<b>Subtotal</b>					<b>0.87</b>				
	<b>total</b>					<b>2.76</b>	<b>3452.00</b>	<b>cum</b>	<b>9520.62</b>	
11	11.2 Providing and making 12mm thick cement plaster of mix:									
	11.2.4 In Cement Mortar 1:6 (1 cement : 6 fine sand)									
	Internal wall	1	1	51.80	0.35	18.13				
	C1(300X300)	1	12	0.30	0.35	1.26				
	<b>Subtotal</b>					<b>19.39</b>				
	<b>Openings</b>									
	Opening	2	6.20		0.35	4.34				
	<b>Subtotal</b>					<b>4.34</b>				
	<b>total</b>					<b>15.05</b>	<b>91.50</b>	<b>sqm</b>	<b>1377.08</b>	
12	11.3 Providing and making 15mm thick cement plaster on the rough side of single or half brick wall									
	11.3.3 In Cement Mortar 1:5 (1 cement : 5 fine sand)									
	External Wall	1	1	51.80	0.35	18.13				

C1(300X300)		1	12	0.30	0.35	1.26			
<b>total</b>						<b>19.39</b>	<b>113.00</b>	<b>sqm</b>	<b>2191.07</b>
13	Providing and applying Acrylic washable Distemper or lite economy Plastic emulsion paint having VOC content less than 50gms/ lit Minimum two coats up to final finish applied @ 1.25 Kg/ 10Sqm as per relevant L.S. Code 428:2000 (product such as Tractor Uno, Dulux Duval, Berger Bison, Opus Style/lite economy emulsion product such as Asian Tactor Spark Dulux Pomise sheen, Neroloc Litol Master, Berger Bison Lite, Nippon Superio.) inclusive of providing abro tape on edges and article and cleaning of door, windows, floor and surface as required with all tools tackles and labour complete for the work.								
As per Ammendment no 08, 05/05/2025 item no.14.62									
<b>Area of Internal Plaster</b>				15.05		15.05			
<b>total</b>						<b>15.05</b>	<b>64.00</b>	<b>sqm</b>	<b>963.20</b>
14	Providing and applying on exterior surface with ECONOMY Exterior Emulsion paint of required shades to give protective and water proof finish minimum three coats applied @ 1.43 lit / 10Sqm up to final finish as per relevant I.S. Code 15489:2013 Type -2 Class D,C (Glossy /Semi Glossy finish ) (Product such as Asian Ace,Dulux Promise Exterior Berger Wall Masta ,Nerolac Suraksha Plus , Nippon Shogun Opus, One Style Power Bright) inclusive of providing abro tape on edges and article and cleaning of door, windows, floor and surface as required with all tools tackles and labour etc. complete for the work (With 2 Year Warranty)								
As per Ammendment no 08, 05/05/2025 item no.14.67									
<b>Area of External Wall</b>				19.39		19.39			
<b>total</b>						<b>19.39</b>	<b>70.00</b>	<b>sqm</b>	<b>1357.30</b>
15	9.3 Steel work in tubular (round, square or rectangular hollow tubes etc.) structure in built-up sections, trusses and frame work including cutting, hoisting, fixing in position upto a height of 5m above plinth level, consisting of columns trusses, roof and bottom purlins, base plate, holding down bolts, wind ties bracing (if required), bolts, nuts and washers for fastening etc. complete with applying a priming coat of red oxide zinc chromate primer.								
9.3.1 Electric resistance or induction butt welded tubes Grade-250									
<b>PWD S.O.R.-P-80/I-9.3.1</b>									
Pole @38.90kg/meter		1	12	4.00	38.90	-	1867.20		
Truss On Processing Shed									
Tie Beam 50mm dia @6.19Kg/meter		6	1	7.60	6.19	-	282.26		
Rafter 50mm dia @6.19Kg/meter		6	2	3.80	6.19	-	282.26		
Intermediate members 50mm dia @6.19Kg/meter		6	2	7.10	6.19	-	527.39		
Purlins 40mm dia @ 4.37Kg/meter ( On Top)		3	2	22.30	4.37	-	584.71		
							3543.82		
Gusset Plate, Fixing Bolt and Base Plate Etc		10%					354.38		
<b>total</b>						<b>3898.20</b>	<b>88.50</b>	<b>Kg</b>	<b>344990.88</b>

[illegible]



## NAGAR PANCHAYAT KOTBA, JASHPUR, C.G

## DETAILED ESTIMATE FOR CONSTRUCTION OF LEACHATE TANK AT WINDROW COMPOST PLANT

Based on C. G. P.W.D BUILDING S.O.R. IN FORCE FROM 1 JAN 2015

SN	DESCRIPTION OF ITEM	NOS	MEASURE			QTY	RATE	UNIT	AMOUNT
			L	B	H/D				
1	Excavation for all types and sizes of foundations trenches and drains or for any other purpose including disposal of excavated stuff upto 1.5 m lift and lead upto 50m (at least 5m away from the excavated area), including dressing and leveling of pits. 1.1.1) In all types of soil								
	(BUILDING SOR ITEM NO.-1.1/9)	1	5.7	2.7	2.1	32.32	185	CUM	5979.015
2	Filling from available excavated stuff (Excluding rock) in trenches, plinth, sides of foundation etc. in layers not exceeding 20cm. In depth consolidation each deposited layer by ramming and watering with a lead upto 50M. And lift upto 1.5M.								
	Excavated Area-	1	5.7	2.7	2.1	32.319			
	Deduction Tank Area-	-1	5.4	2.4	1.5	-19.44			
	P.C.C.-	-1	5.7	2.7	0.15	-2.3085			
	(BUILDING SOR ITEM NO.-1.17/11)					10.5705	65	CUM	687.0825
3	Providing and filling in plinth with sand/ Crusher dust and hard morum under floor in layers not exceeding 20cm in depth consolidating each deposited layer by ramming and watering, including dressing etc. complete.								
	(BUILDING SOR ITEM NO.- 1.18/11)	1	5.7	2.7	0.15	2.3085	371	CUM	856.4535
4	Providing and laying nominal mix cement concrete with crushed stone aggregate using concrete mixer in foundation, plinth and at ground level excluding cost of form work. 3.1.3) 1:3:6 (1 cement : 3 coarse sand : 6 graded stone aggregate 40mm nominal size).								
	(BUILDING SOR ITEM NO.- 3.1.3/23)	1	5.7	2.7	0.15	2.3085	2970	CUM	6856.245
5	Providing and laying nominal mix reinforcement cement concrete with crushed stone aggregate using concrete mixer in all works upto floor five level excluding cost of reinforcement and form work. 3.2.1) 1:1½:3 (1 cement : 1½ coarse sand : 3 graded stone aggregate 20mm nominal size).								
	Bottom Slab-	1	5.4	2.4	0.15	1.944			
	Top Slab-	1	5.4	2.4	0.15	1.944			
	Deduction-	-2	0.6	0.6	0.15	-0.108			
	(BUILDING SOR ITEM NO.- 3.2.1/23)	-1	0.6	0.6	0.15	-0.108	4163	CUM	15736.14
6	Providing and fixing formwork including centering, shuttering, strutting, staging, propping bracing etc. complete and including its removal at all levels, for: Foundations, footings, bases of columns plinth beam, curtain wall in any shape and size and all type of wall below plinth level.								
	Bottom Slab-	1	14.4	-	0.15	2.16			
	(BUILDING SOR ITEM NO.- 2.1.1/16)					2.16	139	SQ.M	300
7	2.1.7) Suspended floors, roofs, access platform, balconies (plain surfaces) and shelves (cast in situ)								
	Top Slab-	1	5.4	2.4	-	12.96			
	side	1	14.4	-	0.15	2.16			
	Deduction-	-2	0.6	0.6	-	-0.72			
	(BUILDING SOR ITEM NO.-2.1.7/16)					14.4	235	SQM	3384
8	Providing and placing in position reinforcement for R.C.C. work including straightening, cutting bending binding etc. complete as per drawings including cost of binding wire all complete: Thermo-Mechanically treated bars FE 415								
	Qty.as per item no. 5					3.78			
	(BUILDING SOR ITEM NO.-3.12.1/24)	80 kg/cum				302.4	54.5	KG	16480.8
9	Brick work with modular fly-ash lime bricks (FALG Bricks) conforming to IS:12894-2002 of class designation 40 in foundation and plinth in:								
	(SOR. ITEM NO.- 7.5.4/45)								
	Cement Mortar 1:6 (1 cement : 6 coarse sand )								
	Extra for brick work in superstructure:								
	(SOR. ITEM NO.- 7.6/45)								
	Leachate Tank Wall	1	14.4	0.2	1.5	4.32			
						4.32	3384	CUM	14618.88
10	Providing and making 6 mm thick cement plaster of mix								
	(SOR. ITEM NO.-11.1/103)								
	11.1.2) In Cement mortar 1:4 (1 cement : 4 fine sand)								

SN	DESCRIPTION OF ITEM	NOS	MEASURE			QTY	RATE	UNIT	AMOUNT
			L	B	H/D				
	Inside Plaster	1	14.4		1.5	21.6			
						21.6	87	SQM	1879.2
11	Providing M.S. foot rests including fixing in manholes with 20x20x10 cm cement concrete blocks 1:3:6 (1 cement : 3 coarse sand : 6 graded stone aggregate 20 mm nominal size) as per (BUILDING SOR ITEM NO.-20.11/191)	2	-	-	-	2	168	NOS.	336
12	Providing and fixing in position precast R.C.C. manhole cover and frame L.D- 2.5 of required shape and approved quality Rectangular shape 600x450mm internal dimensions ( BUILDING SOR ITEM NO.-20.15.1/192)	2	-	-	-	2	1031	EACH	2062
13	25mm thick cement concrete flooring with 1:2:4 cement concrete (1 cement : 2 coarse sand : 4 graded stone aggregate 12.5 mm nominal size) finished with floating coat of neat cement. (BUILDING SOR ITEM NO.-12.2/111)	1	5	2	-	10	165	SQM	1650
14	Providing and fixing on wall face or under floor UV stabilized Unplasticised Rigid PVC pipes (single socketed) having 3.2mm wall thickness conforming to IS : 13592 (4kg/sqcm)								
	Leadate Drain Pipeline	1	15	-	-	15	440	MTR	6600
	(BUILDING SOR ITEM NO.- 18.76/170)								
								Total	77425.82





	Above Ground Level Main Wall Along Road		1	55.00	0.20	0.55	6.05			
	Deduct		23	0.20	0.20	0.55	-0.50			
	<b>total</b>						<b>5.55</b>	<b>3263.00</b>	<b>cum</b>	<b>18096.05</b>
7	Providing and laying damp proof course (upto 50mm thick) with plain cement concrete 1:2:4 (1 cement : 2 coarse sand : 4 graded crushed stone aggregate 20mm nominal size) including form work. PWD S.O.R.-P-24/I-3.13									
	<b>PWD S.O.R.-P-24/I-3.13</b>									
	Main Wall Along Road		1	55.00	0.20	0.05	0.55			
	<b>total</b>						<b>0.55</b>	<b>4237.00</b>	<b>cum</b>	<b>2330.35</b>
8	12mm thick cement plaster of mix: In Cement Mortar 1:6 (1 cement : 6 fine sand) <b>PWD S.O.R.-P-103/I-11.2.4</b> Main Wall Along Road									
	<b>Subtotal</b>									
	Main Wall Along Road	2	1	55.00		0.70	77.00			
	<b>total</b>						<b>77.00</b>	<b>91.50</b>	<b>sqm</b>	<b>7045.50</b>
9	Providing and applying on exterior surface with ECONOMY Exterior Emulsion paint of required shades to give protective and water proof finish minimum three coats applied @ 1.43 lit / 10Sqm up to final finish as per relevant I.S. Code 15489:2013 Type -2 Class D,C (Glossy /Semi Glossy finish ) (Product such as Asian Ace, Dulux Promise Exterior Berger Wall Masta ,Nerolac Suraksha Plus, Nippon Shogun Opus, One Style Power Bright) inclusive of providing abro tape on edges and article and cleaning of door, windows, floor and surface as required with all tools tackles and labour etc. complete for the work (With 2 Year Warranty) <b>As per Amendment no 08, 05/05/2025 item no.14.67</b>									
	<b>total</b>						<b>77.00</b>	<b>56.00</b>	<b>sqm</b>	<b>4312.00</b>
10	Steel work in tubular structure in built-up sections, trusses and frame work including cutting, hoisting, fixing in position upto a height of 5m above plinth level, consisting of columns trusses, roof and bottom purlins, base plate, holding down bolts, wind ties bracing (if required), bolts, nuts and washers for fastening etc. complete with applying a priming coat of red oxide zinc chromate primer.									
	Electric resistance or induction butt welded tubes [S.O.R. Page no. 85 I- 9.3.1]									
	M S 40X40 x4.00 mm Th. Post @ 4.09kg/ Rmt		23	2.35		4.09	220.26			
	M S Frame 20x20x2.80 mm Th. partition pipe @ 1.56 kg/ Rmt		23	7.70		1.56	176.46			
	Bottom /Side	12	23	0.05		1.56	21.45			
	<b>total</b>						<b>418.17</b>	<b>88.50</b>	<b>Kg</b>	<b>37008.21</b>

[illegible]

# NAGAR PANCHAYAT, KOTBA, DIST-JASHPUR, C.G

## GENERAL ABSTRACT OF COST FOR PROPOSED WINDROW COMPOST PLANT

SN	DESCRIPTION OF ITEM	TOTAL
a	Machinery/Equipment's (Non Sor Items)	
I	WHEEL BARROW - 02 No.	11,000.00
II	SURVEILLANCE CAMERA	17,813.00
III	COMPOST SIEVE MACHINE	47,500.00
	Total a)	76,313.00
	Add 18% Gst	13,736.34
	Grand Total b)	90,049.34



*[Signature]*  
Sub.Engineer  
Nagar Panchayat  
Kotba

*[Signature]*  
C.M.O.  
Nagar Panchayat  
Kotba



1. ALL DIMENSIONS ARE IN UNITS OF FEET AND INCHES.  
2. IF THE DRAWING IS NOT TO BE SCALED, ONLY THE DIMENSIONS ARE TO BE FOLLOWED.  
3. ALL DIMENSIONS SHALL BE CHECKED AND CORRECTED BY RELEVANT ARCHITECTURAL & SERVICES DRAWINGS. ANY AMBIGUITY SHALL BE IMMEDIATELY BRACKETED TO THE WORK ARCHITECTS BEFORE COMMENCEMENT OF THE WORK.

DRG TITLE PROPOSED UPGRADE PLAN OF SLRM AND WINDROW COMPOST PLANT			
PROJECT TITLE			
PROPOSED REAVAMPING WORK OF SLRM CENTRE AT KOTBA BELONGS TO NAGAR PANCHAYAT KOTBA, JASHPUR, (C.G)			
	NOS	CA/0126/NF00_1/A1	
	SCALE	1:125	
	DATE	17-01-2026	
C.M.O.		PRESIDENT	
SUB ENGINEER		ARCHITECT	
ARCHITECT			
NEAR DR. SONI'S CLINIC, JUNA GADOL, SADAR ROAD AMBIKAPUR DIST. -SARGUJA C.G.-497001 PH. NO. 07774-220203 Email ID: conceptassociates2019@gmail.com			
THIS DRAWING IS THE PROPERTY OF THE ARCHITECT AND NOT TO BE COPIED.			

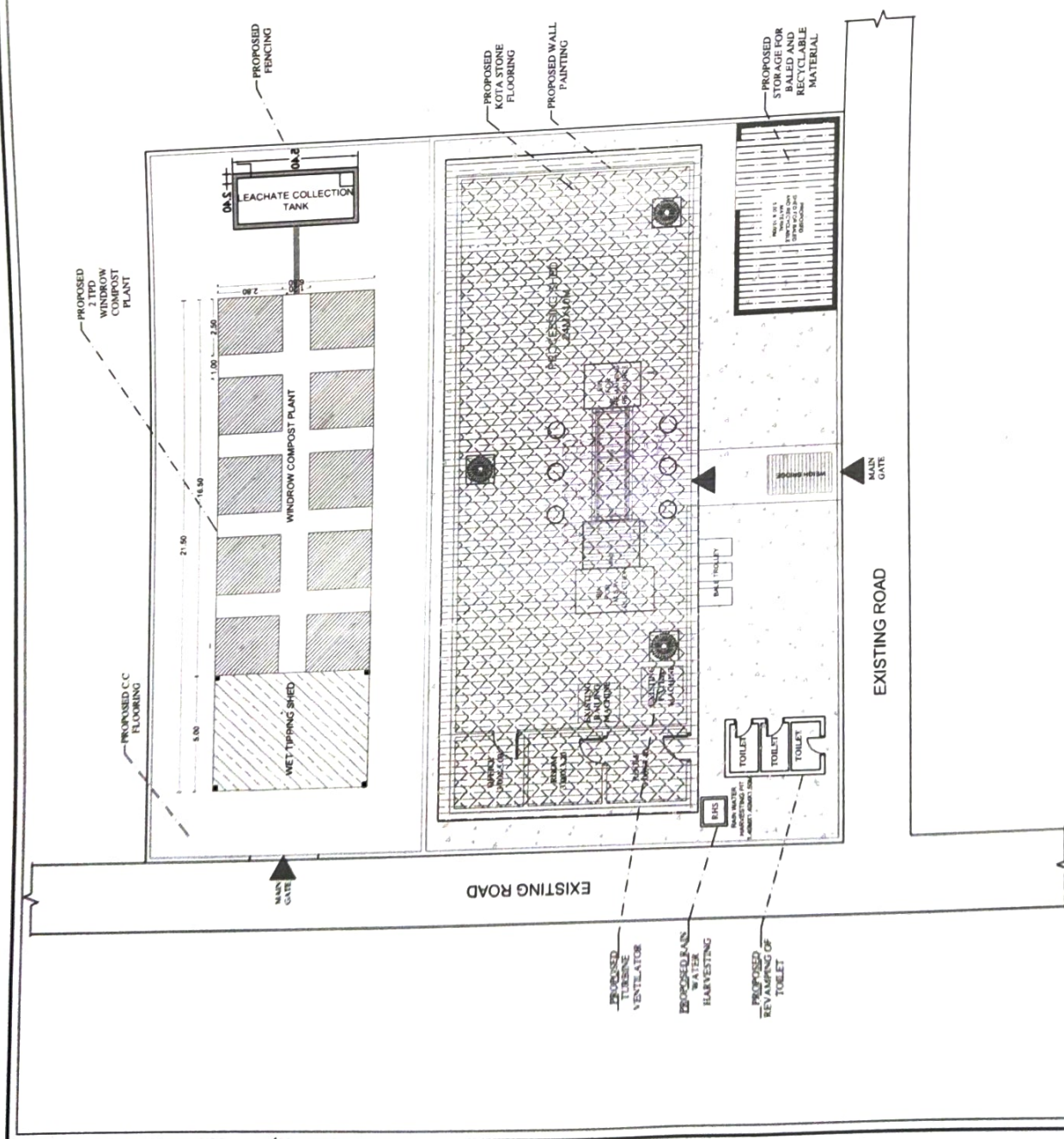

NOTE  
1. ALL DIMENSIONS ARE IN MILLIMETERS UNLESS OTHERWISE SPECIFIED.  
2. IF THE DRAWING IS NOT TO BE SCALED, ONLY FIGURES DIMENSIONS ARE TO BE CHECKED AND CORRELATED WITH THE RELEVANT ARCHITECTURAL & SERVICES DRAWINGS AND ANY AMBIGUITY SHALL BE IMMEDIATELY BROUGHT TO THE NOTICE OF THE ARCHITECTS BEFORE COMMENCEMENT OF THE WORK AT SITE.

DRG TITLE  
PROPOSED UPGRADATION PLAN

PROJECT TITLE

PROPOSED REAVAMPING WORK OF SLRM CENTRE AT KOTBA BELONGS TO NAGAR PANCHAYAT KOTBA-JASHPUR.(C.G)

NOS	CA0126/NF00_1/A2
SCALE	1:125
DATE	15-01-2026
C.M.O.	PRESIDENT



SUB ENGINEER  
*Arshad*

ARCHITECT



Concept Associates

NEAR DR. SONI'S CLINIC, JUNA GADDI, SADAR ROAD AMBIKAPUR DIST-SARGUJA C.G.-497001  
PH. NO. 07774-220203  
Email ID- conceptassociates2018@gmail.com

THIS DRAWING IS THE PROPERTY OF THE ARCHITECT AND NOT TO BE COPIED OR REPRODUCED WITHOUT PERMISSION

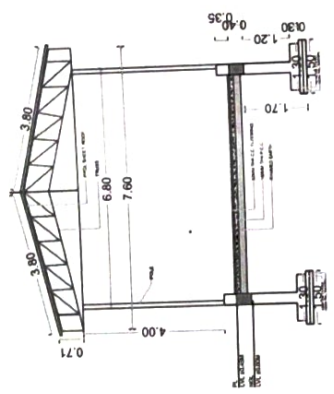

SECTION A-A

FOOTING DETAILS			
FOOTING NO.	FOOTING DETAILS		
	L	B	D
F1	1500	1500	300

REINFORCEMENT DETAILS			
BAR	REINFORCEMENT DETAILS		
	I TO L	L TO B	B TO D
1	10R 150CC	10R 150CC	10R 150CC



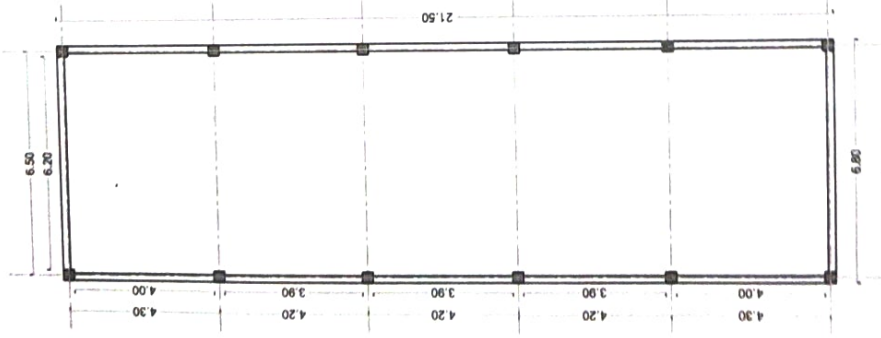

COLUMN DETAILS		
COL. TYPE	COLUMN SECTION	
	UPTO PLINTH	ABOVE PLINTH
C1 300X300	MAIN BARS • 8R10 125MM • 8R10 125MM • 8R10 125MM • 8R10 125MM	MAIN BARS • 8R10 125MM • 8R10 125MM • 8R10 125MM • 8R10 125MM

GROUND BEAM DETAIL			
DESCRIPTION	GROUND BEAM DETAIL		
	1	2	3
B1(300X400)	10R 150CC	10R 150CC	10R 150CC

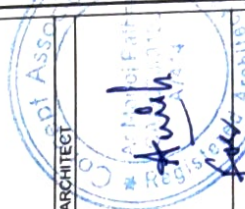

PLAN

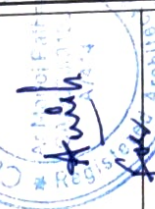

SECTION OF RAINWATER HARVESTING SYSTEM					
PROJECT TITLE					
PROPOSED REAVAMPING WORK OF SLRM CENTRE AT KOTBA BELONGS TO NAGAR PANCHAYAT KOTBA,JASHPUR,(C.G)					
NOS	CA\0126\NF00_1\A3				
SCALE	1:600				
DATE	05.01.2026				
C/M O	PRESIDENT				
SUB ENGINEER	ARCHITECT				
					
					
ARCHITECT					
 <b>Concept Associates</b> a r c h i t e c t s NEAR DR. SONI'S CLINIC, JUNA GADOLI, SADAR ROAD AMBIKAPUR DIST.-SARGUJA C.G.-497001 PH. NO. 07774-220203 Email ID- concept619110@gmail.com					
THIS DRAWING IS THE PROPERTY OF THE ARCHITECT AND NOT TO BE COPIED OR REPRODUCED WITHOUT PERMISSION					



NOTE  
1. ALL DIMENSIONS ARE IN METERS UNLESS OTHERWISE SPECIFIED  
2. THE DRAWING IS NOT TO BE SCALED, ONLY FIGURES  
3. ALL DIMENSIONS SHALL BE CHECKED AND CORRELATED WITH THE  
RELEVANT ARCHITECTURAL & STRUCTURAL DRAWINGS  
4. THE DRAWING IS THE PROPERTY OF THE ARCHITECT & SHALL NOT BE  
AMBIGUOUSLY BROUGHT TO THE NOTICE OF THE ARCHITECTS BEFORE COMMENCEMENT OF THE WORK AT SITE.

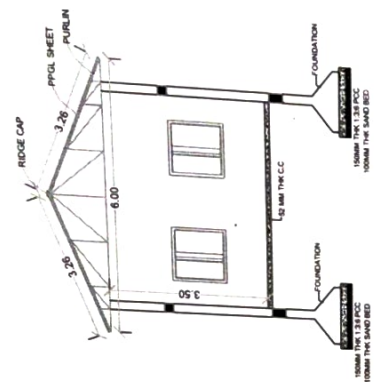

SECTION AT Y-Y

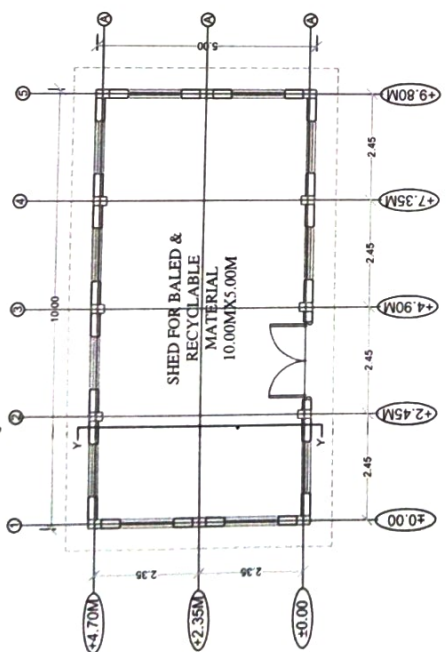

PLAN

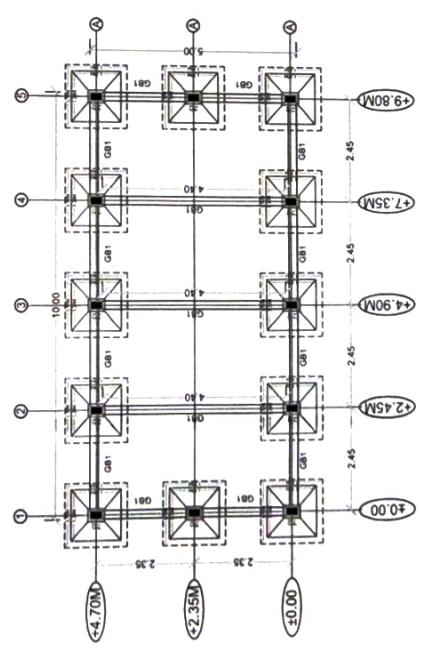

LAYOUT & GROUND BEAM

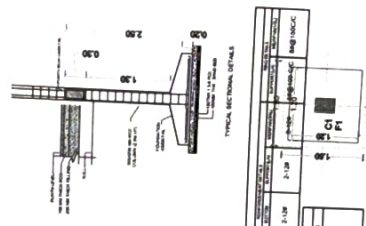

COLUMN FOOTING DETAILS

COLUMN DETAILS		FOOTING DETAILS	
COL TYPE	COL SIZE	FOOTING TYPE	FOOTING SIZE
C1	300 x 300	F1	1000 x 1000
C2	300 x 300	F2	1000 x 1000
C3	300 x 300	F3	1000 x 1000
C4	300 x 300	F4	1000 x 1000
C5	300 x 300	F5	1000 x 1000
C6	300 x 300	F6	1000 x 1000
C7	300 x 300	F7	1000 x 1000
C8	300 x 300	F8	1000 x 1000
C9	300 x 300	F9	1000 x 1000
C10	300 x 300	F10	1000 x 1000

DRG TITLE  
PROPOSED PLAN OF SHED FOR BALED & RECYCLABLE MATERIAL

PROJECT TITLE  
PROPOSED REAVAMPING WORK OF SLRM CENTRE AT KOTBA BELONGS TO NAGAR PANCHAYAT KOTBA, JASHPUR, (C.G)

NOS  
SCALE  
DATE  
C.M.O  
PRESIDENT

SUB ENGINEER  
ARCHITECT

ARCHITECT  
Concept Associates

NEAR DR. SON'S CLINIC, JUNA GARDEN, ROAD AMBAPUR DIST. - 824001  
Email ID: - 0819100@gmail.com

THIS DRAWING IS THE PROPERTY OF THE ARCHITECT & SHALL NOT BE COPIED OR REPRODUCED WITHOUT PERMISSION

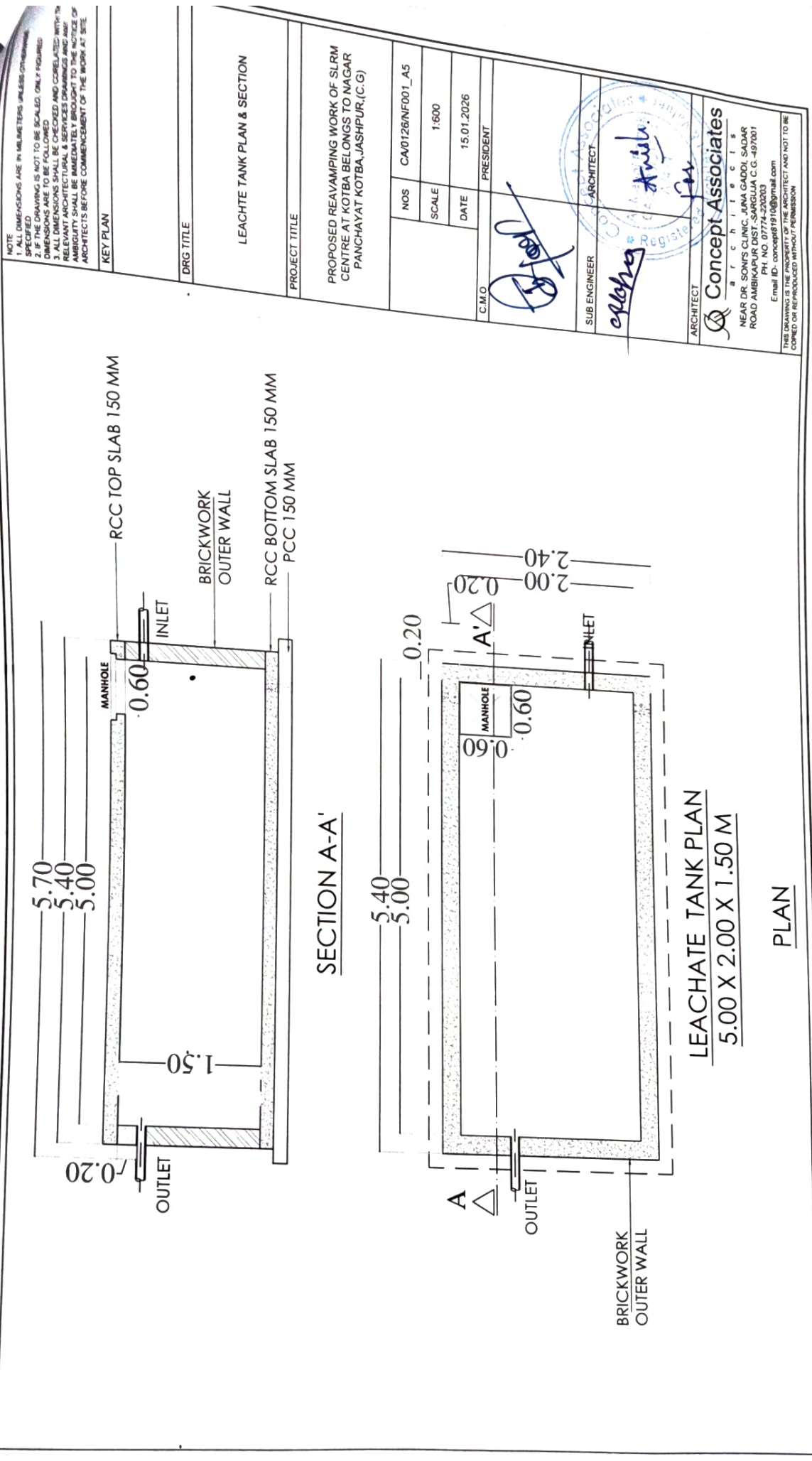

2. IF THE DRAWING IS NOT TO BE SCALED, ONLY DIMENSIONS SPECIFIED TO BE FOLLOWED

### KEY PLAN

DRG TITLE

## PLAN & SECTION DETAILS OF FENCING

# PROJECT TITLE

PROPOSED REAVAMPING WORK OF SLRM  
CENTRE AT KOTBA BELONGS TO NAGAR  
PANCHAYAT KOTBA, JASHPUR, (C.G)

NOS	CA/0126/NF00 1/A65
-----	--------------------

SCALE 1:600

DATE	15-01-2026
------	------------

C.M.O		PRESIDENT
-------	---	-----------

SUB ENGINEER	ARCHITECT
--------------	-----------

200

ARCHITECT

~~Concept Associates~~

## Archives

NEAR DR. SONI'S CLINIC, JUNA GADDI, SADAR  
ROAD AMBIKAPUR DIST. SARGUJA C.G. - 497001

PH. NO. 07774-220203

THIS DRAWING IS THE PROPERTY OF THE ARCHITECT AND NOT TO BE  
COPIED OR REPRODUCED WITHOUT PERMISSION

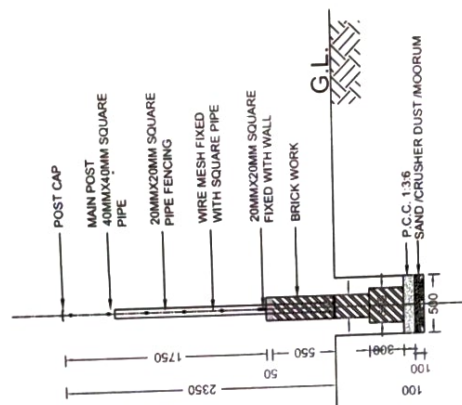

## CROSS SECTION OF FENCING

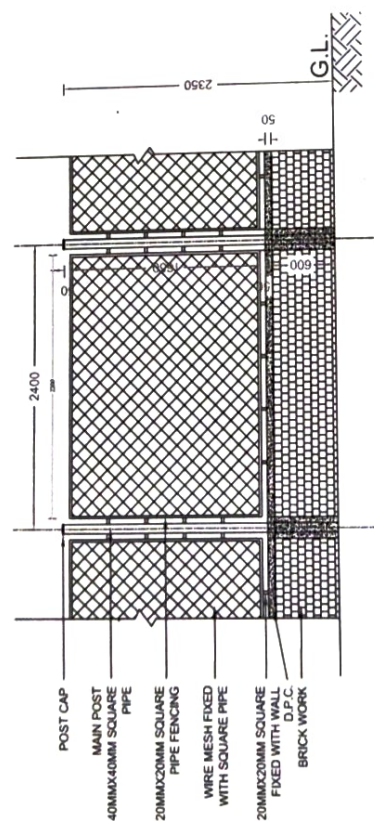

TYPICAL ELEVATION OF FENCING

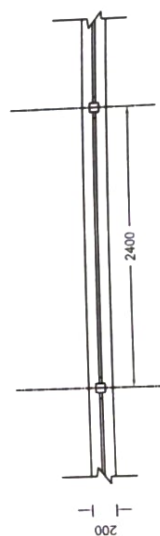

TYPICAL PLAN OF FENCING

