



ಕರ್ನಾಟಕ ಸರ್ಕಾರ

ಪಂಚಾಯತ್ ರಾಜ್ ಇಂಜಿನಿಯರಿಂಗ್ ಉಪ ವಿಭಾಗ
ಮಡಿಕೇರಿ ತಾಲ್ಲೂಕು.

ಅಂದಾಜು ಪಟ್ಟಿ

2025-26

ಕೆಲಸದ ಹೆಸರು:- Providing Necessary Protection Work with Drainage Facilities
at Galibeedu

ಲೆಕ್ಕ ಶೀರ್ಷಿಕೆ:- 2025-26 / SDMF

ಅಂದಾಜು ಮೊತ್ತ:- RS-64,75,000.00

(1)

ಸಹಾಯಕ ಕಾರ್ಯಪಾಲಕ ಇಂಜಿನಿಯರ್ ರವರ ಕಛೇರಿ
ಪಂಚಾಯತ್ ರಾಜ್ ಇಂಜಿನಿಯರಿಂಗ್ ಉಪ ವಿಭಾಗ
ಮಡಿಕೇರಿ ತಾಲ್ಲೂಕು

ಅಂದಾಜು ಪಟ್ಟಿ ವರದಿ

ಕಾಮಗಾರಿಯ ಹೆಸರು:-

Providing Necessary Protection Work with Drainage Facilities at Galibeedu

ಲೆಕ್ಕ ಶೀರ್ಷಿಕೆ:-

2025-26 / SDMF

ಅಂದಾಜು ಮೊತ್ತ:- ರೂ 64.75,000/-

ಅಂದಾಜು ಪಟ್ಟಿಯ ವರದಿ:-

ಕಾಮಗಾರಿಯ ಹೆಸರು:- Providing Necessary Protection Work with Drainage Facilities at

Galibeedu ಲೆಕ್ಕ ಶೀರ್ಷಿಕೆ: 2025-26 / SDMF ಯೋಜನೆಯಡಿ ಅಂದಾಜು ಮೊತ್ತ 64.75 ಲಕ್ಷಕ್ಕೆ ಅನುಮೋದನೆಗೊಂಡಿರುತ್ತದೆ. ಅದರಂತೆ ಸ್ಥಳ ಪರಿಶೀಲನೆ ಮಾಡಿ, ಕೆಳಕಂಡ ಆಗತ್ಯ ಅನುವುಗಳೊಂದಿಗೆ ಅಂದಾಜುಪಟ್ಟಿಯನ್ನು ತಯಾರಿಸಿದೆ.

- 1 Earth work excavation for Foundation by mechanical means
- 2 Providing and laying in position Cement Concrete for all Foundation works
- 3 Providing and laying in position Cement Concrete for all Super structures
- 4 Supplying, fitting and placing TMT FE 550 / 550D Steel Reinforcement
- 5 Providing weep holes
- 6 Providing and laying of Filter media
- 7 Back filling behind abutment,
- 8 Providing and laying Pitching on slopes

ಸದರಿ ಕಾಮಗಾರಿಯ ಅಂದಾಜು ಪಟ್ಟಿಯನ್ನು 2023-24 ನೇ ಸಾಲಿನ ಲೋಕೋಪಯೋಗಿ ಇಲಾಖೆ, ಏಕರೂಪ ದರಪಟ್ಟಿ ಅನ್ವಯ ಹಾಗೂ ಈ ಪ್ರದೇಶವು ಮಳೆನಾಡು ಪ್ರದೇಶದ ವ್ಯಾಪ್ತಿಯಲ್ಲಿ ಒಳಪಡುವುದರಿಂದ ಶೇ.12 ರಷ್ಟು ಹೆಚ್ಚಿನ ಪ್ರದೇಶ ಭತ್ಯೆಯನ್ನು ಮತ್ತು 18% ಜಿ ಎಸ್ ಟಿ ಅಳವಡಿಸಿ ತಯಾರಿಸಲಾಗಿದೆ.

ಕಿರಿಯ / ಸಹಾಯಕ ಇಂಜಿನಿಯರ್,
ಪಂ.ರಾ.ಇಂ.ಉ.ವಿ. ಮಡಿಕೇರಿ.

ಸಹಾಯಕ ಕಾರ್ಯಪಾಲಕ ಇಂಜಿನಿಯರ್,
ಪಂ.ರಾ.ಇಂ.ಉ.ವಿ. ಮಡಿಕೇರಿ.

ಕಾಮಗಾರಿಯ ಪೆಸರು:-

Providing Necessary Protection Work with Drainage
Facilities at Galibeedu

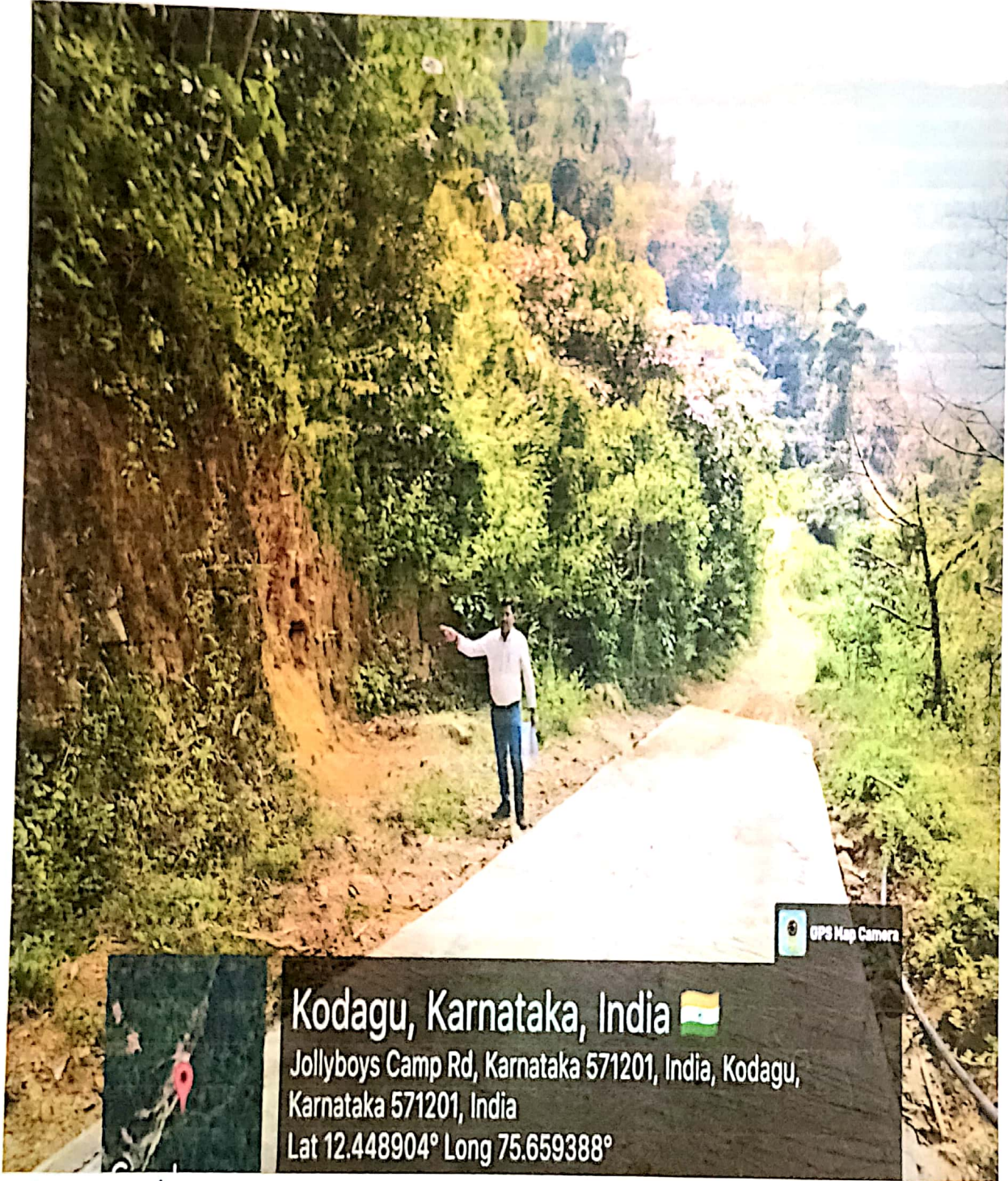

ಕಿರಿಯ / ಸಹಾಯಕ ಇಂಜಿನಿಯರ್,
ಪಂ.ರಾ.ಇಂ.ಉ.ವಿ. ಮಡಿಕೇರಿ.

ಸಹಾಯಕ ಕಾರ್ಯಪಾಲಕ ಇಂಜಿನಿಯರ್,
ಪಂ.ರಾ.ಇಂ.ಉ.ವಿ. ಮಡಿಕೇರಿ.

Name of work:-

Providing Necessary Protection Work with Drainage Facilities at Galibeedu

Est Cost:- 6475000.00

No	Description of work	No	L	B	D	Qty	Unit	Amount
----	---------------------	----	---	---	---	-----	------	--------

1 Earth work excavation for Foundation by mechanical means for all works & depth up to 3 m, as per drawing and technical specifications, including setting out, shoring, strutting, barricading, caution lights, including dressing of excavated surfaces, disposing off or leveling the excavated earth or sorting & stacking the selected earth for reuse in a radius of 50 m and lift up to 1.5 m including cost of labor, tools, usage of machinery & other appurtenances required to complete the work. In all kinds of soils. Depth 3 m to 6 m (V01-1 sr it no 1.14.2)

BR	117 00	Cutting	1	41.80	1.50	2.50	156 750 m3	
2%	14 04	For Rt Wall	1	41.80	3.00	3.00	376 200	
TR	131 04						532 9500	
							373 0650	
							70% Soft Soil	
							RS	131 04 /m3

48886 00

2 Earth work excavation for Foundation by mechanical means for all works & depth up to 3 m, as per drawing and technical specifications, including setting out, shoring, strutting, barricading, caution lights, including dressing of excavated surfaces, disposing off or leveling the excavated earth or sorting & stacking the selected earth for reuse in a radius of 50 m and lift up to 1.5 m including cost of labor, tools, usage of machinery & other appurtenances required to complete the work. In ordinary/soft rock without blasting depth exceeding 3m, but not exceeding 4.5m (V01-1 sr it no 1.15.3)

BR	463 00	30% Rock Soil					159 8850 m3	
2%	55 56						159 8850	
TR	518 56						RS	518 56 /m3

82910 00

3 Providing and laying in position Cement Concrete for all Foundation works. The granite/trap/basalt crushed graded coarse aggregates and fine aggregates as per relevant IS Codes machine mixed with super plasticizers laid in finished layers, well compacted using needle vibrators, including all lead & lifts, cost of all materials, quality conforming to the requirements of relevant IS codes, labour, Usage charges of machinery, curing and all the other appurtenances required to complete the work as per technical specifications. M25 Design Mix Using 20 mm nominal size graded crushed coarse aggregates (P.no 15 I no. 2.2.3)

BR	6227 00	PCC	1	41.80	3.00	0.20	25 08	
V)3%	186 81						25 08 M3	
TR	6413 81						RS	7183 47 /m3
V)12%	769 66							
TR	7183 47							

180161.00

4 Providing and laying in position Cement Concrete for all Super structures of building, Road works, Water works, Irrigation works & super structure works of bridges upto 3.50 m height. The granite/trap/basalt crushed graded coarse aggregates and fine aggregates as per relevant IS Codes machine mixed with super plasticisers laid in layers, well compacted using needle vibrators. The cost includes all lead & lifts, cost of all materials, quality conforming to the requirements of relevant IS codes, labour, Usage charges of machinery, curing and all other appurtenances required to complete the work as per technical specifications. M25 Design Mix Using 20 mm nominal size graded crushed coarse aggregates (P.no. 15 I no. 2.5.2)

BR	6734 00	Raft	1	41.80	3.00	0.60	75.24	
W)3%	202 02						75.24 M3	
TR	6936 02						RS	7768.34 /m3
V)12%	832 32							
TR	7768 34							

584490 00

BR	6734 00							
V)10%	673 40	Rt Wall	1	41.80	0.525	7.20	158.0040	
TR	7407 40						158.0040 M3	
V)12%	888 89						RS	8296.29 /m3
TR	8296 29							

1310847.00

BR	6734 00							
V)35%	2356 90	Drain Bed	1	41.80	0.60	0.15	3 7620	
TR	9090 90	Drain Wall	1	41.80	0.15	0.60	3 7620	
V)12%	1090 91						7 5240 M3	
TR	10181 81						RS	10181.81 /m3

76608 00



5 Supplying, fitting and placing TMT FE 550 / 550D Steel Reinforcement including cost of all materials, machinery, labour, cleaning, straightening, cutting, bending, hooking, lapping/welding joints, tying with binding wire / soft annealed steel wire and other ancillary operations complete as per drawing and technical specification (P no 181 No 2 11e)

BR	79710.00	Qty	kg/m3
12%	9565.2	Raft 75.24	80.00
TR	89275.20	Rt Wall 165.53	100.00
			22572.00000 Kg
			22.57200000 tn
		Rs.	89275.20 /tn
			2015120.00

6 Providing weep holes in Brick masonry/Plain/ Reinforced concrete abutment, wing wall/ return wall with PVC Pipe 110mm outer dia at 2 kg per m2, extending through the full width of the structure with slope of 1V 20H towards drawing face. Complete as per drawing and Technical Specifications(V0I-3 sr it no 12.2)

BR	239.00	250	0.75	187.50 m
12%	28.68			187.50
TR	267.68			RS 267.68 /m
				50190.00

7 Providing and laying of Filter media with granular material/stone crushed aggregates satisfying the requirements laid down in clause 2504.2.2 of MoRTH specifications to a thickness of not less than 600 mm with smaller size towards the soil and bigger size towards the wall and provided over the entire surface behind abutment, wing wall and return wall to the full height compacted to a firm condition complete as per drawing and Technical Specification (V0I-3 sr it no 12.4)

BR	2677.00	1	41.80	0.75	5.00	156.750 m3
12%	321.24					156.750
TR	2998.24				RS	2998.24 /m3
						469974.00

8 Back filling behind abutment, wing wall and return wall complete including compaction as per drawing and Technical Specification granular material(V0I-3 sr it no.12.3A)

BR	1168.00	1	41.80	2.00	5.00	418.000 m3
12%	140.16					418.000
TR	1308.16				RS	1308.16 /m3
						546811.00

9 Providing and laying Pitching on slopes laid over prepared filter media including boulder apron laid dry in front of toe of embankment complete as per drawing and Technical specifications A Stone/Boulder(2021-22SR PAGE:NO:-111 ITEM NO.16.4)

BR	1635.00	Side	1	41.80	0.45	2.00	37.620 m3
12%	196.20						37.620 m3
TR	1831.20				Rs.	1831.20 /m3	68890.00
							Sub-Total Amount Rs =
							5434887.00

10 GST of 18% as per Govt.Letter No.447-12/2022,dated 30.07.2022

978280.00

11 Thirdparty Charges 0.05%

32375.00

12 Miscellaneous And Rounding OffL/S.....

29458.00

Total Amount Rs = 6475000.00

Assistant/Junior Engineer
PRE Sub Division Madikeri

Assistant Executive Engineer
PRE Sub Division Madikeri

ತಾಂತ್ರಿಕ ಪರಿಶೀಲನೆ

ದಾ. 6475000/-

ಮೊತ್ತದ
25.26 ಸಿ. 5Dms
ಅಕ್ಕಿ ಕೀಟಾಕೆಯ ಪ್ರಸಕ್ತ ಸಾಲಿನ ದೂ
ಪ್ರಸ್ತುತವಿರುವ ತಾಂತ್ರಿಕವಾಗಿ ಪರಿಶೀಲಿಸಲಾಗಿದೆ.

ಪ್ರಾ.ಪಂ.ಯವರು
ಪ್ರಾ.ಪಂ.ಯವರು

Providing Necessary Protection Work with Drainage Facilities at
Galibeedu

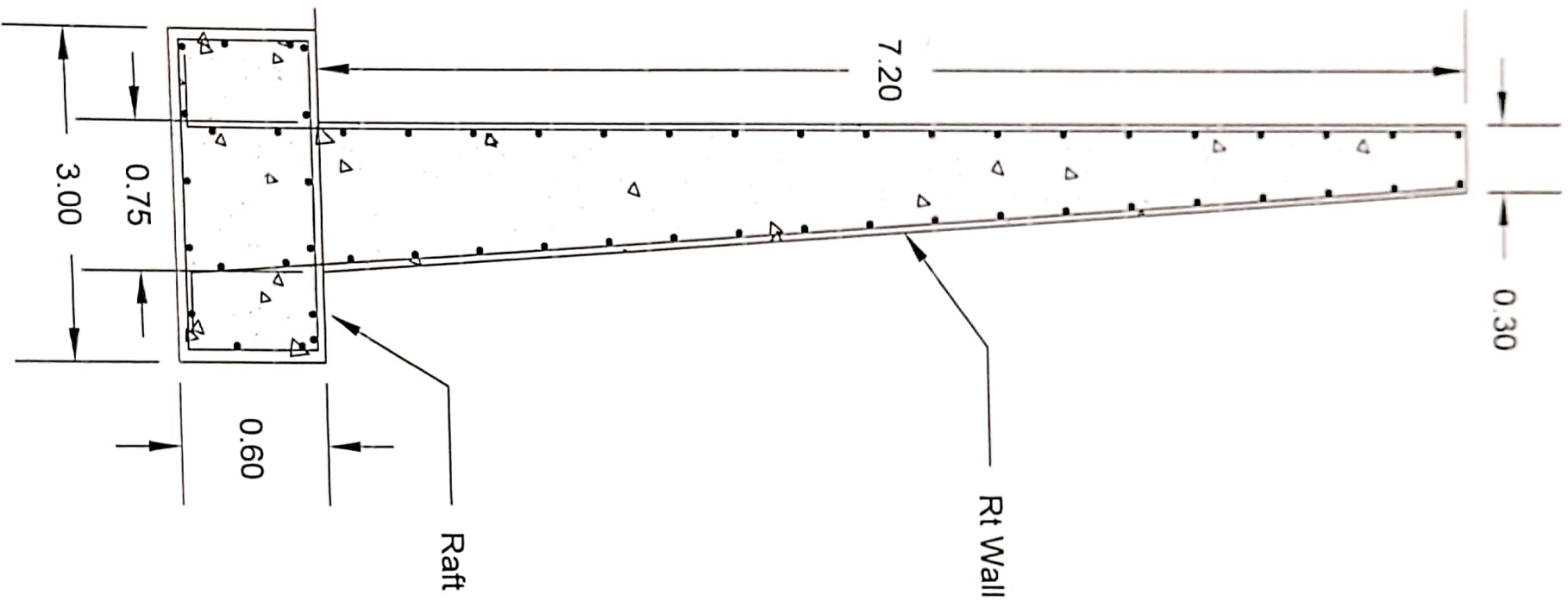

Assistant Junior Engineer
PRESID Madikeri

Assistant Executive Engineer
PRESID Madikeri