

SPECIAL CONDITIONS TO ENSURE PERSONNEL SAFETY and
SAFETY PRECAUTIONS TO BE OBSERVED AT SITE

1. The contractor/ agency must ensure availability of personal safety gears such as safety shoes, retro reflective jackets, helmets etc with Personnel deployed by them on work site. No staff without proper safety gears be allowed on worksite.
2. Adequate manpower along with proper tools and equipments must be deployed to ensure desired progress with quality work as well as safe working.
3. The contractor staff must not be allowed to use the Dip Lorries & Rail dollies without proper authorised railway person along with suitable traffic block & safety protection as per situation and circumstances. At any time, no contractor staff should be allowed to put even empty rail dollies on track without proper protection & Railway Supervisor.
4. The staff deployed by the contractor must be trained for personal safety and train safety at worksite before deployment. SSE/P.Way & ADEN must examine their knowledge & impart them at least one day training at their HQ & issue competency certificate & Identity cards with validity of one year or date of completion of that work whichever is earlier. ADEN/ SSE/P.Way shall also take contractors personnel assurance on Assurance register that they have sufficient knowledge for working on Railway track.
5. Regarding safe working on worksite, para no 819 of IRPWM, which is enclosed must be followed in true letter & spirit and taught to contractor staff.
6. During working on running track, infringement by any material & machinery must not be allowed without traffic block/ suitable speed restrictions and proper protection of track, and that too in presence of competent Railway supervisor.
7. In case of any violation of above safety rules by any of contractual authorised staff, minimum penalty of Rs.1.00 lakh shall be imposed. Actual amount of penalty will depend upon nature and magnitude of violation and shall be finally decided by ADEN of section.
8. If any contractor's labour/ workmen starts work at site without the knowledge of Railway official or without instructions of Railway official in writing, then suitable

penalty on contractor upto Rs 1.0 Lakh (to be decided by Aden incharge of section) will be imposed on contractor and concerned SSE/ JE will liable to be taken up under D & AR.

9. In case of any unauthorised contractor staff found on work site without proper competency and valid Identity card issued by Railway Representatives (ADEN/ SSE)., minimum penalty of Rs. 1.00 lakh will be imposed on Contractor.
10. The Contractor will be liable to provide all facilities to workmen due to them as per relevant Labour laws, Acts & Codes such as Toilet, Drinking water, Leaves, ESIC, EPF, minimum wages etc. The contractor will update all data of manpower deployed and wages paid to them on IR Sharmik Kalyan Portal.
11. The Contractor will also ensure facilities for female employees such as separate toilet, changing room etc.

Sr. DIVISIONAL ENGINEER

IRPWM para no. 819: Safe Working of Contractors – A large number of men and machinery are deployed by the contractors for track renewals, gauge conversions, doublings, bridge rebuilding etc. It is therefore essential that adequate safety measures are taken for safety of the trains as well as the work force. The following measures should invariably be adopted:

1. The contractor shall not start any work without the presence of railway supervisor or his representative and contractor's supervisor at site.
2. Wherever the road vehicles and/or machinery are required to work in the close vicinity of railway line, the work shall be so carried out that there is no infringement to the Railway's Schedule of Dimensions. For this purpose, the area where road vehicles and/or machinery are required to ply, shall be demarcated and acknowledged by the contractor. Special care shall be taken for turning/reversal of road vehicles/machinery without infringing the running track. Barricading shall be provided wherever justified and feasible as per site conditions.
3. The look out and whistle caution orders shall be issued to the trains and speed restrictions imposed where considered necessary. Suitable flagmen/detonators shall be provided where necessary for protection of trains.
4. The supervisor/workmen should be counselled about safety measures. A competency certificate to the contractor's supervisor as per proforma annexed shall be issued by ADEN which will be valid only for the work for which it has been issued. **(Annexure)**.
5. The ballast/rails/sleepers/other P.Way Materials after unloading along track should be kept clear off moving dimensions and stacked as per the specified heights and distance from the running track.
6. Supplementary site-specific instructions, wherever considered necessary, shall be issued by the Engineer in-charge.
7. The Engineer in-charge shall approve the methodology proposed to be adopted by the contractor, with a view to ensure safety of trains, passengers and workers and he shall also ensure that the methods and arrangements are actually available at site before start of the work and the contractor's supervisors and the workers have clearly understood the safety aspects and requirements to be adopted/ followed while executing the work.
8. There shall be an Assurance register kept at each site, which will have to be signed by both, i.e. Railway Supervisor or his representative as well as the contractor's supervisor as a token of their having understood the safety precautions to be observed at site.

COMPETENCY CERTIFICATE

Certified that Shri..... P.Way supervisor of M/s has been examined regarding P.Way working on work. His knowledge has been found satisfactory and he is capable of supervising the work safely.

Assistant Divisional Engineer

**WORKS OF SHORT DURATION-PROTECTION
OF LINE IN CASE OF STOP DEAD RESTRICTION**

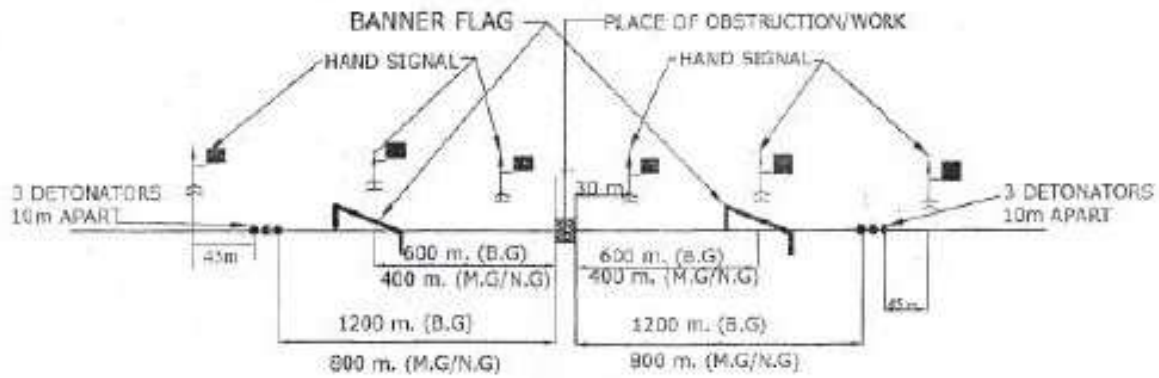

SINGLE LINE

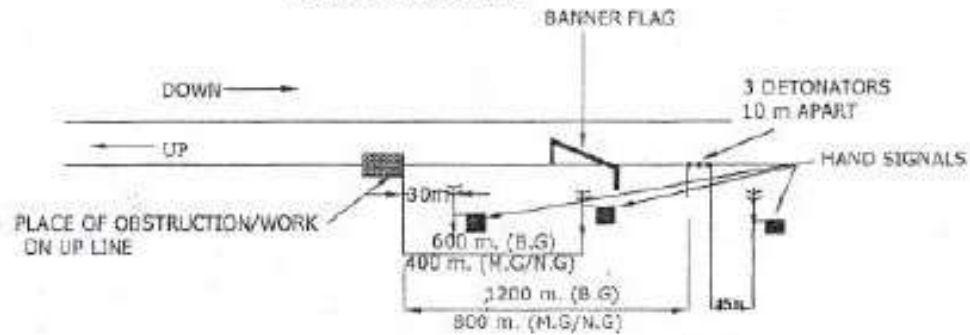

DOUBLE LINE

Note: - IN CASE OF M. G SECTIONS, WHERE THE TRAINS RUN AT A SPEED MORE THAN 75 Km/h, THE DISTANCES OF HAND-SIGNALS AND DETONATORS SHALL BE INCREASED SUITABLY AS PER APPROVED SPECIAL INSTRUCTIONS