

ELEVATION

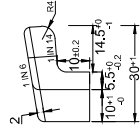

SIDE ELEVATION

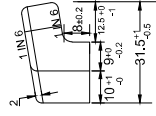

SIDE ELEVATION

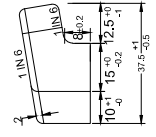

SIDE ELEVATION

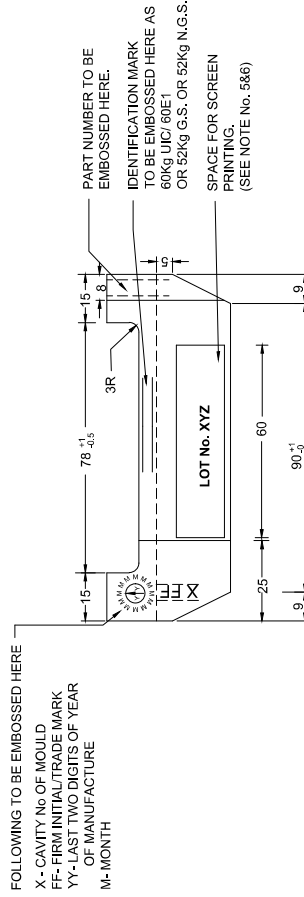

PLAN

TABLE

S.No.	RAIL SECTION	IDENTIFICATION MARK	FOR END CUT LINER AT FISH PLATED JOINT	COLOUR CODE FOR HWY LINER	SCHEME FOR SCREEN PRINTING FOR GFN LINER
			DRG. NO.	COLOUR BAND RAL COLOUR CODE	PRINT OF COLOUR BAND
1.	60Kg ₂ (UIC) 60E1	60 Kg.	RDSOIT-10225	BROWN RED 3011	RED LOT No. XYZ, 60kg, RAIL ON 52kg/ 60kg, WIDER SLEEPER
2.	52 Kg.	52 Kg. (G.S.)	RDSOIT-10226	MINT GREEN 6029	YELLOW LOT No. XYZ, 52kg, RAIL ON 52kg/ 60kg, WIDER SLEEPER(GS)
3.	52 Kg.	52 Kg.(N.G.S.)	RDSOIT-10227	COBALT BLUE 5013	LIGHT GREEN LOT No. XYZ 52kg, RAIL ON 52kg/ 60kg, WIDER SLEEPERINGS

7. DIMENSIONAL INSPECTION OF LINERS SHOULD BE DONE WITH THE INSPECTION GAUGE AS PER DRAWING NO. R027/10/23.
6. LINER AND COLOUR OF FINISHED LINER SHALL BE AS PER TABLE TITLED "COLOUR CODE FOR LINER" AND LINER SHALL BE SCREEN PRINTED IN WHITE COLOUR/ LASER PRINTED WITH CHARACTERS SIZE NOT LESS THAN 3MM.
5. THE GFN SIZE SHALL BE SCREEN PRINTED WITH COLOUR BANDS IN DIFFERENT COLOURS AS PER TABLE TITLE "SCHEME FOR SCREEN PRINTING FOR GFN LINER" WITH CHARACTERS SIZE 3MM APPEARING IN NATURAL COLOUR OF THE LINER. THE LOCATION OF COLOUR BAND IS SHOWN IN THE PLAN.
4. (a) G.S. STANDS FOR GAUGE SIDE OF 52KG RAIL.
(b) N.G.S STANDS FOR NON GAUGE SIDE OF 52KG RAIL.
3. ALL SHARP EDGES TO BE ROUNDED OFF TO ABOUT 2R, EXCEPT WHERE OTHERWISE MENTIONED.
2. TOLERANCES ON DIMENSIONS WHERE NOT MENTIONED, SHALL BE $\pm 0.2\text{mm}$
1. ALL DIMENSIONS ARE IN MM.

NOTE

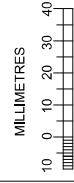

SPECIFICATION	SCALE	ALT:	REVISIONS & REDRAWN
IRS-T-44		01	

ASHUTOS
H KUMAR

Digitally signed by
ASHUTOSH KUMAR
Date: 2025.08.26
16:36:50 +05'30'

THIS DRAWING IS THE PROPERTY OF
RESEARCH DESIGNS AND STANDARDS ORGANISATION
(MINISTRY OF RAILWAYS)
LUCKNOW -226011, INDIA

AND SHALL NOT BE USED, COPIED, REPRODUCED IN PART OR WHOLE WITHOUT PRIOR CONSENT IN WRITING

R.D.S.O.

GFN-66/ HVN-66 INSULATING CUT
LINER AT FISH PLATED JOINT FOR
USE WITH WIDER PSC SLEEPER
(RT-8746) SUITABLE FOR
60Kg./UIC/ 60E1 & 52 Kg RAILS.

STAND-----	ADVANCE 01-07-2025 (T)
CANCLD-----	
BEV-----	

RDSO/T- 10225 TO RDSO/T-10227