

## Annexure-A

### POLYSTER FIBRE FILLED PILLOW

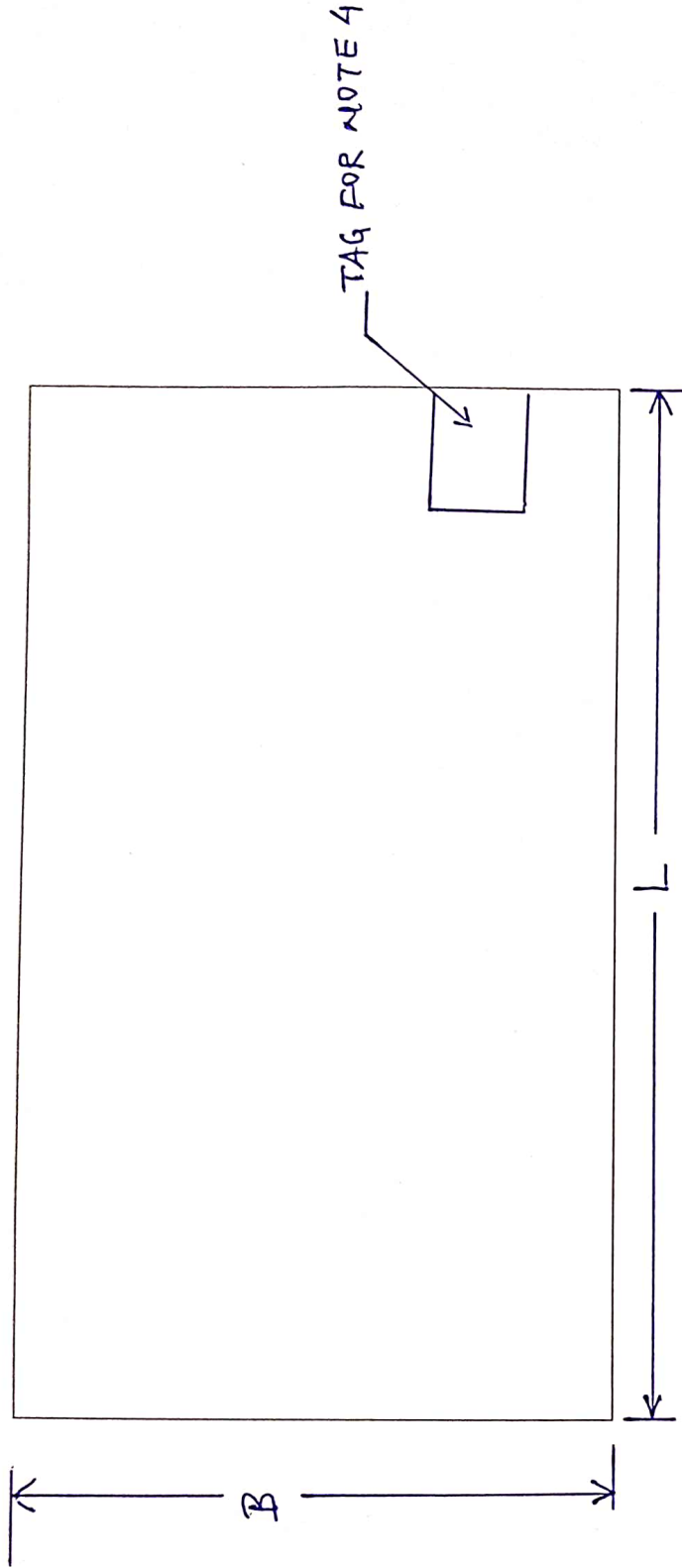

#### Note:

1. Specification: IS:18930/2024 or latest.
2. Colour of Pillow casing/inner primary cover- Grey (Pantone shade:16-3915 TPG)
3. Piping- A cord sewn on all four sides of the casing pillow should be provided to help the pillow to maintain it's desired Shape.
4. Woven tag marked with manufacturer's name, initial or trademark, Size (LxB), type of fibre fill, mass of fibre fill, type of casing fabric(blend composition), month & year of manufacture, SECR mark should be stitched along with the seam at one corner edge.
5. All dimensions are in mm.
6. Sketch is not to scale.
7. Size of Pillow and fibre fill mass: for 2A/3A: LxB=500 x 360, 350 gram.
8. Tolerance in size: L=+20 , B=+10  
and in Mass: - 2%  
+ 5%

Annexure-B

PILLOW OUTER PROTECTIVE COVER

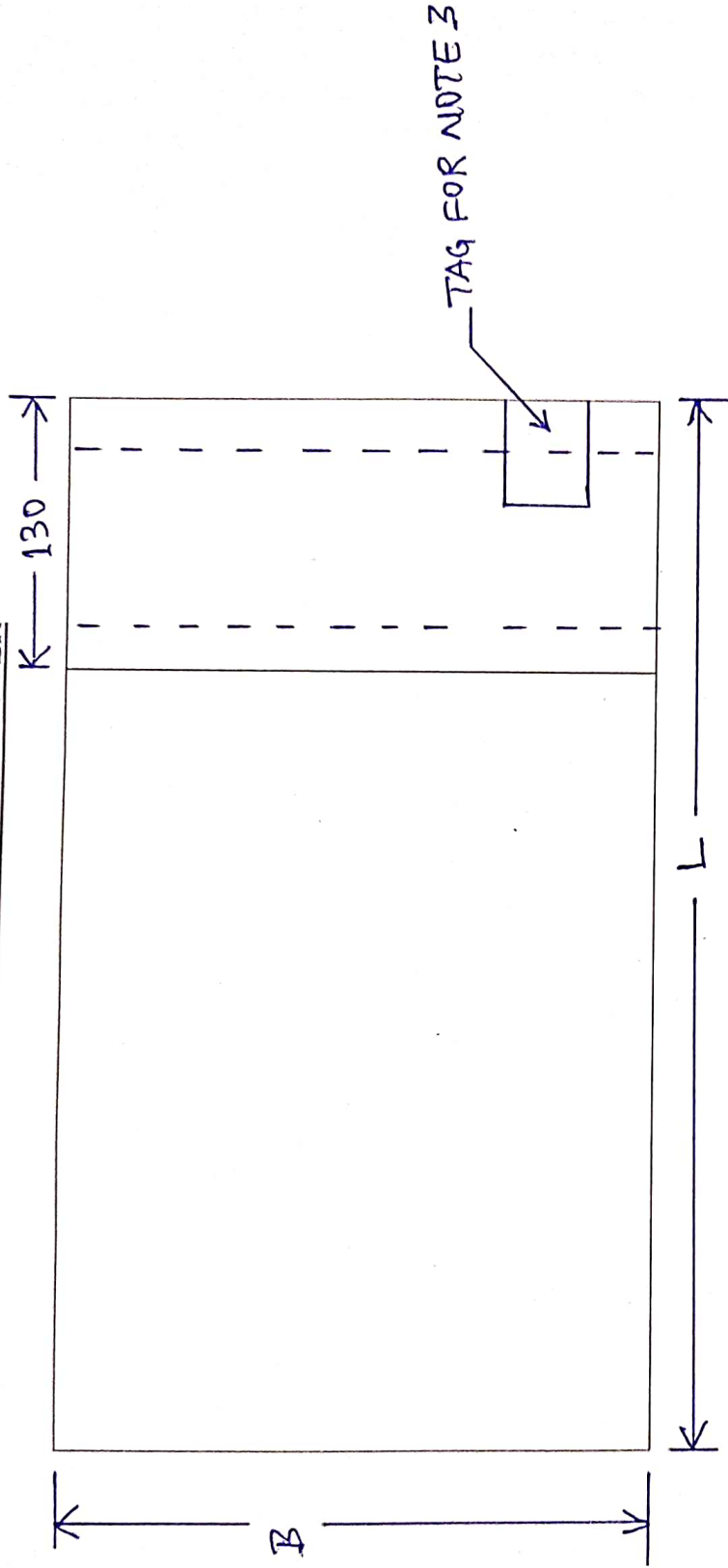

**Note:**

1. Specification: IS:18930/2024 or latest.
2. Colour of Pillow Outer Protective cover: Grey (Pantone shade: 16-3915 TPG)
3. Woven tag marked with blend composition of outer protective cover, manufacturer's name, initial or trademark, Size (LxB), month & year of manufacture, SECR mark should be stitched along with the seam at one inner corner edge of opening flap.
4. All dimensions are in mm.
5. Sketch is not to scale.
6. Size for 2A/3A: LxB = 500 x 360
7. Tolerance in size: L=+20 , B=+10