

### ASSEMBLY OF SIDE BEARER

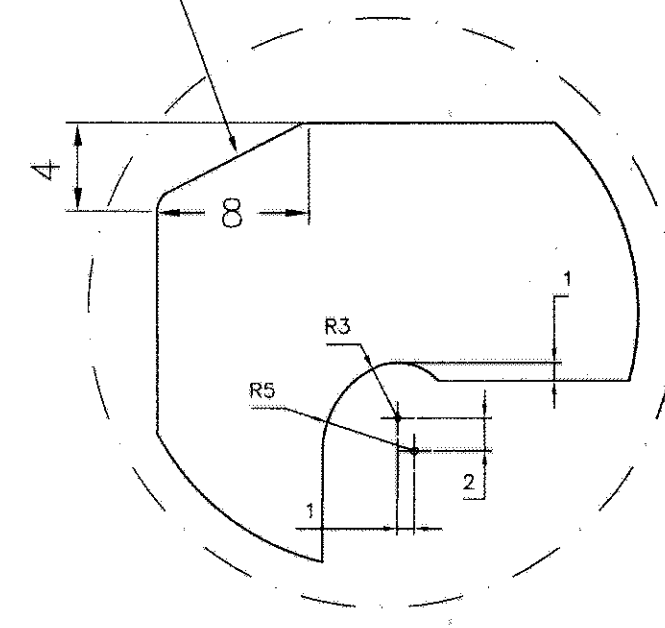

## DESIGN PARAMETERS OF CCSB

PARAMETERS	VALUE
FREE HEIGHT	163±1.5 mm
TEST SET UP HEIGHT	128.5 mm
SOLID HEIGHT	112.5 mm
PRE LOAD	1850±100 Kg
WEIGHT OF ASSEMBLY	16.4 kg (Approx)

9. SOLID HEIGHT OF THE SPRINGS SHOULD NOT BE MORE THAN AS SPECIFIED IN THIS DRAWING.
10. FIRM SHALL BE MANUFACTURING AT LEAST SPRINGS OR HOUSINGS. TESTING FACILITIES OF MANUFACTURED COMPONENTS ALONG WITH ASSEMBLED CCSB SHALL BE AVAILABLE WITH THE FIRM. INSPECTION AND TESTING OF MANUFACTURED COMPONENTS SHALL BE DONE AT FIRM'S PREMISE.
11. THE SPRINGS AND OUTER SURFACE OF SIDE BEARER ASSEMBLY SHALL BE PAINTED IN SYNTHETIC ENAMEL MIDDLE BRUNSWICK GREEN ISC 226 TO IS:8662 (NO MATING SURFACES OF HOUSING SHALL BE PAINTED).



### SPRING DESIGN DATA TABLE

DESCRIPTION	OUTER SPRING	INNER SPRING
FREE HEIGHT (Hf) (mm)	143±1	143±1
SOLID HEIGHT (Hs) (mm)	86.50	86.50
DEFLECTION FREE TO SOLID (mm)	56.50	56.50
WIRE DIA (d) (mm)	21.00	15.00
OUTER DIA OF COILS (D) (mm)	144.5	97.5
NO. OF EFFECTIVE COILS	3.02	4.66
SOLID CAPACITY (Kg)	1930	1090
SCRAG TEST LOAD (Kg)	1930	1090
VERTICAL STIFFNESS (KG/mm)	34.22	19.33
WINDING	R.H.	L.H.
WORKING HEIGHT (mm)	108.5	108.5

### TEST TABLE FOR SPRINGS

LOAD (TONNES)		0.25	0.5	0.75	1.00	1.25	1.5	TEST LOAD
HEIGHT (mm)	OUTER SPRING	135.69	128.39	121.09	113.78	106.48	99.18	86.5
	INNER SPRING	130.07	117.14	104.21	91.28	-	-	86.5

8	Ø4 SPLIT PIN	4	—	—	IS:549	—
7	M20 CASTLE NUT	4	—	0.1	IS:2232	—
6	SPRING WASHER	4	—	0.03	IS:2016	—
5	HIGH TENSILE BOLT M20X80-8.8	4	—	0.3	IS:1363	—
4	INNER SPRING	2	—	2.1	IS:3195 GR.52Cr4Mo2V	—
3	OUTER SPRING	2	—	4.5	IS:3195 GR.52Cr4Mo2V	—
2	TOP HOUSING	2	—	4.9	**	SEE NOTE 6
1	BOTTOM HOUSING	2	—	4.5	**	SEE NOTE 6
ITEM	DESCRIPTION & DIMENSIONS	NO.OF PER ROOF	REF: DRG:	WT.OF ONE (KG.)	MAT:&SPEC:	REMARKS

SUPERSEDED BY

SUPERSEDES			DATE
SCALE	PASSED	O.P.YADAV	08/14

1:2	CHECKED	S.K.SHARMA	08/14
1:1	DRAWN	UMESH	08/14

	TRACED		
	J.SHEET	WD-12008	02/12

B.G.	R.D.S.O. (W)
------	-----------------

FOR INDIAN RAILWAY FREIGHT BOGIES

## SIDE BEARER ASSEMBLY & DETAILS

(SPRING LOADED TYPE)

WD-12008-S/1

3	—	WD-20001	DRG. REVISED	01/20	
ALT.	ITEM	AUTHY.	DESCRIPTION	DATE	ASSEMBLY DRAWING