



दक्षिण पूर्व रेलवे  
SOUTH EASTERN RAILWAY

प्र. मु. संकेत व दूरसंचार अभियंता का कार्यालय  
तीसरी मंजिल नया प्रशासनिक भवन  
गार्डनरीच, कोलकाता- 700043

Office of the  
Principal Chief Signal & Telecom Engineer  
3rd Floor, New Administrative Building  
Garden Reach, Kolkata- 700043

संख्या/No. S&T/S/361/Pt. IX/ (Computer No. 124331) दिनांक/Date 06/05/2025

CSTE/CON,  
CSTE/PROJECT,  
South Eastern Railway,  
Garden Reach, Kolkata – 43.

Executive Director/Metro/RVNL,  
24, Deshpriya Sashmal Road,  
Tollygunge, (Beside Tollygunge Railway Station),  
Kolkata – 700 033

Sr. DSTE/Co./KGP,  
Sr. DSTE/Sig/KGP.  
Sr. DSTE/CKP, ADA & RNC.  
South Eastern Railway.

Pr. Executive Director/Eastern Region,  
RailTel Corporation of India Limited,  
19<sup>th</sup> Floor, Aurora Waterfront Building,  
Plot No. 34/1, Block – GN,  
Sector – V, Salt Lake City, Kolkata – 700 091.

General Manager/RITES,  
Eastern Region Project Office, Kolkata,  
Metro Railway Service Building, 2<sup>nd</sup> Floor,  
56, C. R. Avenue, Kolkata – 700 012.

Sub: Placement of earthing at S&T installation - Reg.

Ref: RDSO Document No. STS/E/TAN/3006 Version 3.0 dated 08/01/2025.

Please find herewith Annexure – III (a) & (b) and VI of TAN on Earthing, Bonding, Surge and Lightning Protection System issued by RDSO on 08/01/2025. In the said drawing, arrangement of earthing pits, their connectivity & their inter-connection and also location of earth pits with respect to S&T building has been shown along with other explanatory notes. It is advised to follow the guidelines scrupulously in all new works with immediate effect.

D/A: As above.

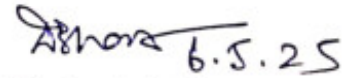
  
(Debasish Bhattacharjee)  
Chief Signal Engineer

Copy to:

1. PCSTE for kind information.
2. CAO/CON for kind information.

|                 |   |         |     |
|-----------------|---|---------|-----|
| Subject         | TAN on Earthing, Bonding, Surge and Lightning Protection System |         |     |
| Document Number | STS/E/TAN/3006  |         |     |
| Dated           | 08/01/2025  |         |     |
|                 |   | Version | 3.0 |
|                 |   | Pages   | 13  |
|                 |   |         | 7   |

(Ref: Annexure III of Guidelines for Earthing, Bonding, Surge and Lightning Protection System)

Annexure-III (a)

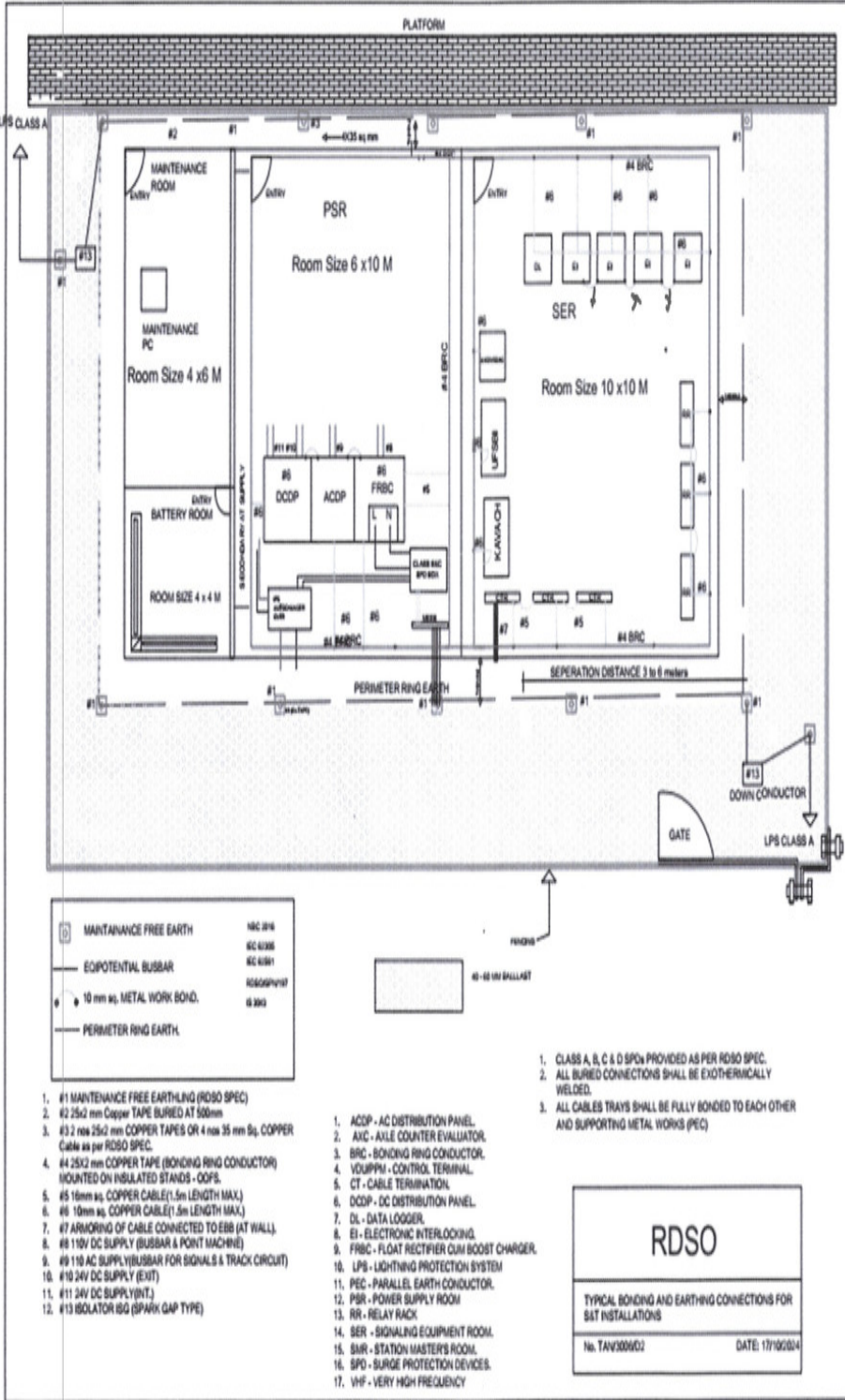

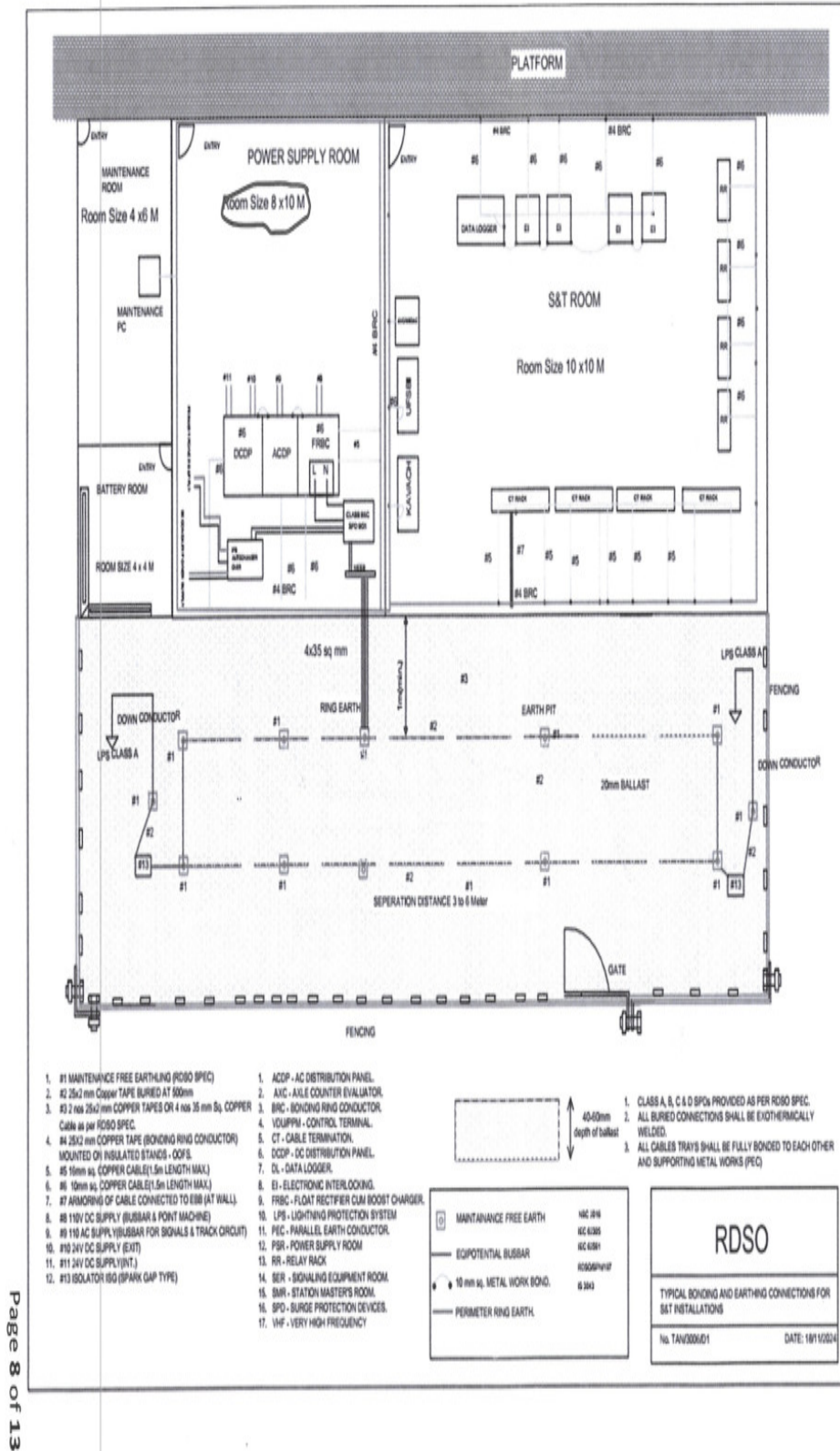

(Ref: Annexure III of Guidelines for Earthing, Bonding, Surge and Lightning Protection System)

**Annexure-III (b)**

|                 |   |
|-----------------|---|
| Subject         | TAN on Earthing, Bonding, Surge and Lightning Protection System |
| Document Number | STS/E/TAN/3006  |
| Dated           | 08/01/2025  |
| Version         | 3.0   |
| Pages           | 13  |
|                 | 8   |



|                 |   |         |     |
|-----------------|---|---------|-----|
| Subject         | TAN on Earthing, Bonding, Surge and Lightning Protection System |         |     |
| Document Number | STS/E/TAN/3006  |         |     |
| Dated           | 08/01/2025  |         |     |
|                 |   | Version | 3.0 |
|                 |   | Pages   | 13  |
|                 |   |         | 11  |

**Annexure VI**  
**Placement of Earthing at S&T Installation**  
(Ref: Annexure VIII of Guidelines for Earthing, Bonding, Surge and Lightning Protection System)

