

SECTION-AA

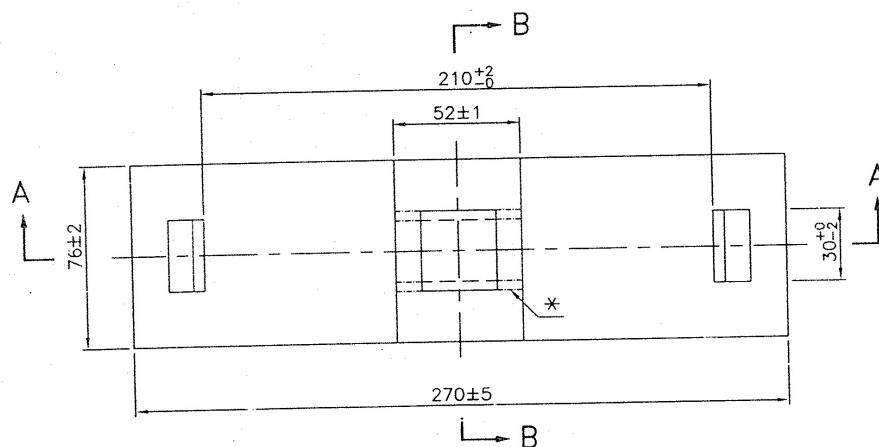

SECTION-BB

NOTE:-

1. THIS BRAKE BLOCK SUITS WHEEL WITH DIAMETER 915/813mm ON TREAD.
2. RDSO'S APPROVAL REQUIRED FOR NOTES MARKED THUS 'Ø'.
3. CHARACTERISTICS OF BRAKE BLOCK SHALL BE AS PER RDSO SPECIFICATION C-9809 LATEST REVISION.
4. PORTION MARKED THUS '*' IS OPTIONAL FOR DESIGN OF BACK PLATE AND KEY CLAMP.
5. MANUFACTURER WILL SUBMIT THE DRAWING OF BACK PLATE & BRAKE BLOCK INCLUDING WEIGHT OF BRAKE BLOCK TO RDSO FOR APPROVAL.
6. MATERIAL SPECIFICATION & GRADE OF BACK PLATE TO BE SPECIFIED BY THE MANUFACTURER. ROLLING TOLERANCE ON THICKNESS OF BACK PLATE SHALL BE AS PER IS-1852.
7. ALL DIMENSIONS ARE IN mm.
8. UNDEFINED TOLERANCES $\pm 1\text{mm}$.

⑥	1	SS/11/09	IS SPECIFICATION CORRECTED TO IS:1852 FROM IS:2102 UNDER NOTE-6 AND R2 ADDED IN END VIEW	05/09
⑤	1	SS/03/09	BRAKE BLOCK PROFILE MODIFIED NOTE-5 TO 8 ADDED TITLE BLOCK CHANGED	02/09
④	1	SS/25/03	DRG. REVISED & REDRAWN	07/03
ALT.	ITEM	AUTHY.	DESCRIPTION	CKD. DATE

1	'K' TYPE COMPOSITE BRAKE BLOCK	8			C-9809	
ITEM	DESCRIPTION & DIMENSIONS	No. OFF per Bogie	REF. DRG.	WT OF ONE (kg)	MATL. & SPEC.	REMARKS
ASSEMBLY DRGS.		SUPERSEDED BY:		INDIAN RAILWAY STANDARDS		
REFERENCE: -		SUPERSEDES: Alt. 5		MAIN LINE COACHING STOCK WITH BOGIE MOUNTED BRAKE SYSTEM		
SCALE 1:2		P		DIMENSIONS OF NON ASBESTOS BASED 'K' TYPE HIGH FRICTION COMPOSITE BRAKE BLOCK		
		C				
		D				
		J.S.	CD/20/98			
CHECK SHEET No.		B.G.	R.D.S.O. [CG]	SKETCH-98066		

“हह (असेक) असुराज असेक पं मलक संयुक्त रेल मंत्रालय) लखनऊ-228011. भारत के संविधान के अंतर्गत से मलक संयुक्त रेल मंत्रालय के विना दस्ता असेक य पं रूप से प्रयोग किया है”.