

scale 1 : 1
01.00 Wer
notice for lavatories
drwg. no. 14730

background: traffic white RAL 9016
lettering: traffic red RAL 3020

140 x 90

<ul style="list-style-type: none"> ● शौच जाने से पहले और बाद में कृपया पलश बला दें । ● कृपया पहिरवणी बनावट शौचालयों में लगे कमीड की सीट को गंदा न करें । ● कृपया शौचालय को साफ रखें और उसमें पानी न गिरावें । ● कृपया कमीड में कूड़ा न डालें । 	<ul style="list-style-type: none"> ● PLEASE FLUSH THE TOILET AFTER USE. ● PLEASE DO NOT SOIL THE TOILET SEAT IN WESTERN STYLE LAVATORIES. ● PLEASE KEEP THE LAVATORY CLEAN AND DRY. ● PLEASE DO NOT THROW WASTE INTO THE TOILET.
--	--

ICF/STD-6-4-048

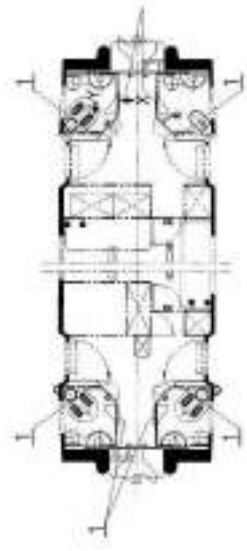

LOCATION OF INSIDE TOILET & OUTSIDE TOILET DOOR

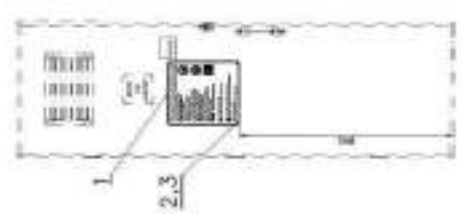

VIEW FROM -X

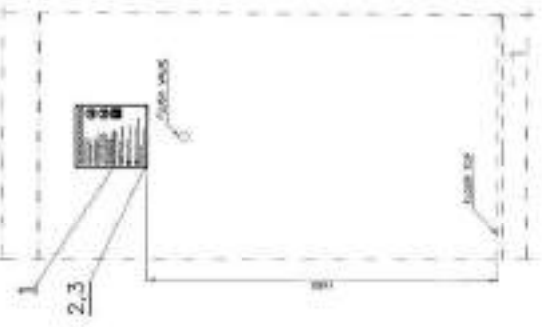

VIEW FROM -Y

- NOTE:**
- 1. LOCATION OF LITERATURE SHALL BE IN AT BLACK PAN, WHITE.
 - 2. LITERATURE SHALL BE IN AT BLACK PAN, WHITE.
 - 3. LITERATURE SHALL BE IN AT BLACK PAN, WHITE.
 - 4. LITERATURE SHALL BE IN AT BLACK PAN, WHITE.
 - 5. LITERATURE SHALL BE IN AT BLACK PAN, WHITE.
 - 6. LITERATURE SHALL BE IN AT BLACK PAN, WHITE.
 - 7. LITERATURE SHALL BE IN AT BLACK PAN, WHITE.
 - 8. LITERATURE SHALL BE IN AT BLACK PAN, WHITE.
 - 9. LITERATURE SHALL BE IN AT BLACK PAN, WHITE.
 - 10. LITERATURE SHALL BE IN AT BLACK PAN, WHITE.

ICF/STD-6-4-048	INDIAN RAILWAY STANDARDS	140	NOTES
1. ICF/STD-6-4-048	INDIAN RAILWAY STANDARDS	140	NOTES
2. ICF/STD-6-4-048	INDIAN RAILWAY STANDARDS	140	NOTES
3. ICF/STD-6-4-048	INDIAN RAILWAY STANDARDS	140	NOTES
4. ICF/STD-6-4-048	INDIAN RAILWAY STANDARDS	140	NOTES
5. ICF/STD-6-4-048	INDIAN RAILWAY STANDARDS	140	NOTES
6. ICF/STD-6-4-048	INDIAN RAILWAY STANDARDS	140	NOTES
7. ICF/STD-6-4-048	INDIAN RAILWAY STANDARDS	140	NOTES
8. ICF/STD-6-4-048	INDIAN RAILWAY STANDARDS	140	NOTES
9. ICF/STD-6-4-048	INDIAN RAILWAY STANDARDS	140	NOTES
10. ICF/STD-6-4-048	INDIAN RAILWAY STANDARDS	140	NOTES

NIL	STICKER SET	I	N/L	MOTS-136	QPC IN SET
HOLD LENGTH	DESCRIPTION & DIMENSIONS	SHEET	DETAIL QRS	WELL & SPEC.	REMARKS
NIL	GROUP	INTERIOR EQUIPMENTS & ACCESSORIES	SUPPLIERS	CCB4002	ALT N/L
WEIGHT	FILE	NCCB4002a.ppt (20)			
NIL	N2		SCALE	SEC/MO	DATE
NIL	N2		1:2	DB	DUGL
LENGTH / DIA			Ø	DN	VTKH
NIL	N	RAIL COACH FACTORY, KAPURTHALA	NO. ARE NO.	NIL	
WIDTH / THICK			PL NO.	NIL	
NIL	N	रेल कोच फैक्टरी कपूरथला	IR S		
HEIGHT			N/F	QRS	
NIL	N		9	10	11
			12	13	14

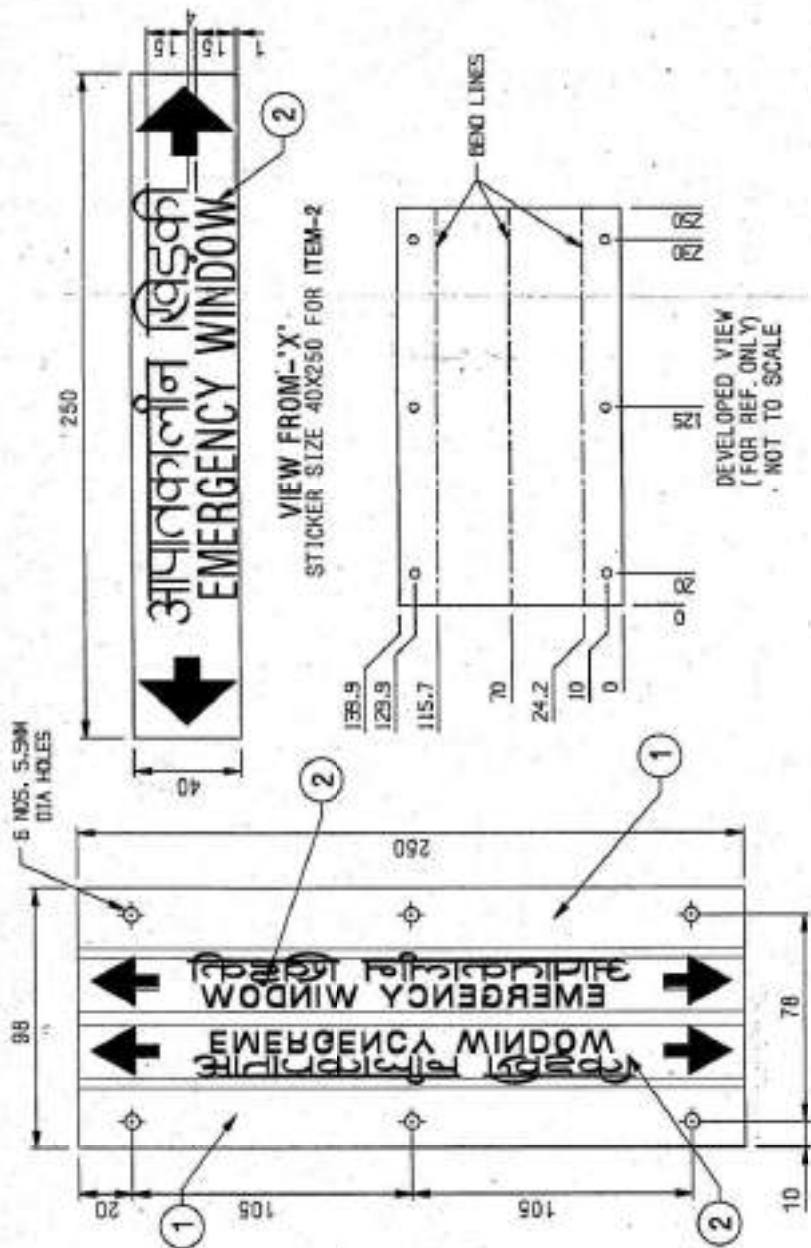

NOTE: =

1. ITEM-1 SHALL BE PAINTED IN COLOUR WHITE ON BOTH SIDES BEFORE PASTING THE STICKERS.
- * FOR ITEM-2
 2. BACKGROUND: YELLOW GREEN COLOUR.
 3. LETTERING: TRAFFIC RED RAL 3020.
- * 4. 3M LUMINOUS FILM 6900 OR EQUIVALENT.
5. 3M[®] ADHESION PROMOTER 85A SHALL BE USED PRIOR TO PASTING OF GLOW TYPE STICKERS.
6. MINIMUM ADHESION FORCE SHALL BE 25 NEWTON ON THE BASE MATERIAL PASTED ON FRP/HP/L SHEETS WITH GRAINY TEXTURE. TESTING SHALL BE DONE AS PER PARA 3.3.1 OF TL-91820.

अनारक
Enterex
न
Info
समिष्टिया
Dona Base

21 JAN 2009

[illegible]

[illegible]

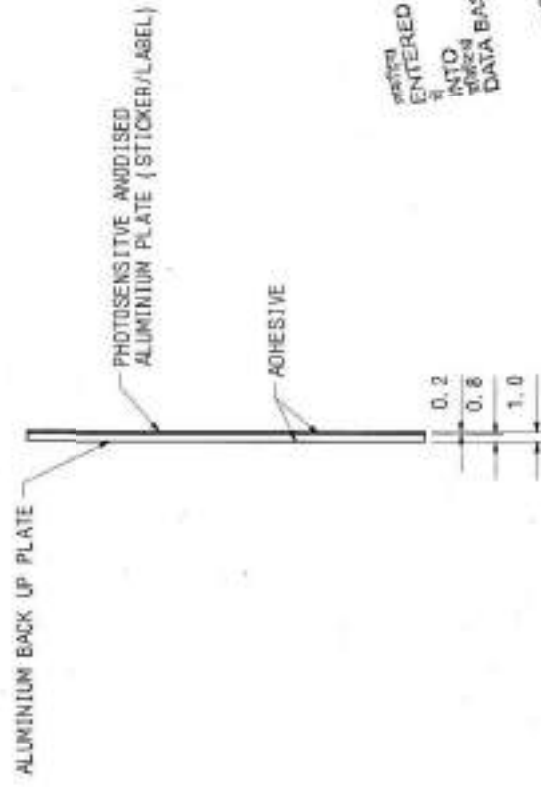
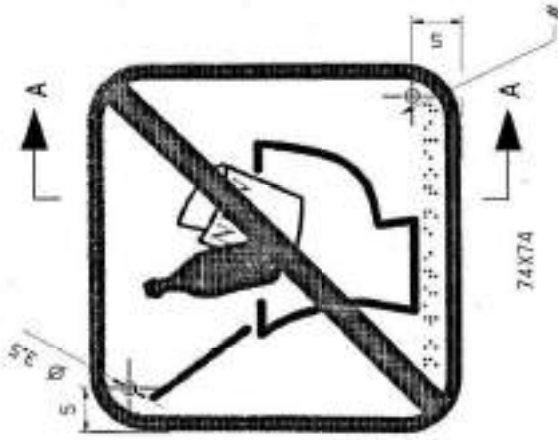

01 FEB 2020

SECTION -AA

- NOTE:-**
1. BACKGROUND : SIGNAL YELLOW RAL 1003.
 2. LETTERING : JET BLACK RAL 9005.
 3. ONLY FOR THE FIRST SUPPLY OF FIRM PILOT SAMPLE TO BE GOT APPROVED BY DESIGN OFFICE BEFORE BULK SUPPLY IS MADE.
 4. BACKGROUND AND LETTERING COLOR SHADE CAN ALSO BE ADVISED ALTERNATIVELY BY PURCHASER WITH APPROVAL OF DESIGN OFFICE.
 5. BRAILLE SCRIPT - 'NO WASTE IN TOILET'
 6. STICKER SHALL BE DIE CUT INCLUDING THE ROUND CORNERS.
 7. SUPPLIER NAME/LOGO INDICATING THE MONTH & YEAR OF MANUFACTURE TO BE PRINTED IN THE INDICATED SPACE.

REV	DATE	ZONE	DESCRIPTION	AUTHORITY
b	17/01/2020	ALL	1 ALUMINIUM BACKUP PLATE & HOLES ADDED. 2 NOTES 0&7 ADDED. 3 SECTION -AA ADDED.	DIC NO. MO1800031
c	30/01/2020	F-2	NOTE 3 MODIFIED.	DIC NO. MO1800031

WELD LENGTH	ITEM	DESCRIPTION & DIMENSIONS	QUANTITY	DETAILS	UNIT	QTY	REMARKS
NIL	1	BRASS PLATE	1	100x100	mm	1	
NIL	2	ADHESIVE	1	100x100	mm	1	
NIL	3	ALUMINIUM PLATE	1	100x100	mm	1	
NIL	4	STICKER	1	100x100	mm	1	
NIL	5	BRASS PLATE	1	100x100	mm	1	
NIL	6	ADHESIVE	1	100x100	mm	1	
NIL	7	ALUMINIUM PLATE	1	100x100	mm	1	
NIL	8	STICKER	1	100x100	mm	1	
NIL	9	BRASS PLATE	1	100x100	mm	1	
NIL	10	ADHESIVE	1	100x100	mm	1	
NIL	11	ALUMINIUM PLATE	1	100x100	mm	1	
NIL	12	STICKER	1	100x100	mm	1	
NIL	13	BRASS PLATE	1	100x100	mm	1	
NIL	14	ADHESIVE	1	100x100	mm	1	
NIL	15	ALUMINIUM PLATE	1	100x100	mm	1	
NIL	16	STICKER	1	100x100	mm	1	
NIL	17	BRASS PLATE	1	100x100	mm	1	
NIL	18	ADHESIVE	1	100x100	mm	1	
NIL	19	ALUMINIUM PLATE	1	100x100	mm	1	
NIL	20	STICKER	1	100x100	mm	1	
NIL	21	BRASS PLATE	1	100x100	mm	1	
NIL	22	ADHESIVE	1	100x100	mm	1	
NIL	23	ALUMINIUM PLATE	1	100x100	mm	1	
NIL	24	STICKER	1	100x100	mm	1	
NIL	25	BRASS PLATE	1	100x100	mm	1	
NIL	26	ADHESIVE	1	100x100	mm	1	
NIL	27	ALUMINIUM PLATE	1	100x100	mm	1	
NIL	28	STICKER	1	100x100	mm	1	
NIL	29	BRASS PLATE	1	100x100	mm	1	
NIL	30	ADHESIVE	1	100x100	mm	1	
NIL	31	ALUMINIUM PLATE	1	100x100	mm	1	
NIL	32	STICKER	1	100x100	mm	1	
NIL	33	BRASS PLATE	1	100x100	mm	1	
NIL	34	ADHESIVE	1	100x100	mm	1	
NIL	35	ALUMINIUM PLATE	1	100x100	mm	1	
NIL	36	STICKER	1	100x100	mm	1	
NIL	37	BRASS PLATE	1	100x100	mm	1	
NIL	38	ADHESIVE	1	100x100	mm	1	
NIL	39	ALUMINIUM PLATE	1	100x100	mm	1	
NIL	40	STICKER	1	100x100	mm	1	
NIL	41	BRASS PLATE	1	100x100	mm	1	
NIL	42	ADHESIVE	1	100x100	mm	1	
NIL	43	ALUMINIUM PLATE	1	100x100	mm	1	
NIL	44	STICKER	1	100x100	mm	1	
NIL	45	BRASS PLATE	1	100x100	mm	1	
NIL	46	ADHESIVE	1	100x100	mm	1	
NIL	47	ALUMINIUM PLATE	1	100x100	mm	1	
NIL	48	STICKER	1	100x100	mm	1	
NIL	49	BRASS PLATE	1	100x100	mm	1	
NIL	50	ADHESIVE	1	100x100	mm	1	
NIL	51	ALUMINIUM PLATE	1	100x100	mm	1	
NIL	52	STICKER	1	100x100	mm	1	
NIL	53	BRASS PLATE	1	100x100	mm	1	
NIL	54	ADHESIVE	1	100x100	mm	1	
NIL	55	ALUMINIUM PLATE	1	100x100	mm	1	
NIL	56	STICKER	1	100x100	mm	1	
NIL	57	BRASS PLATE	1	100x100	mm	1	
NIL	58	ADHESIVE	1	100x100	mm	1	
NIL	59	ALUMINIUM PLATE	1	100x100	mm	1	
NIL	60	STICKER	1	100x100	mm	1	
NIL	61	BRASS PLATE	1	100x100	mm	1	
NIL	62	ADHESIVE	1	100x100	mm	1	
NIL	63	ALUMINIUM PLATE	1	100x100	mm	1	
NIL	64	STICKER	1	100x100	mm	1	
NIL	65	BRASS PLATE	1	100x100	mm	1	
NIL	66	ADHESIVE	1	100x100	mm	1	
NIL	67	ALUMINIUM PLATE	1	100x100	mm	1	
NIL	68	STICKER	1	100x100	mm	1	
NIL	69	BRASS PLATE	1	100x100	mm	1	
NIL	70	ADHESIVE	1	100x100	mm	1	
NIL	71	ALUMINIUM PLATE	1	100x100	mm	1	
NIL	72	STICKER	1	100x100	mm	1	
NIL	73	BRASS PLATE	1	100x100	mm	1	
NIL	74	ADHESIVE	1	100x100	mm	1	
NIL	75	ALUMINIUM PLATE	1	100x100	mm	1	
NIL	76	STICKER	1	100x100	mm	1	
NIL	77	BRASS PLATE	1	100x100	mm	1	
NIL	78	ADHESIVE	1	100x100	mm	1	
NIL	79	ALUMINIUM PLATE	1	100x100	mm	1	
NIL	80	STICKER	1	100x100	mm	1	
NIL	81	BRASS PLATE	1	100x100	mm	1	
NIL	82	ADHESIVE	1	100x100	mm	1	
NIL	83	ALUMINIUM PLATE	1	100x100	mm	1	
NIL	84	STICKER	1	100x100	mm	1	
NIL	85	BRASS PLATE	1	100x100	mm	1	
NIL	86	ADHESIVE	1	100x100	mm	1	
NIL	87	ALUMINIUM PLATE	1	100x100	mm	1	
NIL	88	STICKER	1	100x100	mm	1	
NIL	89	BRASS PLATE	1	100x100	mm	1	
NIL	90	ADHESIVE	1	100x100	mm	1	
NIL	91	ALUMINIUM PLATE	1	100x100	mm	1	
NIL	92	STICKER	1	100x100	mm	1	
NIL	93	BRASS PLATE	1	100x100	mm	1	
NIL	94	ADHESIVE	1	100x100	mm	1	
NIL	95	ALUMINIUM PLATE	1	100x100	mm	1	
NIL	96	STICKER	1	100x100	mm	1	
NIL	97	BRASS PLATE	1	100x100	mm	1	
NIL	98	ADHESIVE	1	100x100	mm	1	
NIL	99	ALUMINIUM PLATE	1	100x100	mm	1	
NIL	100	STICKER	1	100x100	mm	1	

DETAIL DGS STARTING WITH "LIP" ARE INTERNAL REFERENCE LISTS ONLY AND ARE NOT FOR ISSUE.
THIS IS A COMPUTER GENERATED DRAWING. ANY MANUAL ALTERATION SHALL AUTOMATICALLY RENDER IT INVALID.
FOR UNFOLDED DIMENSIONS REFER MO00008 DATE OF FIRST ISSUE 10/10/2013 CGM BY

1		2		3		4		5		6		7		8		9		10		11		12		13	
													<p>ALUMINUM BACK PLATE</p> <p>PHOTOSENSITIVE ANODISED ALUMINUM PLATE (STICKER/LABEL)</p> <p>ADHESIVE</p> <p>0.2</p> <p>0.8</p> <p>1</p>												
<p>NOTE:-</p> <ol style="list-style-type: none"> 1. BACKGROUND : SIGNAL YELLOW RAL 1003. 2. LETTERING : JET BLACK RAL 9005. 3. ONLY FOR THE FIRST SUPPLY OF FIRM PILOT SAMPLE TO BE GOT APPROVED BY DESIGN OFFICE BEFORE BULK SUPPLY IS MADE. 4. BACKGROUND AND LETTERING COLOR SHADE CAN ALSO BE ADVISED ALTERNATIVELY BY PURCHASER WITH APPROVAL OF DESIGN OFFICE. 5. BRAILLE SCRIPT - 'SOAP DISPENSER' 6. STICKER SHALL BE CUT INCLUDING THE ROUND CORNERS. 7. SUPPLIER NAME/ LOGO INDICATING THE MONTH & YEAR OF MANUFACTURE TO BE PRINTED IN THE INDICATED SPACE. 													<p>SECTION-AA</p>												
<p>ENTERED INTO DATA BASE</p> <p>61 FEB 2000</p>													<p>61 FEB 2000</p>												
<p>1. ALUMINUM BACKUP PLATE & HOLES ADDED.</p> <p>2. NOTES 6 & 7 ADDED.</p> <p>3. SECTION -AA ADDED.</p>													<p>DIC NO. MD190031</p>												
<p>30/01/2020 2-2</p> <p>NOTE 3 MODIFIED.</p>													<p>DIC NO. MD190031</p>												

THIS DRAWING IS THE PROPERTY OF THE DESIGN FACTORY, KANPUR. IT IS TO BE KEPT IN THE DESIGN FACTORY AND NOT TO BE CIRCULATED OUTSIDE. IT IS TO BE KEPT IN THE DESIGN FACTORY AND NOT TO BE CIRCULATED OUTSIDE.

DETAIL DRWS STARTING WITH "LI" ARE INTERNAL REFERENCE LISTS ONLY AND ARE NOT FOR ISSUE. THIS IS A COMPUTER GENERATED DRAWING. ANY MANUAL ALTERATION SHALL AUTOMATICALLY RENDER IT INVALID. FOR UNTOLERANCED DIMENSIONS REFER MOD008 DATE OF FIRST ISSUE 15/10/2013 CDM BY

ITEM	DESCRIPTION & QUANTITY	UNIT	QTY	DATE	BY	REMARKS
1	SOAP DISPENSER WITH BRAILLE SCRIPT	NO	1	15/10/2013	CDM	
2	ALUMINUM BACK PLATE	NO	1	15/10/2013	CDM	
3	PHOTOSENSITIVE ANODISED ALUMINUM PLATE (STICKER/LABEL)	NO	1	15/10/2013	CDM	
4	ADHESIVE	NO	1	15/10/2013	CDM	
5	SOAP DISPENSER WITH BRAILLE SCRIPT	NO	1	15/10/2013	CDM	
6	ALUMINUM BACK PLATE	NO	1	15/10/2013	CDM	
7	PHOTOSENSITIVE ANODISED ALUMINUM PLATE (STICKER/LABEL)	NO	1	15/10/2013	CDM	
8	ADHESIVE	NO	1	15/10/2013	CDM	
9	SOAP DISPENSER WITH BRAILLE SCRIPT	NO	1	15/10/2013	CDM	
10	ALUMINUM BACK PLATE	NO	1	15/10/2013	CDM	
11	PHOTOSENSITIVE ANODISED ALUMINUM PLATE (STICKER/LABEL)	NO	1	15/10/2013	CDM	
12	ADHESIVE	NO	1	15/10/2013	CDM	
13	SOAP DISPENSER WITH BRAILLE SCRIPT	NO	1	15/10/2013	CDM	
14	ALUMINUM BACK PLATE	NO	1	15/10/2013	CDM	
15	PHOTOSENSITIVE ANODISED ALUMINUM PLATE (STICKER/LABEL)	NO	1	15/10/2013	CDM	
16	ADHESIVE	NO	1	15/10/2013	CDM	
17	SOAP DISPENSER WITH BRAILLE SCRIPT	NO	1	15/10/2013	CDM	
18	ALUMINUM BACK PLATE	NO	1	15/10/2013	CDM	
19	PHOTOSENSITIVE ANODISED ALUMINUM PLATE (STICKER/LABEL)	NO	1	15/10/2013	CDM	
20	ADHESIVE	NO	1	15/10/2013	CDM	

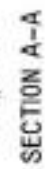

DETAIL DROPS STARTING WITH "41" ARE INTERNAL REFERENCE LISTS ONLY AND ARE NOT FOR ISSUE. THIS IS A COMPUTER GENERATED BRWING. ANY MANUAL ALTERATION SHALL AUTOMATICALLY RENDER IT INVALID.

FOR UNRELEASED DIMENSIONS REFER H000000	DATE OF FIRST ISSUE	21/10/2013	CIGN BY
---	---------------------	------------	---------

1. BACKGROUND : SIGNAL YELLOW RAL 1003.
2. LETTERING : JET BLACK RAL 9005.
3. ONLY FOR THE FIRST SUPPLY OF FIRM PILOT SAMPLE TO BE GOT APPROVED BY DESIGN OFFICE BEFORE BULK SUPPLY IS MADE.
4. BACKGROUND AND LETTERING COLOR SHADE CAN ALSO BE ADVISED ALTERNATIVELY BY PURCHASER WITH APPROVAL OF DESIGN OFFICE.
5. STICKER SHALL BE DTE OUT INCLUDING THE ROUND CORNERS.
6. SUPPLIER NAME/LOGO INDICATING THE MONTH & YEAR OF MANUFACTURE TO BE PRINTED IN THE INDICATED SPACE.

DATA ENTERED
INTO
DATA BASE

[illegible]

DATE	TIME	BY	REMARKS
16 MAR 2021	10:00	1	ENTERED INTO SYSTEM DATA BASE

ITEM NO.	DESCRIPTION	QTY	UNIT	REMARKS
1	TRAFFIC RED RAL 3020	1000	LITRE	
2	JET BLACK RAL 9005	1000	LITRE	

74X74

NOTE:-

1. BACKGROUND : SIGNAL YELLOW RAL 1003.
2. LETTERING : JET BLACK RAL 9005 & TRAFFIC RED RAL 3020.
3. ONLY FOR THE FIRST SUPPLY OF FIRM PILOT SAMPLE TO BE GOT APPROVED BY DESIGN OFFICE BEFORE BULK SUPPLY IS MADE.
4. BACKGROUND AND LETTERING COLOR SHADE CAN ALSO BE ADVISED ALTERNATIVELY BY PURCHASER WITH APPROVAL OF DESIGN OFFICE.
5. BRAILLE SCRIPT - "NO SMOKING"
6. STICKER SHALL BE CUT INCLUDING THE ROUND CORNERS.
7. SUPPLIER NAME/LOGO INDICATING THE MONTH & YEAR OF MANUFACTURE TO BE PRINTED IN THE INDICATED SPACE.

DATE	TIME	BY	REMARKS
24/10/2013	10:00	1	ENTERED INTO SYSTEM DATA BASE