

28 DIA, 2 HOLES

ONE FOR EACH  
LAYOUT-1 IN 12 TURNOUT  
R.G. 60 Kg (WITH ZUI-60 THICK  
WEB TONGUE RAIL) WITH ALT-A  
P-BRACKET Ver.1

NO. DESCRIPTION  
OFF. FOR ASSEMBLY NO.

R. D. S. O.

LAYOUT- 60 KG (TWS)  
-INSULATION PLATE (R.H.)

DATE 22-10-2019

RDSO/S 3592

MATL & SPEC	THERMOPLASTIC POLY URETHANE MOULDED INSULATION RDSO/SPN/S/168/02 IRS : S 23
SCALE	MILLIMETRES 10 0 10 30 DO NOT SCALE

1. ALL DIMENSIONS IN MILLIMETRES.

NOTE

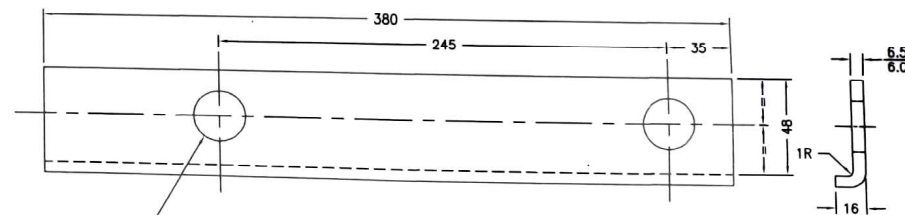

28 DIA, 2 HOLES

ONE FOR EACH  
LAYOUT-1 IN 12 TURNOUT  
R.G. 60 Kg (WITH ZUI-60 THICK  
WEB TONGUE RAIL) WITH ALT-A  
P-BRACKET Ver.1

NO. DESCRIPTION  
OFF. FOR ASSEMBLY NO.

R. D. S. O.

LAYOUT- 60 KG (TWS)  
-INSULATION PLATE (L.H.)

DATE 22-10-2019

RDSO/S 3593

MATL & SPEC	THERMOPLASTIC POLY URETHANE MOULDED INSULATION RDSO/SPN/S/168/02 IRS : S 23
SCALE	MILLIMETRES 10 0 10 30 DO NOT SCALE

1. ALL DIMENSIONS IN MILLIMETRES.

NOTE

ALT. DESCRIPTION DATE

CALCULATION REGISTER No.

PAGES DONE BY  
CHD.

DRN.

CHD.

TRD.

CHD.

CASE No. STS/E/PM/220mm VOL-1

PASSED

APPROVED

7/11/19