

1



Office of the,
Principal Chief Engineer
Western Railway HQ
Churchgate,
Mumbai-400 020

No. W65/3(Policy)E403
WR-HQ0ENGG(WBPQ)/3/2019

Date: 05.02.2026

Sr.DEN(Co)MMCT, BRC, ADI, RTM, RJT & BVP

Sub: Issuance of Type Plan for temporary barricading to be used at construction site

Please find enclosed the drawing of following Type Plan.

The details of drawing are as follows:

Sr.No.	Approved Drawing No.	Description
1.	TP-BR-129HQ/2025	Type plan for temporary barricading to be used at construction site

Encl: As above

Digitally Signed by Tanuj
Gupta
(Tanuj Gupta)
Date: 05.02.2026 15:59:05
Reason: Approved
By: CE (Design)

C/-DRM-MMCT, BRC, ADI, RTM, RJT & BVP

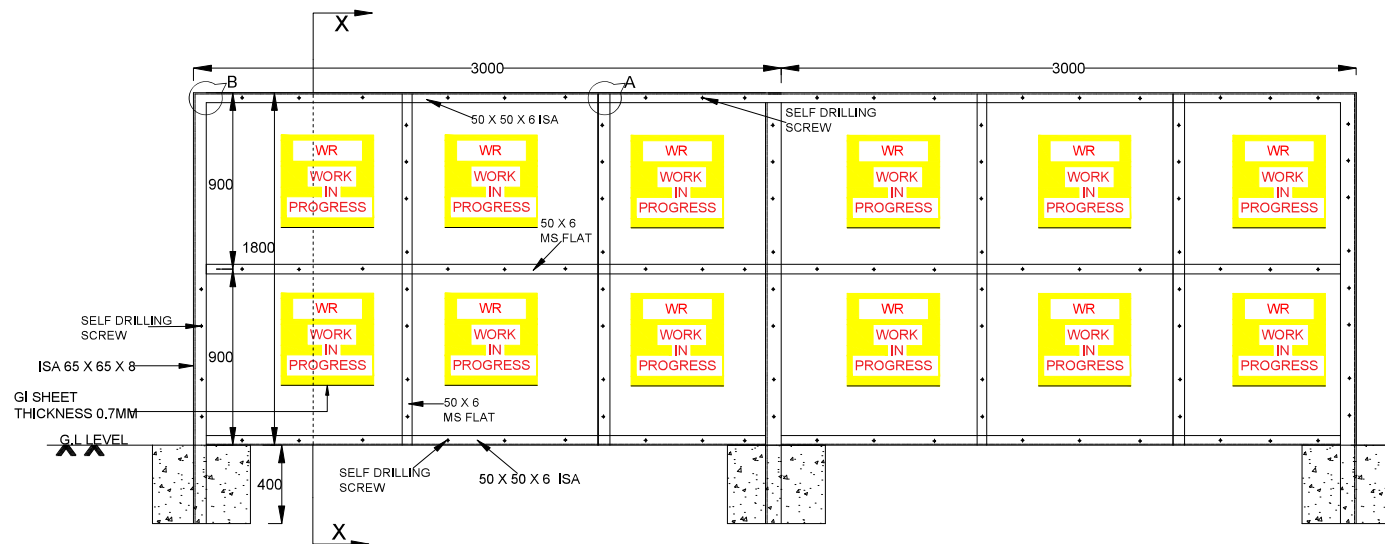

ELEVATION

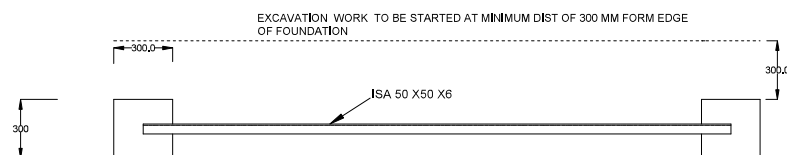

PLAN

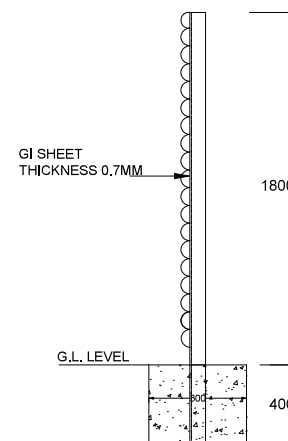

SIDE VIEW X-X

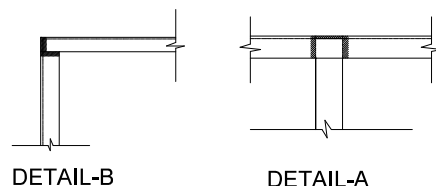

DETAILS A-B

IMPORTANT NOTE

1. ALL DIMENSIONS ARE IN MILLIMETERS IN METER UNLESS WRITTEN OTHERWISE.
2. STEEL SHALL BE CONFORMING TO IS 2062, QUALITY "A" GRADE DESIGNATION E250.
3. ALL WELD SHALL BE 4 MM THK MIG WELDING.
4. THIS BARRICADING CAN BE USED AT CONSTRUCTION SITE.
5. THIS IS NOT DESIGNED FOR ANY KIND OF IMPACT LOAD, WIND LOAD & SEISMIC LOAD.
6. RETROREFLECTIVE BANNER INDICATING WORK IN PROGRESS TO BE PASTED ON PUBLIC SIDE OF BARRICADE.
7. GRADE OF CONCRETE FOR PCC SHOULD BE M 20.
8. SELF DRILLING SCREW TO BE USED TO ATTACH SHEETS TO THE FRAME
9. THIS ARRANGEMENT SHOWS ONLY TWO UNITS HOWEVER AS PER REQUIREMENT THIS ARRANGEMENT CAN BE EXTENDED TO REQUIRED NUMBERS OF UNITS.
10. LENGTH OF SINGLE UNIT MAY VARY HOWEVER MAXIMUM LENGTH OF SINGLE UNIT SHOULD NOT TO EXCEED 3 METER
11. THE COLOUR OF GI SHEET SHALL BE LIGHT GREY.
12. GI SHEET THICKNESS IS 0.7 MM

PROVISIONAL

WESTERN RAILWAY

TEMPORARY BARRICADING TO BE USED AT CONSTRUCTION SITE

DYCE-DESIGN-CCG

TANUJ GUPTA Digitally signed by TANUJ GUPTA
Date: 2026.02.05 11:12:56 +05'30'

AEN-DESIGN-II-CCG

RAVIRANJAN SHARMA Digitally signed by RAVIRANJAN SHARMA
Date: 2026.02.05 11:34:07 +05'30'

SSE-DESIGN-IV-CCG

NARESH KUMAWAT Digitally signed by NARESH KUMAWAT
Date: 2026.01.30 13:49:16 +05'30'

TYPE PLAN NO. TP-BR-129 HQ
2026