

SECTION-BB

NOTE:-

1. CUSHION TO BE PASTED TO THE CONCREG WITH APPROVED BRAND OF WATER PROOF ELITE.
2. NECESSARY CUT-A-WAYS TO BE DONE TO SUIT AT SITE.
3. COLOUR OF UPHOLSTERY SHOULD BE AS PER THE INTERIOR COLOUR SCHEME OF COACH.
4. THREAD SHOULD BE DYED & BONDED AND THE COLOUR OF THREAD SHOULD MATCH WITH THE COLOUR OF REXINE. THE PITCH OF THE STITCH SHALL BE 2 TO 3 mm.
5. FELT AND REXINE PACKING TO BE PASTED PROPERLY ON THE FRAME WITH APPROVED BRAND OF ADHESIVE.
6. REXINE SHOULD BE STITCHED IN SUCH A MANNER THAT NO FOLDS ARE VISIBLE AT THE CORNERS.
- * 7. REXINE TO BE PASTED ON BEARING BLOCKS WITH APPROVED BRAND OF ADHESIVE.
8. REXINE (ITEM-7) TO BE PASTED PROPERLY AT THE BOTTOM OF THE BERTH WITH APPROVED BRAND OF ADHESIVE IN SUCH A MANNER THAT THERE SHOULD BE NO BALLOONING.

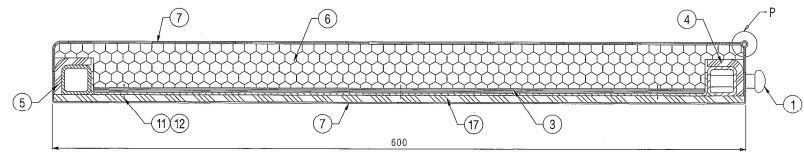

SECTION-AA

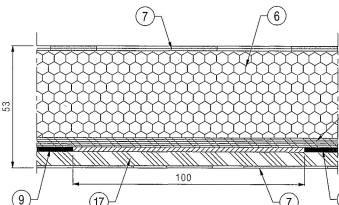

SECTION-DD

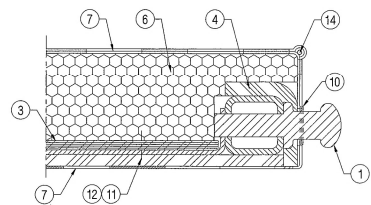

SECTION-CC

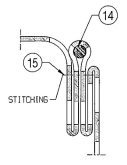

DETAIL AT 'P'
(STITCHING DETAIL AT CORNERS)

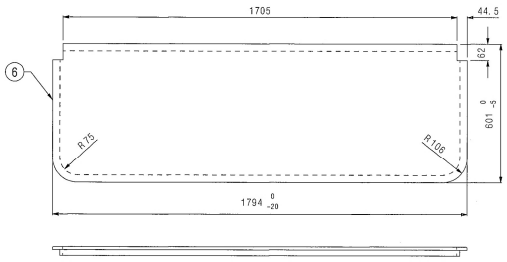

DETAIL AT 'R'

ALT. NO.	ALT. DATE	ZONE	ALTERATIONS	AUTHORITY
NIL	NIL	NIL	NIL	NIL

30 AUG 2012

17	FELT 6X600X1778	1	NIL	IS: 1719-88 TAB-1, MEDIUM	NIL
16	SLOTTED PAN HD TAPP SCREW ST3-SX16-C (A2-70 TO IS1387,PT.14-04)	2	NIL	IS: 7173-89 ISO: 1481	NIL
15	SEWING THREAD L-5000	1	NIL	IS: 4229-92 6.5,VAR. L2	NIL
14	COTTON THREAD 3/85000	1	NIL	IS: 1729-78	NIL
13	NAME PLATE	1	CGS1189	NIL	NIL
12	PLAIN WASHER A5.5	15	LIHW09	IS: 2016-1967 ALUMINIUM	ITEM-34
11	CSK HEAD RIVET ALUMINIUM SX12	15	LIHW05	IS: 2907-1984 ALUMINIUM	ITEM-34
10	EYELET	2	SEGI262	NIL	NIL
9	REXIN PACKING 250X540	4	NIL	ROSO/2008/ CG-07	NIL
8	SIDE REXINE 150X650	2	NIL	ROSO/2008/ CG-07	NIL
7	TOP REXINE 1450X1983	1	NIL	ROSO/2008/ CG-07	NIL
6	CUSHION 38X601X1794	1	NIL	ROSO/SPEC. C-4607	NIL
5	FELT 6X53X1640	1	NIL	IS: 1719-88 TAB-1, MEDIUM	NIL
4	FELT 6X53X2745	1	NIL	IS: 1719-88 TAB-1, MEDIUM	NIL
3	CONCREG PANEL 4X53X1713	1	NIL	ROSO/SPEC. C-5407, TYPE-1	NIL
2	REXINE PACKING 409X540	4	NIL	ROSO/2008/ CG-07	NIL
1	FRAME	1	IS: 1185	NIL	NIL
SUPERSEDES: NIL					
WELD LENGTH: NIL					
WEIGHT: NIL					
24,000 KG					
S. AREA: NIL					
NIL					
WH/TH/THICK: NIL					
NIL					
HEIGHT: NIL					
NIL					

TRANSVERSE MIDDLE BERTH
COMPLETE

RAIL COACH FACTORY, KAPURTHALA

रेल कोच फैक्टरी कपूरथला

IRS

PL NO. 00000000
DRG.NO. LS61184

ANY MANUAL ALTERATION SHALL AUTOMATICALLY RENDER THIS DRAWING INVALID.
FOR UNTOLERANCED DIMENSIONS REFER MDG00008

DETAIL DRGS STARTING WITH "LI" ARE INTERNAL REFERENCE LISTS ONLY AND ARE NOT FOR ISSUE.

DATE OF FIRST ISSUE 01/08/2012

COM BY

1 2 3 4 5 6 7 8 9 10 11 12 13 14 15 16 17 18 19