

ELEVATION

FOLLOWING TO BE EMBOSSED HERE

X - CAVITY No OF MOULD  
YY- FIRM INITIAL/TRADE MARK  
ZZ- LAST TWO DIGITS OF YEAR  
OF MANUFACTURE

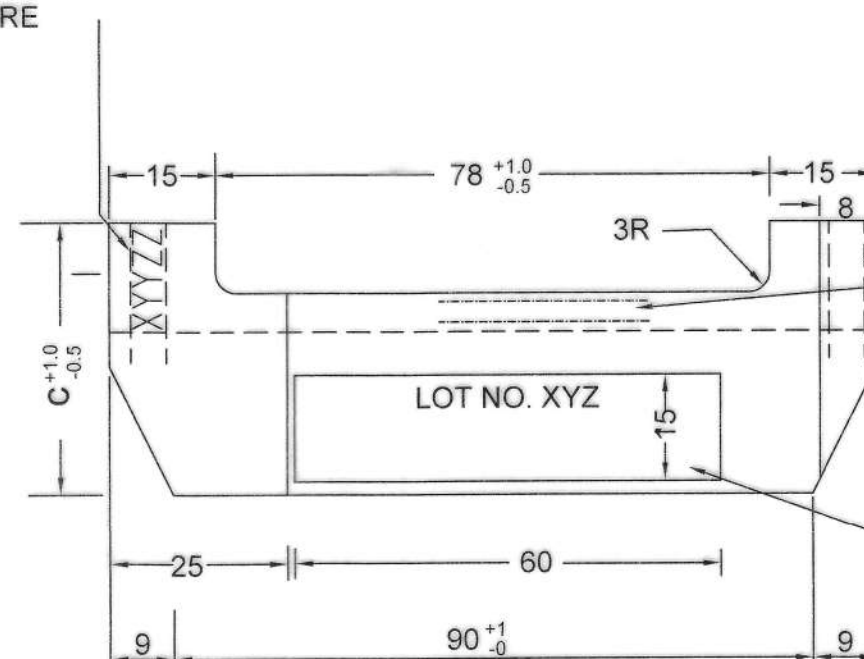

### PLAN

- PART NUMBER TO BE  
EMBOSSSED HERE.

IDENTIFICATION MARK  
TO BE EMBOSSED HERE AS  
60 Kg UIC/60E1  
OR  
52 Kg G.S.  
OR  
52 Kg N.G.S.

SPACE FOR SCREEN PRINTING.  
ONLY FOR GFN LINER  
(SEE NOTE No. 6,7)

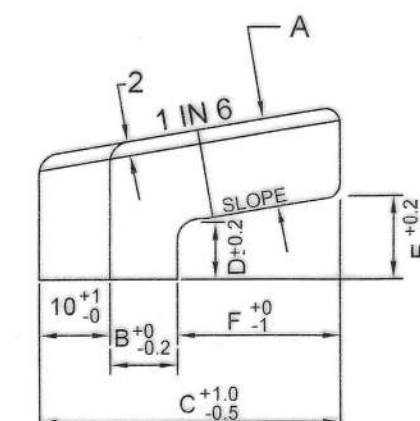

SIDE ELEVATION  
FOR 52 Kg. RAIL

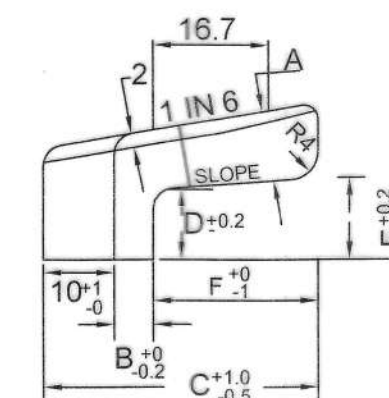

SIDE ELEVATION  
FOR 60 Kg. (UIC)/60E1 RAIL

SCHEME FOR SCREEN PRINTING FOR GFN LINER

S.No.	LINER DRG. No.	COLOUR BAND	PRINT OF COLOUR BAND
1.	RDSO/T- 8751	RED	LOT No. XYZ, 60 Kg. RAIL ON 52 Kg./60 Kg. WIDER SLEEPER
2.	RDSO/T- 8752	YELLOW	LOT No. XYZ, 52 Kg. RAIL ON 52 Kg./60 Kg. WIDER SLEEPER(GS)
3.	RDSO/T- 8753	LIGHT GREEN	LOT No. XYZ, 52 Kg. RAIL ON 52 Kg./60 Kg. WIDER SLEEPER(NGS)

TABLE

S.No.	RAIL SECTION	DRG:NO./PART NO. MARK	IDENTIFICATION	A	B	C	D	E	F	SLOPE
1.	60Kg.(UIC) /60E1	RDSO/T-8751	60 Kg.	9.9	5.5	42.5	10.0	11.9	27.0	1 IN 14
2.	52 Kg.	RDSO/T-8752	52 Kg.G.S.	11.5	9.0	42.0	8.0	11.8	23.0	1 IN 6
3.	52 Kg.	RDSO/T-8753	52 Kg. N.G.S.	12.5	15.0	48.0	8.0	11.8	23.0	1 IN 6

COLOUR CODE FOR HVN LINER

S.No.	LINER DRG. No.	COLOUR	RAL COLOUR CODE
1.	RT-8706 RT-8751	BROWN RED	3011
2.	RT-8707 RT-8752	MINT GREEN	6029
3.	RT-8708 RT-8753	COBALT BLUE	5013

ALT.3

THIS DRAWING IS THE PROPERTY OF  
RESEARCH DESIGNS AND STANDARDS ORGANISATION  
(MINISTRY OF RAILWAYS)  
LUCKNOW-226011,INDIA  
AND SHALL NOT BE USED, COPIED, REPRODUCED IN  
PART OR WHOLE WITHOUT PRIOR CONSENT IN WRITING

R. D. S. O.

GFN-66/ HVN-66 INSULATING  
LINER FOR USE WITH WIDER  
PSC SLEEPER TO DRAWING NO.  
RDSO/T-8746 SUITABLE FOR  
60Kg.(UIC)/ 60E1 & 52 Kg. RAILS

STAND-----	ADVANCE (T)
CANCLD-----	25-09-2018
REV-----	

RDSO/T- 8751 TO RDSO/T-8753

7. FOR HVN LINER, COLOUR OF FINISHED LINER SHALL BE AS PER TABLE TITLED " COLOUR CODE FOR HVN LINER" AND LOT NO. XYZ SHALL BE SCREEN PRINTED IN WHITE COLOUR / LASER PRINTED WITH CHARACTERS SIZE NOT LESS THAN 5 MM
6. THE GFN LINERS SHALL BE SCREEN PRINTED WITH COLOUR BANDS IN DIFFERENT COLOURS AS PER TABLE TITLED "SCHEME FOR SCREEN PRINTING FOR GFN LINER" WITH CHARACTERS SIZE 3 MM APPEARING IN NATURAL COLOUR OF THE LINER. THE LOCATION OF COLOUR BAND IS SHOWN IN THE PLAN.
5. DIMENSIONAL INSPECTION OF LINERS SHOULD BE DONE WITH THE INSPECTION GAUGES AS PER DRG NO. RDSO/T-8989.
4. (A) G.S. STANDS FOR GAUGE SIDE OF 52 Kg RAIL.  
(B) N.G.S. STANDS FOR NON GAUGE SIDE OF 52 Kg RAIL.
3. ALL SHARP EDGES TO BE ROUNDED OFF TO ABOUT 2R, EXCEPT WHERE OTHERWISE MENTIONED.
2. TOLERANCES ON DIMENSIONS WHERE NOT MENTIONED, SHALL BE  $\pm 0.2\text{MM}$ .
1. ALL DIMENSIONS ARE IN MILLIMETRES.

IRST-44



3 | DRAWING NO. IN COLOUR  
CODE TABE HAS BEEN  
CORRECTED

2 REVISED &amp; REDRAWN

02.05.24

11.09.23

NOTE

## SPECIFICATION

## SCALE

ALT:

DESCRIPTION

DATE

RDSO/T- 8751 TO RDSO/T-8753