

DD/T-CS
APD
FILE ET/EE/MSC DRG. C-1+
PAGE SN 377...
K-1-14-15
APR BY ADE CDA
TRC K.K. CH:
DRG K.K. CH:
CAL: CH:
FILE ET/EE/DEV C.A.V. PAGE 38
PAGE 38

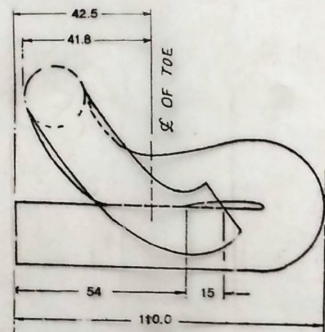

ELEVATION

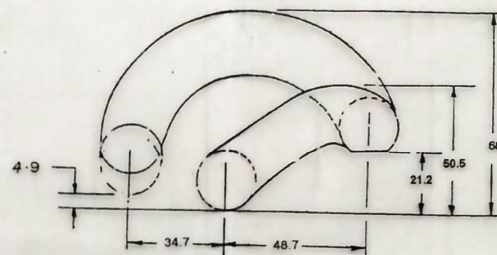

SIDE ELEVATION

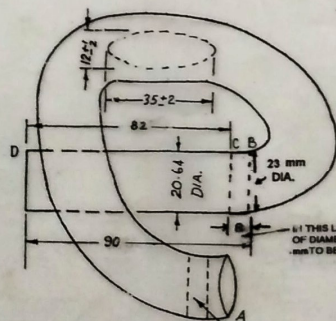

PLAN

DIAMETERS:

A-B = 23 mm

B-C = PRECISION TAPERING OF DIAMETER FROM 23 mm TO 20.64 mm TO BE DONE BY HYDRO COPYING TURNING MACHINE ETC.

C-D = UNIFORM DIA. OF 20.64 mm TO BE ACHIEVED BY TURNING USING HYDRO COPYING MACHINE.

MANUFACTURER'S INITIAL / TRADE MARK, LAST DIGIT OF THE YEAR OF MANUFACTURE AND LOT NO. ARE TO BE INSCRIBED HERE e.g. M 8 / 1

THIS LENGTH PRECISION TAPERING OF DIAMETER FROM 23 mm TO 20.64 mm TO BE DONE BY HYDRO COPYING MACHINE ETC.

4. THIS ELASTIC RAIL CLIP MK-V CAN BE USED UPTO 25 T AXLE LOAD AT MAX. SPEED

100 KMPH & FOR PASSENGER TRAFFIC UPTO FULL SECTIONAL SPEED.

3. THE DIA. OF THE FINISHED CLIP SHALL BE MEASURED AT CENTRE LEG WITH ± 0.15 mm TOLERANCE.

2. CLIP SHALL BE CHECKED WITH INSPECTION GAUGE TO DRAWING - N.O. R.D. S.O/T-5920.

1. ALL DIMENSIONS ARE IN MILLIMETRES.

NOTE

IRST-31-1992

NOT TO SCALE

SPECIFICATION

SCALE

1. NOTE ADDED

ALT: DESCRIPTION

03/11

DATE

THIS DRAWING IS THE PROPERTY OF
RESEARCH DESIGNS AND STANDARDS ORGANISATION
(MINISTRY OF RAILWAYS)
LUCKNOW-226011 INDIA
AND SHALL NOT BE USED, COPIED OR REPRODUCED IN
PART OR WHOLE WITHOUT PRIOR CONSENT IN WRITING

R. D. S. O.

**ELASTIC RAIL CLIP MK-V
WITH FLAT TOE FOR 60 kg
UIC/52 kg RAIL SECTIONS**

STP
CAN
REV. 2
ADVANCE
11-11-98
(T)
RDSO/T-5919