

F

E

D

C

B

A

F

E

D

C

B

A

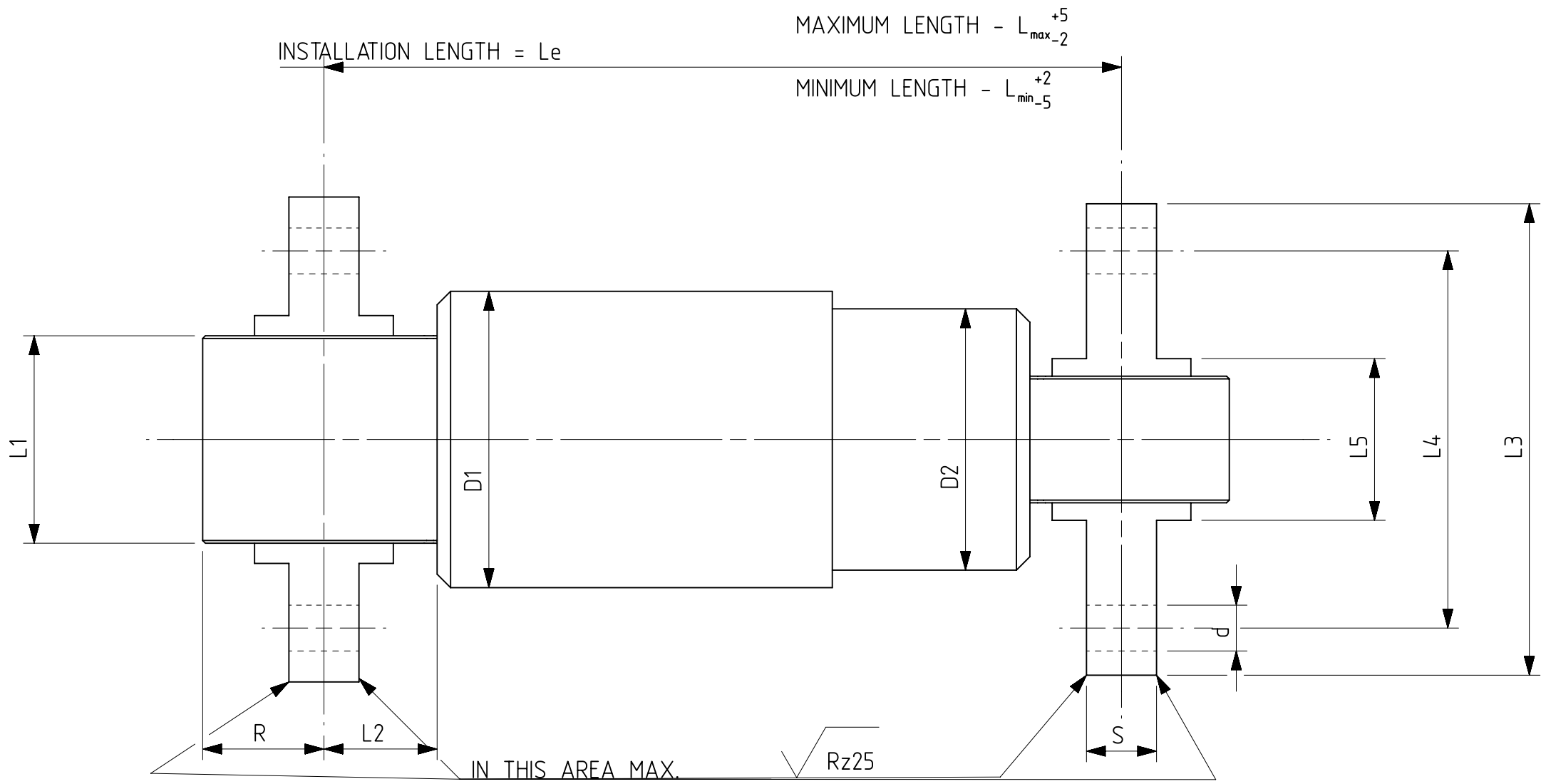

- $\alpha/2$ TWISTING ANGLE
- $\beta/2$ CARDANIC ANGLE
- θ ORIENTATION ANGLE TOWARDS HORIZONTAL LINE
- δ MOUNTING ANGLE BOLT

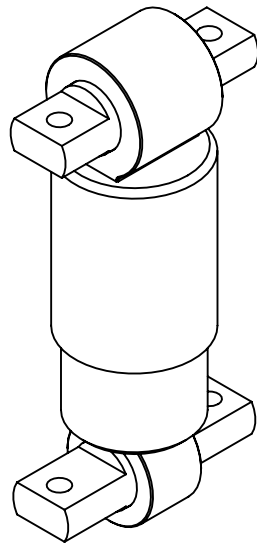
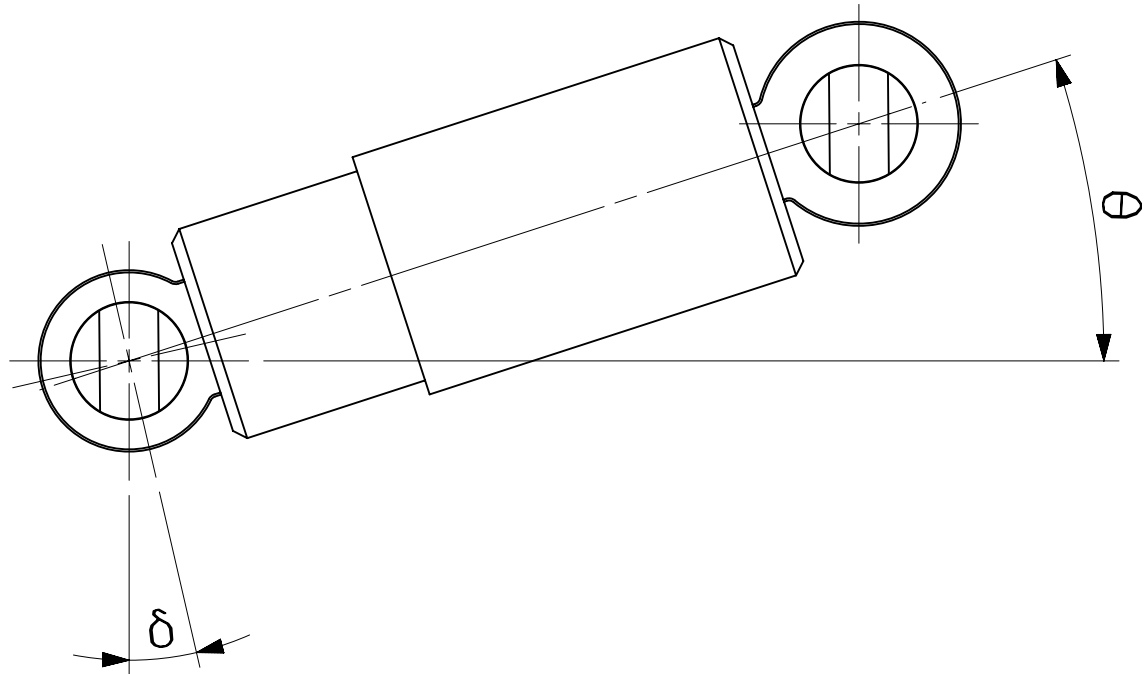

	C&D NO.	QTY./LOCO	REF. NO.	MEASURES (mm)														ANGULAR MOVEMENT (°)		MOUNTING ANGLE (°)		ARTICLE No	REMARKS	
				Le	Lmax.	Lmin.	Lstroke	Lfix	D1	D2	L1	L2	R	L3	L4	L5	S	d	$\alpha/2$	$\beta/2$	θ			δ
AXLE DAMPER	T222/012	8	1	338	386	296	90	195 206	110 102	97 89	77 47	34 42	40 45	175 180	140	92 60	26	17	10	1	72	13	1209-01.215-014-001	IR CO'CO' AND IR BO' BO' AXLE DAMPER ARE IDENTICAL. PULLING STOP FORCE MAX. 50 KN.
VERTICAL DAMPER (SECONDARY)	T222/014	4	2	430	520	370	150	197 203	110 120	97 108	50 47	40	43.5 45	175 180	140	92 60	20 26	17	15	9	90	0	1209-01.215-014-002	
HORIZONTAL DAMPER (SECONDARY)	T222/013	4	3	574	690	465	225	190 201	110 120	97 108	77 47	34 61.5	40 45	175 180	140	92 60	20 26	17	7	8	5	5	1209-01.215-014-003	
YAW DAMPER	T222/015	4	4	700	820	605	215	370	120	110	65 76	60 133	55 60	172	130	80	28	21	7	11	5	5	1209-01.215-014-004	

NOTE:-

1. THIS DRG. IS TO BE WORKED IN CONJUNCTION WITH SPECIFICATION No. CLWMS/3/009 FOR WAG-9 & WAG-9H LOCO
2. TOLERANCE ON THE DAMPING FORCE (COMPRESSION & TENSION) SHALL BE AS SPECIFIED BELOW AT DAMPER TEMPERATURES OF 16° TO 22°C
- a) NEW OR RECONDITIONED DAMPERS : ± 15%
- b) WORN DAMPERS : ± 25%
3. THIS DRAWING TO BE WORKED IN CONJUNCTION WITH SPECIFICATION NO. CLWMS/SPEC/ELDO - BOGIE /002. NOVEMBER 2013 FOR WAP-7 LOCOMOTIVES.

4. ALL DIMENSIONS ARE IN mm
5. NEXT LEVEL ASSEMBLY DRG. NO. 1209-01.115-001 REF-11,12,13,14
6. USED FOR LOCO-WAG-9,WAG-9HC&WAP-7
7. UNSPECIFIED TOLERANCE IN THE DIMENSIONS MENTIONED AT DRAWINGS TO BE FOLLOWED AS PER IS:2102(PART 1):1993-TOLERANCE CLASS-MEDIUM.

	DAMPER ADJUSTMENT									
	AXLE DAMPER		VERTICAL DAMPER (SECONDARY)		HORIZONTAL DAMPER (SECONDARY)		YAW DAMPER			
TEST SPEED (m/s)	0.10	0.30	0.10	0.30	0.10	0.30	0.01	0.02	0.05	0.10
TEST STROKE (mm)	50	50	50	50	50	50				
TEST FREQUENCY (Hz)										
DAMPING FORCE (N) (+/-)	5000	9000	11000	20000	7000	14000	3000			

धातु-वेल्डिंग चिन्ह		अतिरिचित सद्य - सीमा मा. मा. : 2102 / अ. मा. सं. : 2768												TOL. CLS.	
मा. मा. : 813 / अ. मा. सं. :2553		UNSPECIFIED TOLERANCE TO IS : 2102 / ISO : 2768													
WELDING SYMBOLS TO IS:813 / ISO:2553		पदांक	सं1	सं2	सं3	सं4	सं5	सं6	सं7	सं8	सं9	सं10	सं11	सं12	
		GRADE NO.	N1	N2	N3	N4	N5	N6	N7	N8	N9	N10	N11	N12	
		Rz	0.16-6.3	0.5-6.7	0.9-1.1	1.5-2.0	2.5-3.8	5.0-6.3	9.0-12	16-25	30-40	50-63	75-100	160-250	
		Ra μ m	0.075	0.05	0.1	0.2	0.4	0.8	1.6	3.2	6.3	12.5	25	50	
		चिन्ह													
		SYMBOL													

2	DY CEE / D-II	NOTE 3 ADDED FOR WAP-7. NOTE 1 MODIFIED. WAG-9H & WAP-7MENTIONED IN USED FOR LOCO COLUMN.	12-12-13
1	DY.CME/D&D	NOTE 2 ADDED	17-06-03
परिवर्तन संख्या	प्राधिकार	वर्णन	DESCRIPTION
ALT. NO.	AUTHY		

12-12-13	17-06-03	12-12-13	17-06-03
SCALE	1:1	SCALE	1:1
संदर्भ / REF.	IB016-00372	ALT-	2

अधिकृत DGN		चिततरंजन रेलइंजन कारखाना	
जोधा व.अ.अ. CHD SSE		CHITTARANJAN LOCOMOTIVE WORKS, INDIA	
समीक्षित स.वि.अ. / व.वि.अ. REVIEWED AEE / SEE		पदार्थ MAIL	प्रति भार कि. घा. WT. EACH IN KG
अनुमोदित चक्रवि.अ. APPROVED DYCEE		विशिष्टि SPECN	
दिनांक DATE	12-01-2023	वर्णन	DAMPERS
रैखिक अनुपात SCALE	1:1	आरेखण संख्या	1209-01.215-014
परिवर्तन संख्या	2	परिवर्तन संख्या ALTERATION NO.	2
पार्श्व	1 OF 1	पार्श्व	1 OF 1
पार्श्व	A2	पार्श्व	A2