

BRIDGE PROPPER LENGTH = 43.02 M (4 NO. BATTERY 3-CELL X 3.0 M X 3.0 M)

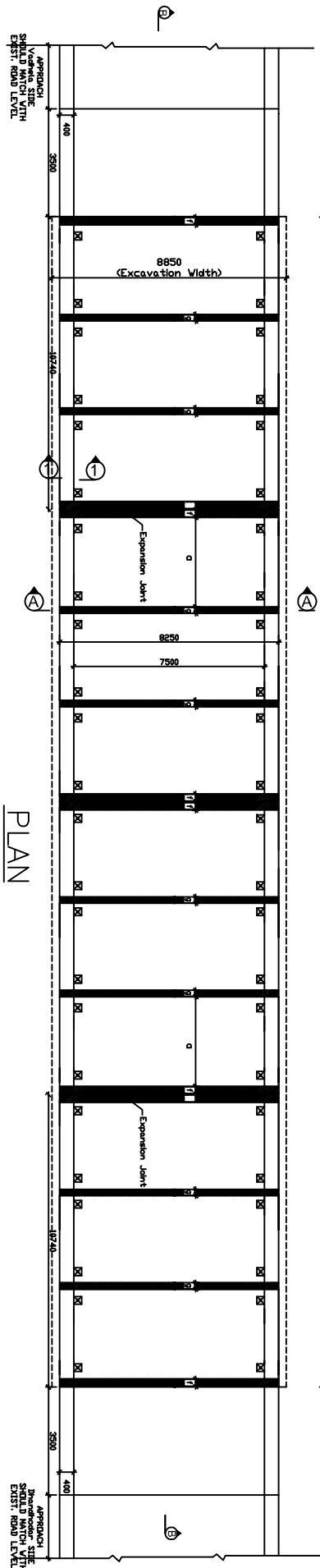

Q OF BOX STRUCTURE/SYM.

PLAN

C OF BOX STRUCTURE/SYM.

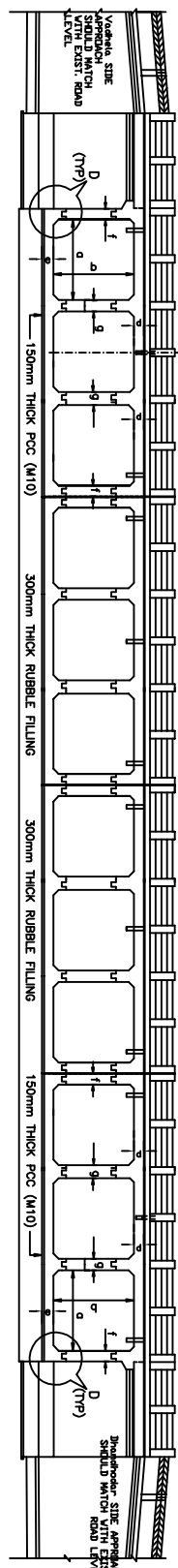

SECTION B-B

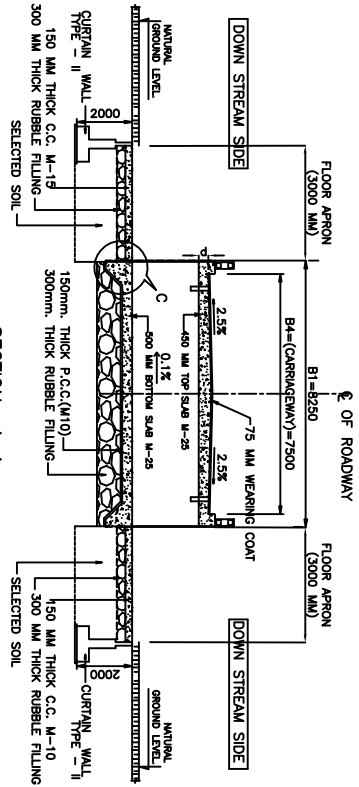

SECTION A-A

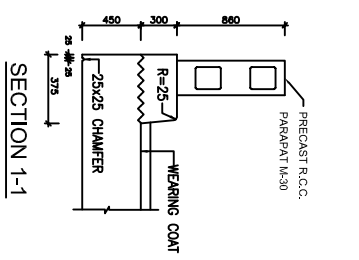

SECTION 1-1

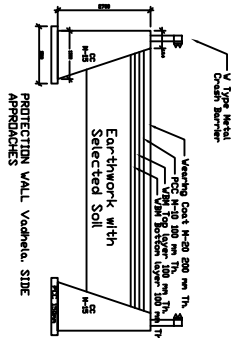

PROTECTION WALL VADHRA, SIDE

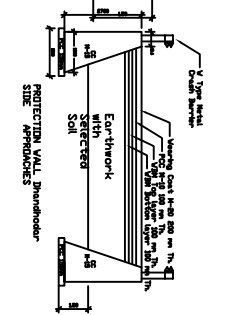

PROTECTION WALL BOUNDARY, SIDE

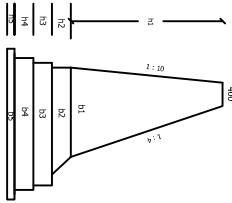

CROSS-SECTION OF RETURN

DETAIL OF REIN	
H1	1380
H2	500
H3	500
H4	500
H5	150

Particulars	Dimension
PCC Bottom	0.15 m
Bottom Slab (e)	0.50 m
Top Slab (e)	0.45 m
Outer Wall (f)	0.47 m
Inner Wall (g)	0.40 m
Cell Width (h)	3.00 m
Cell Height (i)	3.00 m
Approach Slab	3.50 m
Return - L	3.50 m
End offset (c)	0.30
No. of Spans	120
Expansion Joint	3.0

GOVERNMENT OF GUJARAT	
ROADS & BUILDINGS DEPARTMENT	
DATE	10/07/2020
PROJECT	Box Cell Culvert 4 No. 3 Cell X 3.0mt X 3.0mt
LOCATION	Changa 0/700 km
DESIGNED BY	SRINIVAS RAO
CHECKED BY	SRINIVAS RAO
THICKED BY	SRINIVAS RAO
APPROVED BY	SRINIVAS RAO
DATE	10/07/2020
PROJECT	Box Cell Culvert 4 No. 3 Cell X 3.0mt X 3.0mt
LOCATION	Changa 0/700 km
DESIGNED BY	SRINIVAS RAO
CHECKED BY	SRINIVAS RAO
THICKED BY	SRINIVAS RAO
APPROVED BY	SRINIVAS RAO