

ZILA PARISHAD MADHEPURA

BILL OF QUANTITY (BOQ)

PROPOSED COMMERCIAL BUILDING AT BUS STAND, MADHEPURA (BIHAR)

SOR-Ref BCD 2022.	Item of Works	Quantity	Unit	Rate	Amount
	CIVIL WORK				
	EARTH WORK				
	Site clearance do all comp job				60,000.00
2.8	Earth work in excavation in foundation trenches or drains(not exceeding 1.5 m in width or 10 sqm on plan) including dressing of sides and ramming of bottoms, lift upto 1.5 m . including getting out the excavated soil and disposal of				
2.8.1	All kinds of soil.				
	Foundation				
	F1	400.950	cum		
	Grade Beam				
		30.108	cum		
		431.058	cum		
	Total Qty :	431.058	cum	360.70	1,55,482.76
2.21	Earthfilling				
	Room	42.582	cum		
	stair room	2.427	cum		
	Verandaha	24.886	cum		
		69.895	cum	386.60	27,021.24
2.28	Supplying and Filling in plinth with local sand and under floors including, watering, ramming consolidating and dressing complete.				
	Foundation	44.55	cum		

Nish Kumar

Hea

ZILA PARISHAD MADHEPURA

BILL OF QUANTITY (BOQ)

PROPOSED COMMERCIAL BUILDING AT BUS STAND, MADHEPURA (BIHAR)

SOR-Ref BCD 2022.	Item of Works	Quantity	Unit	Rate	Amount
	Grade Beam	5.02	cum		
	UNDER floor (along length)	229.369	cum		
	along width	179.320	cum		
	paver ground	48.84	cum		
	outer stair	7.45	cum		
	514.56	cum			
	Total Qty :	514.56	cum	287.30	147831.67
11.72	Providing designation 100 A one brick flat soling joints filled with local sand including cost of watering, taxes, royalty all complete as per				
	Foundation				
		178.200	sqm		
	Grade Beam	66.908	sqm		
	UNDER floor (along length)	229.369	sqm		
	along width	179.320	sqm		
	outer stair	49.692	sqm		
	Total Qty :	703.49	sqm	283.30	1,99,298.29
	CEMENT CONCRETE WORK & REINFORCED CEMENT CONCRETE WORK				
	Providing and laying in position cement concrete of specified grade excludng the cost of centring and shuttering-all work upto plinth level.				
4.1.3	1:2:4(1 Cement: 2 coarse sand: 4 graded stone aggregate 20 mm nominal size) m15				

Mitha Kumar

Bey

ZILA PARISHAD MADHEPURA

BILL OF QUANTITY (BOQ)

PROPOSED COMMERCIAL BUILDING AT BUS STAND, MADHEPURA (BIHAR)

SOR-Ref BCD 2022.	Item of Works	Quantity	Unit	Rate	Amount
	Foundation	22.275	cum		
	UNDER floor (along length)	34.405	cum		
	along width	26.898	cum		
	outer stair	7.454	cum		
		91.03	cum		
	Total Qty :	91.03	cum	3998.10	3,63,955.64
	PLINTH PROTECTION				
	Making plinth protection 50 mm thick of cement concrete 1:3:6 (1 cement :3 coarse sand : 6 graded stone aggregate 20 mm nominal size) over 75 mm thick bed of dry brick ballast 40 mm nominal size, well rammed and				
4.17	GR. FLOOR				
	building perimeter	91.80	sqm		
	TOTAL	91.80	sqm		
	Total Qty :	91.80	sqm	436.600	40,080.00
4.11	Providing and laying damp-proof Course 50 mm thick with cement concrete 1:2:4 (1 cement :2:2 coarse sand :4				
	DPC				
	Grade Beam	66.91	sqm		
		66.91	sqm		
	Total Qty :	66.91	sqm	245.60	16,432
5.1	Providing and laying in position specified grade of reinforced cement concrete excluding the cost of centring, shuttering, finishing and reinforcement-All work up to plinth level.				
5.1.1	1:1:2 (1 cement: 1 coarse sand:2 graded stone aggregate 20 mm nominal size) M25				
	Foundation				

Nish Kumar



ZILA PARISHAD MADHEPURA

BILL OF QUANTITY (BOQ)

PROPOSED COMMERCIAL BUILDING AT BUS STAND, MADHEPURA (BIHAR)

SOR-Ref BCD 2022.	Item of Works	Quantity	Unit	Rate	Amount
	FT-1	106.920	cum		
		106.920	cum	5961.90	6,37,446.35
5.2	Reinforced cement concrete work in wall (any thickness), including attached pilasters, buttresses, plinth and string courses, fillets, columns, pillars, piers, abutments, posts and struts, etc. up to floor five level excluding cost of centring, shuttering, finishin and reinforcement.				
5.2.1	1:1.2(1 cement: 1 coarse sand:2 graded stone aggregate 20 mm nominal size)				
	column	30.938	cum		
	mummy room column extend	0.900	cum		
		31.838	cum		
	Total Qty	31.838	cum	6943.50	2,21,064.00
5.3+5.33B.4	Reinforced cement concrete work in beams,suspended floors, roofs having slope upto 15, landings,balconies, shelves, chajjas, lintels, bands, plain window sills, staircases and spiral stair cases up to floor five level excludingthe cost of centring, shuttering,				
	GROUND FLOOR ROOF BEAM				
	Grade Beam	30.108	cum		
	Lintel Beam	16.727	cum		
	slab Beam	30.108	cum		
	Plinth Band	6.691	cum		
	slab	31.775	cum		
		12.718	cum		
	STAIR (waist slab)	2.262	cum		
	mummy room slab	2.331	cum		
		132.719	cum		
	Total Qty	132.719	cum	5884.20	7,80,946.00

Nishik Kumar



ZILA PARISHAD MADHEPURA

BILL OF QUANTITY (BOQ)

PROPOSED COMMERCIAL BUILDING AT BUS STAND, MADHEPURA (BIHAR)

SOR-Ref BCD 2022.	Item of Works	Quantity	Unit	Rate	Amount
5.22	Reinforcement for R.C.C. work including straightening, cutting, bending, placing in position and binding all complete.				
	RCC Work	12 MM	8MM		
		20%	25%		
	Up to plinth	2459.200	3074		
		15%	15%		
	Above plinth	2468.400	2468.4		
		4927.60	5542.40		
		20MM			
		10%			
		1229.6			
		15%			
		2468.4			
		3698.00			
5.22.7A	TMT 8 mm dia	5542	kg	94.50	5,23,757.00
5.22.7B	TMT 10 mm dia	6573	kg	92.60	6,08,678.00
5.22.7C	TMT 12 mm dia	4928	kg	90.80	4,47,426.00
5.22.7D	TMT 16 mm dia	8011	kg	91.70	7,34,590.00
5.22.7E	TMT 20mm dia	3698	kg	91.70	3,39,107.00
	Centering and Shuttering				
5.9	Centering and shuttering including strutting, propping etc. and removal of form for.				
5.9.1	Foundations, footings, bases of columns etc. for FT-1	237.600			
		237.600	sqm		
	Total Qty. :	237.600	sqm	211.60	50,276.00

Nitin Kumar

887

ZILA PARISHAD MADHEPURA

BILL OF QUANTITY (BOQ)

PROPOSED COMMERCIAL BUILDING AT BUS STAND, MADHEPURA (BIHAR)

SOR-Ref BCD 2022.	Item of Works	Quantity	Unit	Rate	Amount
5.9.3	Centring and shuttering including strutting, propping etc. and removal of form for, Suspended floors, roofs, landings, balconies and access platform.				
	slab	254.198	sqm		
		101.7406	sqm		
	STAIR (waist slab)	12.566	sqm		
	mummy room slab	18.6448	sqm		
		387.149	sqm		
	Total Qty. :	387.149	sqm	437.50	1,69,378.00
5.9.5	Centring and shuttering including strutting, propping etc. and removal of form for, Lintels, beams, plinth beams, girders, bressumers and cantilevers.				
	Grade Beam	240.867			
	Lintel Beam	133.815			
	slab Beam	307.7745			
	Plinth Band	53.526			
		735.983	sqm		
	Total Qty. :	735.983	sqm	404.70	2,97,852.00
5.9.6	Centring and shuttering including strutting, propping etc. and removal of form for, Columns, Piers, Abutments, Posts and Struts				
	column	385.000	sqm		
	mummy room column extend	11.200	sqm		
		396.200	sqm		
	Total Qty. :	396.200	sqm	494.40	1,95,881.00

Nishik Kumar



ZILA PARISHAD MADHEPURA

BILL OF QUANTITY (BOQ)

PROPOSED COMMERCIAL BUILDING AT BUS STAND, MADHEPURA (BIHAR)

SOR-Ref BCD 2022.	Item of Works	Quantity	Unit	Rate	Amount
5.9.7	Centring and shuttering including strutting, propping etc. and removal of form for Stairs, (excluding landings) except spiral-staircases.				
	ground floor stair-1				
	landing	2.928	sqm		
	waist slab	8.700	sqm		
	steps (riser)	8.280	sqm		
		19.908	sqm		
	Total Qty. :	19.908	sqm	439.90	8,758.00
6.1A	Brick work with bricks of class designation 100A in foundations and plinth in(Fly Ash) :				
6.1.14C+6.3C	Cement mortar 1:6 (1 cement: 6 coarse sand)				
		21.573	cum		
		9.875	cum		
6.1.14C+6.3C	Cement mortar 1:6 (1 cement: 6 coarse sand) aboveplinth level upto floor v				
		60.602	cum		
		73.365	cum		
	Deduction for rolling sutter	-21.712	cum		
		143.703	cum	5765.20	8,28,474.01

Nishu Kumar



ZILA PARISHAD MADHEPURA

BILL OF QUANTITY (BOQ)

PROPOSED COMMERCIAL BUILDING AT BUS STAND, MADHEPURA (BIHAR)

SOR-Ref BCD 2022.	Item of Works	Quantity	Unit	Rate	Amount
10.6.1	Supplying and fixing-rolling shutters of approved make, made of required size of M.S. laths inter locked together through their intire length and jointed together at the end by end locks mounted on specially designed pipe shaft with brackets, side guides and arrangements for inside and outside locking with push and pull operation complete including the cost of providing and fixing necessary 27.5 cm long wire springs grade no. 2 and M.S. top cover of required thickness for rolling shutters.				
10.6.3	80X0.90 mm thick M.S. laths with 0.90 mm thick top cover.				
	GROUND FLOOR				
	Shutter(RS)	173.698	sqm	2673.70	4,64,415.01
10.7	Providing and fixing ball bearing for rolling shutters				
	GROUND FLOOR				
	Shutter(RS)	173.698	sqm	424.20	73,682.48
	PLASTER WORK				
13.11	12 mm cement plaster				
13.11.4	1:4 (1 cement : 4 coarse sand)				
	Exterior wall	163.800	sqm		
		175.384	sqm		
	interior	109.746	sqm		
		133.531	sqm		
	deduct for door area	-173.698	sqm		
		408.764	sqm	152.90	62,499.94

Nitesh Kumar



ZILA PARISHAD MADHEPURA

BILL OF QUANTITY (BOQ)

PROPOSED COMMERCIAL BUILDING AT BUS STAND, MADHEPURA (BIHAR)

SOR-Ref BCD 2022.	Item of Works	Quantity	Unit	Rate	Amount
	6 mm cement plaster ceiling				
	1:4(1 cement :4 coarse sand)				
	slab	201.4974	sqm		
		175.8904	sqm		
		377.388	sqm	125.60	47,399.91
	FINISHING WORK				
	Providing and applying white cement based putty of average thickness 2 mm, of approved brand and manufacturer, over the plastered wall surface to prepare the surface even and smooth complete.				
13.80A.2					
		786.151	sqm	105.40	82,860.35
13.48	Finishing with Deluxe Multi surface paint system for interiors and exteriors using Primer as per manufacturers specifications.				
13.48.1	Two or more coats applied on walls @ 1.25 ltr/10 sqm over and including one coat of special primer applied @ 0.75 ltr /10 sqm.				
	From (13.80A.2)	786.151	sqm	117.30	92,215.55
13.82.1	Painting with ready mixed paint of approved brand and manufacture in all shades to give an even shade.New steel work (two or more coats)				
	rolling shutter	173.698	sqm		
		173.698	sqm	83.50	14,503.74

Nishik Kumar



ZILA PARISHAD MADHEPURA

BILL OF QUANTITY (BOQ)

PROPOSED COMMERCIAL BUILDING AT BUS STAND, MADHEPURA (BIHAR)

SOR-Ref BCD 2022.	Item of Works	Quantity	Unit	Rate	Amount
11.41	Providing and laying vitrified floor tiles in different sizes (thickness to be specified by the manufacturer) with water absorption's less than 0.08 % and conforming to IS : 15622 of approved make in all colours and shades, laid on 20 mm thick cement mortar 1:4 (1 cement: 4 coarse sand) including grouting the joint with white cement and matching pigments etc., complete.				
11.41.2	Size of Tile 60x60 cm				
	Ground Floor				
	shop	189.253	sqm		
		189.253	sqm		
	Total Qty:-	189.253	sqm	1638.80	3,10,147.00
11.79.1	Providing designation M35 grade 80mm thick c.c paver block do.. All complete with approved colour design and pattern				
		0.000	sqm	956.40	0.00
				TOTAL(A)	80,01,458.93
Calculation for material Statement					
	Item	Sand cum	Brick nos	L.Sand cum	steel
	Paver Block		0		
	Local sand filling			514.56	
	B/W250 mm 1:6	38.44	70,989.00		
	B/W125 mm1:4	-	-		
	PCC 1:2:4	40.51			
	RCC M 25	-			28,752.00
	Brick Flat Soling		22,695.00	10.59	

Nishik Kumar

Beti

ZILA PARISHAD MADHEPURA

BILL OF QUANTITY (BOQ)

PROPOSED COMMERCIAL BUILDING AT BUS STAND, MADHEPURA (BIHAR)

SOR-Ref BCD 2022.	Item of Works	Quantity	Unit	Rate	Amount
	Stone/Tile Floor	-			
	20 mm plaster 1:4	4.91			
	12 mm plaster 1:4	2.26			
	6 mm plaster 1:4	-			
	cement punning	86.12	93,684.00	525.14	28,752.00
					28.75
	Carriage of Materials				
	Bricks+ Paver (7+1 km)	93.684	Th.	886.60	83,060.00
	Stone Chips	81.019	cum	2716.91	2,20,120.00
	Coarse Sand	86.119	cum	2614.28	2,25,140.00
	Local Sand (2P+1K)	525.143	cum	264.41	1,38,853.00
	Cement(3P)	40.300	MT	126.38	5,093.00
	Steel (3P)	28.752	MT	126.38	3,634.00
	Extra cost of Material for Sharsa w.r.t Gaya				
	Cement	806.000	per bag	8.93	7198.00
	Brick	93.684	Th.	468.95	43933.00
				SUM (B)	727031.00
				Total (A+B)	87,28,489.93
	Multiplying factor 1.0536 for 18% GST (instead of 12% GST as per BCD Analysis			SUB TOTAL (C)	91,96,336.99

Nikhil Kumar

[Signature]

ZILA PARISHAD MADHEPURA

BILL OF QUANTITY (BOQ)

PROPOSED COMMERCIAL BUILDING AT BUS STAND, MADHEPURA (BIHAR)

SOR-Ref BCD 2022.	Item of Works	Quantity	Unit	Rate	Amount
	Add seigniorage Charge				
	Bricks	95.801	Th.	526.70	50,458.00
	Stone Chips 20 mm	81.019	cum	59.54	4,824.00
	Coarse Sand	86.119	cum	17.58	1,514.00
	Local Sand	525.143	cum	14.19	7,452.00
			Total (D)		64,248.00
			TOTAL (C+D)		92,60,584.99
	Add Cost for Electrification (annexure attached)				7,19,897.00
	Add signboard @ 2nos				10,000.00
			Sum(E)		7,29,897.00
			SUM(C+D+E)		99,90,481.99
			SAV(Rs.)		99,90,500.00

Nish Kumar

J.E

J.E

BOQ Approved for Rupees 99,90,500.00 (Ninty Nine Lakh Ninty thousand five hundred only.

सहायक अभियंता
जिला परिषद, मधेपुरा

15/03/2024

ZILA PARISHAD OFFICE, MADHEPURA, BIHAR.

BILL OF QUANTITY OF ELECTRICAL WORK

INTERNAL ELECTRIFICATION OF COMMERCIAL BUILDING AT BUS STAND, MADHEPURA

Rates are based on SOR 2023 (w.e.f. 01.09.2023) for Electrical Works

Cost of B.O.Q. (In Rs.) :- **719897.00**

Completion Period :-

Sr. No.	SOR No.	ITEM OF WORK	UNIT	QUANTITY	RATE (In Rs.)	AMOUNT (In Rs.)
---------	---------	--------------	------	----------	------------------	--------------------

WIRING

1	S.O.R 1.3.3 (C)	Wiring for light point / fan point / exhaust fan point / call bell point with 1.5 sq.mm FR PVC insulated copper conductor single core cable in surface recessed medium class PVC conduit with modular switch, modular plate, suitable CI box and earthing the point with 1.5 sq. min. FR PVC insulated copper conductor single core cable etc as required. Group C	Point	150.00	1146.00	171900.00
2	SOR 1.24.1 1.24.4	Supplying and fixing 5 pin, 5/6 amps socket outlet and 5/6 amps Modular type switch connection etc up-on switch board, as required all complete as per instructions of Elec.Er. / Architect.	Set	15.00	194.00	2910.00
3	SOR 1.31	Supplying and fixing 1nos Modular type 6Amp 5pin socket with 6Amps switch, Modular Plate, suitable size PVC/G.I. box as required. all complete as per instructions of Elec.Er. / Architect.	Each	18.00	414.00	7452.00
4	SOR 1.32	Supplying and fixing 1nos Modular type 15Amp 6 pin socket with 15Amps switch, Modular Plate, suitable size PVC/G.I. box as required. all complete as per instructions of Elec.Er. / Architect.	Each	18.00	531.00	9558.00

With /una

Sr. No.	SOR No.	ITEM OF WORK	UNIT	QUANTITY	RATE (In Rs.)	AMOUNT (In Rs.)
5	SOR 2.19	Supplying and fixing 20Amp 240 volts SPN MCB industrial type, power socket with 25Amp SPN MCB and 25 Amps Top in proper size steel box and plate as required. all complete as per instructions of Elec.Er. / Architect.	Each	10.00	1513.00	15130.00
6	SOR 2.32	Supplying and fixing Cable end box (Loose wire box, IP43) suitable for following pole and neutral, sheet steel, MCB distribution board, 2401415 V, on surface /recess complete with testing and commissioning etc. as required.	Each	12.00	798.00	9576.00
7	SOR 2.12	Supplying and fixing following rating, 24A/4L5 volts, "C" curve, miniature circuit breaker suitable for inductive loads of following poles in the existing MCB DB complete with connections, testing and commissioning etc. as required	Each	50.00	237.00	11850.00
i	2.12.L	6 A to 32'A, Single pole	Each	12.00	606.00	7272.00
ii	2.12.2	6 A to 32 A, SP&N	Each	1.00	551.00	551.00
iii	2.12.5	40 A to 63 A, Single pole	Each	12.00	2131.00	25572.00
8	SOR 2.17.1	Supplying and fixing 25A rating, double pole, (single phase and neutral), 240 volts, residual current circuit breaker (RCCB), having a sensitivity current upto 300 milliamperes in the existing MCB DB complete with connections, testing and commissioning etc. as required.	Each	10.00	064.00	640.00
9	SOR 1.33	Supplying and fixing ceiling rose 2 pin 6amps on existing junction box/ wooden block including connection etc. as required.	Each	12.00	089.00	1068.00
10	SOR 1.34	Supplying and fixing brass/ angle holder on existing junction box/ wooden block including connection etc. as required.	Each	12.00	311.00	3732.00
11	SOR 1.23.9	Supplying and fixing stepped type electronic fan regulator on the existing modular plate/ switch box including connections but excluding modular plate etc. as required.	Each	50.00	327.00	16350.00
12	SOR 1.7	Wiring for circuit/ submain wiring alongwith earth wire with the following sizes of FR PVC insulated copper conductor, single core cable in surface/ recessed medium class PVC conduit as required.	Metre	50.00	369.00	18450.00
i	1.7.1	2x1.5 sq. Mm + 1x1.5 sq. Mm earth wire	Metre	80.00	428.00	34240.00
ii	1.7.2	2x2.5 sq. Mm + 1x2.5 sq. Mm earth wire	Metre	150.00	589.00	88350.00
iii	1.7.3	2x4sq. Mm + 1x4 sq. Mm earth wire	Metre			
iv	1.7.4	2x6sq. Mm + 1x6 sq. Mm earth wire	Metre			

Nish Kumar

Sl. No.	SOR No.	ITEM OF WORK	UNIT	QUANTITY	RATE (In Rs.)	AMOUNT (In Rs.)
		L.T LINE CANTROL PANEL-125A TPN				
13	SOR 2.5.4	Providing and fixing 300amps capacity busbar chamber with 4 strips of suitable size made of copper, heavy duty, complete with all accessories including connections, earthing the body etc. as required.	Each	1.00	12883.00	12883.00
14	SOR 2.4.5	Providing and fixing 250A, rating and 36 ka. breaking capacity MCCB (TPN) in made of existing 1.6mm thick sheet steel enclosure duly painted with powder coating, wall straps cubicle panel board including drilling holes in cubicle panel, making connections, etc. as required	Each	1.00	18646.00	18646.00
15	SOR 2.7.7	Providing and fixing 250A capacity four pole ON-load panel mounted changeover switches inside the existing cubical panel board including drilling holes in cubicle panel, making connections etc. as required.	Each	1.00	21415.00	21415.00
16	SOR 2.12.2	Supplying and fixing 32A rating, 220 volts, SPN "C" curve, miniature circuit breaker suitable for inductive loads of two poles in the existing panel complete with connections, testing and commissioning etc. as required.	Each	18.00	606.00	10908.00
17	SOR 8.10.4	Supply and fixing digital voltmeter, three phase in the existing cubical panel board including drilling holes in the panel board, making connection etc as required.	Each	1.00	1337.00	1337.00
18	SOR 8.13	Supply and fixing panel mounted digital multimeter (Voltmeter & ammeter) including CT coil and RYB pilot indicator in the existing cubical panel board including drilling holes in the panel board making connections etc as required.	Each	1.00	6536.00	6536.00
19	SOR 2319	Providing and fixing selector switch for analog ammeter as per require load in amps on front side in excluding cubical panel as required.	Each	2.00	298.00	596.00
20	SOR 2318	Providing and fixing Pilot lamp for indicator on front side in excluding cubical panel as required.	Each	3.00	91.00	273.00

Nisha Kumar

Sr. No.	SOR No.	ITEM OF WORK	UNIT	QUANTITY	RATE (In Rs.)	AMOUNT (In Rs.)
21	SOR 2.20	Providing and fixing M.V. danger notice plate of 200mmx150mm made of mild steel at least 2mm thick, vitreous enameled white on both side and with inscription in singale red colour on front side in excluding cubical panel as required.	Each	1.00	0,214.00	214.00
22	SOR 2.20	Providing and fixing wall mounting iron sheet cubical panel board, fabricated with 16 SWG gauge Iron sheet, suitable size for panel mounted disconnecter, including, busbar charner, insulator, nut-bolt and painting etc. as per require. size made 5'0"x4'-0"x12"=20 SQ. FT. X 1No.	SQ. FT	10.00	2,261.00	22610.00
23	S.O.R 3.13	SUPPLY & MAKING OF EARTHPIITS Providing chemical/mineral maintenance free earthing system comprising of copper coated earth electrode 3 metre length and 17.2 mm outer dia along with 25 kg earth conductivity enhancing back fill mineral compound for earth inspection pit etc. as required. OR Supply, Fixing & Hole cutting in earth as per drawing of (CU) (600mm X 300mm X 3mm) plate electrode earth, all complete as per specifications and drawings attached.(1No. EARTH for UPS Main nutral only.) -The rate shall be inclusive of submission of TEST REPORT (2 Ohm) of each earth pit. -Coution Note -The rate shall be inclusive of submission of TEST REPORT (2 Ohm) of each earth pitand TESTING shall be carried out in front of Officials / Consultant.	Each	2.00	16675.00	33350.00
24	SOR 3.17	Supplying and fixing 4.00 mm dia copper wire on surface or in recess for loop earthing etc. as required.		33.00	144.00	4752.00
25	8.15 SOR	SUPPLY OF FIXTURES & FANS Supply and installation of regular/standard model A.C. ceiling fan of 1200 mm sweep with service value (CM/MM) minimum 4.00, Air delivery minimum 270 cum/min including wiring the down rods of standard length (upto 30 cm) with 1.5 sq. mm FRLS PVC insulated copper conductor etc as required.	Each	18.00	2482.00	44676.00

Nish Kumar

Sr. No.	SOR No.	ITEM OF WORK	UNIT	QUANTITY	RATE (In Rs.)	AMOUNT (In Rs.)
26	6.1.4 SOR	Supplying and fixing of 9/10 watt LED lamp types lamp in the existing electrical fitting/ fixtures etc. as required	Each	18.00	3670.00	66060.00
		SUPPLY & LAYING MAIN & SUBMAIN OF CABLE				
27	SOR 7.7	Supply of following sizes and core PVC/XLPE insulated, PVC sheathed (heavy duty) armoured electrical power cable with aluminium conductor for working voltage upto 1.1 KV as required.				
	7.7.11	95 sq. mm, 3.5 core	Metre	40.00	950.00	38000.00
28	SOR 7.1	Laying of one number PVC insulated and pvc sheathed / XLPE power cable of 1.1 KV grade of following size direct in ground including excavation, sand cushioning, protective covering and refilling the trench etc. as required.				
	7.1.2	Above 35 sq. mm and upto 95 sq. mm	Metre	40.00	326.00	13040.00
				Total (A) =		719897.00

Nishik Kumar

J.E

कार्यालय, जिला परिषद, मधेपुरा

-: आदेश :-

पष्टम राज्य वित्त आयोग (Gen./Dev./Maint.) मद योजना अन्तर्गत निम्नांकित योजना की प्रशासनिक स्वीकृति प्रदत्त करते हुए कनीय अभियंता, जिला अभियंता, जिला परिषद, मधेपुरा को नियुक्त करते हुए कार्यदेश निर्गत किया जाता है। यह कार्य BCD SOR 2022 के आधार पर अभियंता, जिला परिषद, मधेपुरा के द्वारा स्थल जाँचोपरांत तैयार किया गया है। जिस पर सहायक अभियंता का स्थल प्रवेक्षण, हरताक्षर तथा जिला योजना का क्रियान्वयन निम्न प्रकार है :-

क्र०	योजना सं०/वर्ष	प्रखण्ड का नाम	योजना का नाम	योजना का प्रकार	योजना का मद/ Activity Code	तकनीकी स्वीकृति की राशि	प्रशासनिक स्वीकृति की राशि	कार्य सं० की तिथि
1.	115 2025-26	मधेपुरा	जिला मुख्यालय अवस्थित विघटित (बंद) बस पड़ाव की भूमि पर दक्षिण दिशा में कुल 17 दुकान (10x12 फीट) का निर्माण कार्य।	17 दुकान (10x12 फीट) का निर्माण कार्य।	Dev. F/Tied 246270	9990500/-	9900000/-	15.09.26

- जिला अभियंता, जिला परिषद, मधेपुरा को निदेश दिया जाता है कि उपर अंकित योजनाओं में निर्गत आदेश के आलोक में निर्धारित तिथि के अवधि में योजनाओं को अनिवार्य रूप से पूर्ण कराते हुए किये गये कार्य का उप० प्रमाण-पत्र समर्पित करना सुनिश्चित करें।
- उपर्युक्त योजना में तकनीकी स्वीकृति के अनुरूप प्रशासनिक स्वीकृति विभागीय संकल्प सं०-9862 दिनांक:14.10.2022 के आलोक में प्रदान की जाती है।
- योजना का कार्य E-Tender/निविदा के माध्यम से विधिवत, नियमानुकूल सगरत अद्यतन तकनीकी नियमों का अनुपालन प्रक्रिया के माध्यम से करायी जाय।
- योजना में किसी विघौलिया/ ठिकेदार को नहीं लगायेंगे।
- योजना की राशि का उपयोग किसी अन्य मद में नहीं करेंगे।
- यह भी सुनिश्चित करें कि योजना का कार्य विगत 05 वर्ष में आंशिक या पूर्णतः किसी अन्य मद का एजेंसी द्वारा नहीं किया गया है एवं योजना का कार्य पष्टम राज्य वित्त आयोग विभागीय मार्ग-दर्शिका के अनुरूप विधिवत करायेगे।
- योजना स्थल पर कार्य के पूर्व सूचना पट्ट लगाना सुनिश्चित किया जाय तथा कार्य प्रारंभ से पूर्व भूमि का जियो टैग योजना पोर्टल पर अनिवार्य रूप से कर दिया जाय।
- योजनाओं की फोटोग्राफी एवं विडियोग्राफी का कार्य आरम्भ, मध्य एवं कार्य समाप्ति के बाद अवश्य करा ली जाय एवं कनीय अभियंता एवं सहायक अभियंता का भी कार्य के दौरान का फोटोग्राफी अवश्य रूप से अधियाचना में दी जाय।
- योजना से संबंधित अभिलेख को लौटाते हुए निदेश दिया जाता है कि पष्टम राज्य वित्त आयोग (Gen./Dev./Maint.) मद योजना अन्तर्गत निर्गत मार्ग-दर्शिका यथा- विभागीय राज्यादेश सं०- 58(स्वी०) दिनांक 11.03.2022 एवं विभागीय पत्रांक 2939, दिनांक 23.09.2022 के आलोक में योजना कार्यान्वयन कराना सुनिश्चित किया जाय।
- योजना का कार्यान्वयन विभागीय आदेश संख्या 87 दिनांक-25.03.2022 के निदेश के आलोक में कराना सुनिश्चित करेंगे।
- निर्माण के क्रम में पूर्व से निर्मित योजना में अगर सामान की प्राप्ति होती है तो उसे सूचीबद्ध कर अभियंत्रण कार्यालय में हस्तगत कराना सुनिश्चित करेंगे।
- किये गये कार्य का प्रमाण-पत्र, एम०वी० प्रति के साथ कार्यालय को ससमय उपलब्ध कराना सुनिश्चित करेंगे।
- संबंधित कनीय अभियंता योजना का मापीपुस्त में सभी प्रकार के कर सॉल्टि, सेलटेक्स, लेबर सेस एवं स्वामित्व कर (अद्यतन GST कर) की कटौती का गणना कर योजनावार संबंधित शीर्ष में कनीय अभियंता (तकनीकी सहायक)/ स०अभि० (अभिकर्ता) के द्वारा ससमय उक्त राशि विधिवत संबंधित शीर्ष में जमा कराना सुनिश्चित करेंगे। किसी भी परिस्थिति में कर की राशि ससमय जमा नहीं होने पर उक्त कनीय अभियंता दोषी होंगे। पूनः उन्हें उक्त योजना में अगले किस्त का भुगतान नहीं किया जायेगा, इसलिए अनिवार्य/ सर्वोच्च प्राथमिकता के तौर पर किये गये कार्य का जिसका राशि कार्यालय के द्वारा विमुक्त किया जा चुका है 15 दिनों के अन्दर में राशि संबंधित शीर्ष में जमा करना सुनिश्चित करेंगे, जिसकी प्रति द्वितीय अधियाचना में अवश्य संलग्न करेंगे।
- जिला अभियंता, जिला परिषद, मधेपुरा को निदेश दिया जाता है कि पूर्व की शत-प्रतिशत व्यय नहीं किया गया है, जिसके फलस्वरूप अभियंत्रण कार्यालय में राशि संचित है इसलिए इस मद की योजना में प्रथम मापी विपत्र प्राप्त होने पर ही राशि विमुक्त किया जायेगा।
- कार्य तय समय सीमा के अंदर करवाना सुनिश्चित करेंगे। अन्यथा इसके लिए संबंधित कनीय अभियंता जिम्मेवार होंगे तथा संवेदक से नियमानुकूल पेलेन्टी की राशि वसूल की जायेगी।

अपर मुख्य कार्यपालक पदाधिकारी,
जिला परिषद, मधेपुरा।

मुख्य कार्यपालक पदाधिकारी,
जिला परिषद, मधेपुरा।

आपांक. 168.../दिनांक. 20/09/26

प्रतिलिपि :-
 प्रतिलिपि :- रोकड़पाल, जिला परिषद, मधेपुरा को सूचनार्थ एवं आवश्यक कार्यार्थ प्रेषित।
 प्रतिलिपि :- जिला अभियंता/ सहायक अभियंता/ कनीय अभियंता, जिला परिषद, मधेपुरा को सूचनार्थ प्रेषित।
 प्रतिलिपि :- अध्यक्ष, जिला परिषद को सूचनार्थ समर्पित।
 प्रतिलिपि :- जिला पदाधिकारी, मधेपुरा को सादर सूचनार्थ समर्पित।

अपर मुख्य कार्यपालक पदाधिकारी,
जिला परिषद, मधेपुरा।

मुख्य कार्यपालक पदाधिकारी,
जिला परिषद, मधेपुरा।

मद :- 6th S.F. (Hd. F.)

कार्यक्रम जिला परिषद मधेपुरा

योजना का नाम :- जिला मुख्यालय अवीलान विधिस (पं.) बसपड़ा की खासी भूमि पर क्षीण स्थिति में

कुल - 17 दुकान (10x12 फीट) का निर्माण कर दिया।

प्रयोज्य रकम - 39,90,500/-

रजिस्ट्रेशन - 115/25-86

:- तकनीकी प्रतिवेदन :-

प्रस्तुत प्राक्कलन मो० 99,90,500.00/- (निधानवे लाख नब्बे हजार पाँच सौ रुपये मात्र) का 15वीं वित्त आयोग की राशि से मधेपुरा पुरानी बस स्टैंड के पूरब का बाये भाग में 17 दुकान का निर्माण हेतु तैयार किया गया है।

प्राक्कलन के वर्णित दर अद्यतन BCD SOR 2022 के आधार पर तैयार किया है। इस योजना के पूर्ण होने से जिला परिषद मधेपुरा के राजस्व में वृद्धि होगा।

मधेपुरा जिला अंतर्गत पुरानी बस स्टैंड के पूरब का बाये भाग की तरफ पुराने जर्जर बस पड़ाव को तोड़कर स्थल पर दुकान का निर्माण किया जाना है। जिसका कुल औसत क्षेत्रफल (लग्नाई X चौड़ाई ल०-19.983 मी० X चौ०-32.26 मी०) है।

प्राक्कलन के अनुसार 17 दुकान का निर्माण कराया जाना है, जिसमें सभी दुकान जिसकी (लग्नाई X चौड़ाई ल०-3.05 मी० X चौ०-3.65 मी०) है। (इकाई की ल०-10 फीट, चौ०-12 फीट है)

Nish Kumar
16-02-2026

Junior Engineer

Zila Parisad, Madhepura

Signature

Assistant Engineer

Zila Parisad, Madhepura

Signature
16/02/2026

District Engineer

Zila Parisad, Madhepura

Nikhil Kumar
16-02-2026

<p>GENERAL NOTES:-</p> <p>1. The drawing is prepared by the Architectural Consultant for the purpose of providing a visual representation of the proposed development. It is not to be used for any other purpose without the written consent of the Architectural Consultant.</p> <p>2. The drawing is prepared on the basis of the information provided by the client. The Architectural Consultant does not accept any liability for any errors or omissions in the drawing.</p> <p>3. The drawing is prepared in accordance with the standards and specifications of the Architectural Association of India.</p> <p>4. The drawing is prepared in accordance with the standards and specifications of the Indian Standards.</p> <p>5. The drawing is prepared in accordance with the standards and specifications of the Indian Standards.</p> <p>6. The drawing is prepared in accordance with the standards and specifications of the Indian Standards.</p>		<p>GENERAL SPECIFICATIONS:-</p> <p>1. The drawing is prepared in accordance with the standards and specifications of the Architectural Association of India.</p> <p>2. The drawing is prepared in accordance with the standards and specifications of the Indian Standards.</p> <p>3. The drawing is prepared in accordance with the standards and specifications of the Indian Standards.</p> <p>4. The drawing is prepared in accordance with the standards and specifications of the Indian Standards.</p> <p>5. The drawing is prepared in accordance with the standards and specifications of the Indian Standards.</p> <p>6. The drawing is prepared in accordance with the standards and specifications of the Indian Standards.</p>	
<p>DEPARTMENT:-</p> <p>ZILA PANCHAYAT BUDHAPURA</p>		<p>PROJECT:-</p> <p>SHOP AT DUB STAND JAMUN ETAPDA</p>	
<p>AREA STATEMENT:-</p> <p>DATE: 16-02-2026</p> <p>DRAWN BY: NIKHIL KUMAR</p>		<p>SHEET TITLE:-</p> <p>SECTION: SECTION 1</p>	
<p>DATE:-</p> <p>16-02-2026</p>		<p>SCALE:-</p> <p>1:100</p>	
<p>STATUS:-</p> <p><input checked="" type="checkbox"/> APPROVED <input type="checkbox"/> REJECTED <input type="checkbox"/> UNDER REVIEW</p>		<p>DATE:-</p> <p>16-02-2026</p>	
<p>UNIVERSITY/ COLLEGE:-</p> <p>W.P. CHANDELLOON PRINCIPAL</p>		<p>ARCHITECTURAL CONSULTANT:-</p> <p>NIKHIL KUMAR</p>	

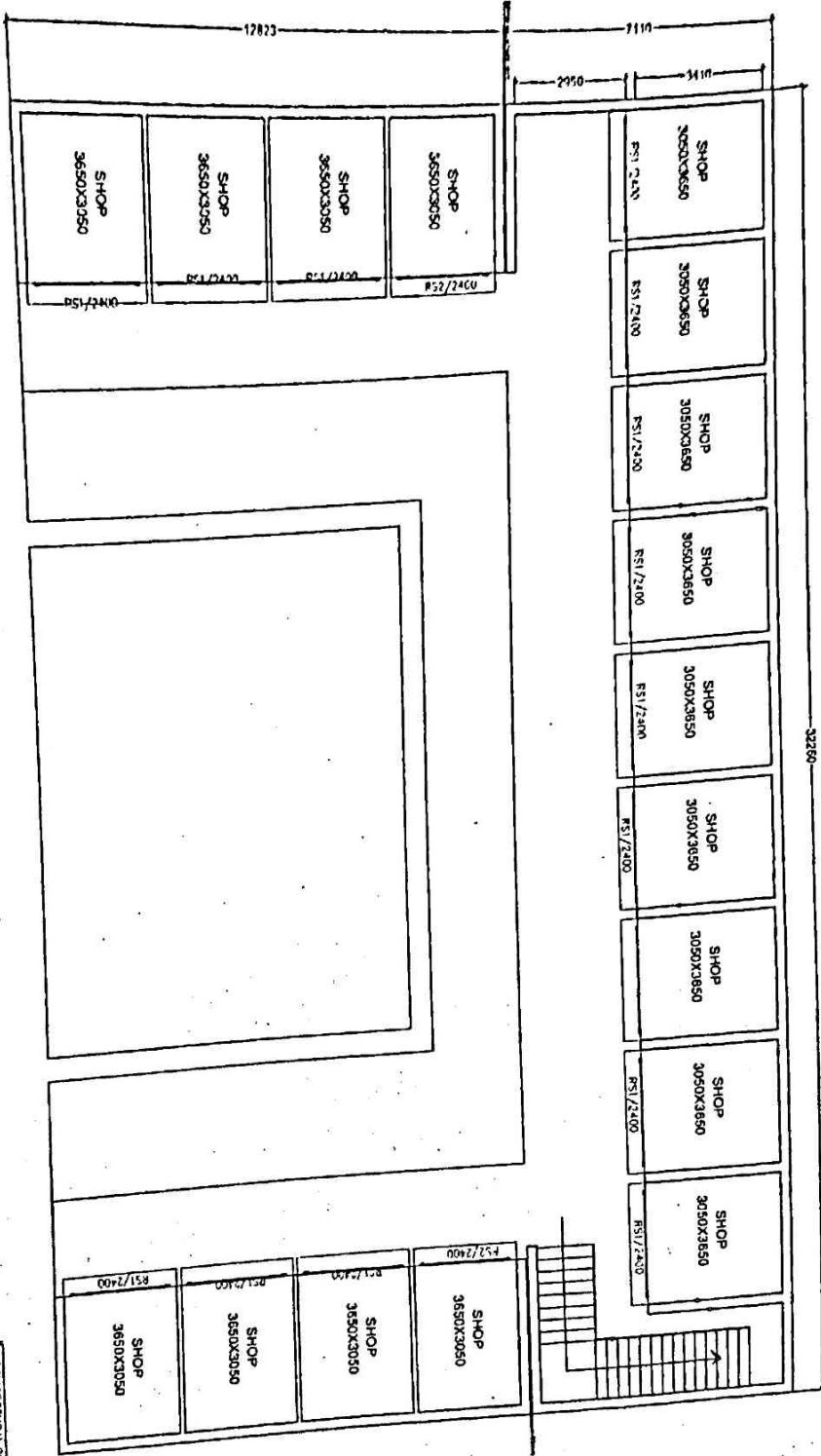

ZILA PARISHAD MADHEPURA

DETAILED ESTIMATE FOR

SOR-Ref
BCD 2022

PROPOSED COMMERCIAL BUILDING AT BUS STAND, MADHEPURA (BIHAR)

Item of Works	Nos	Length			Height	Quantity	Unit	Rate	Amount
		M	M	M					
CIVIL WORK									
EARTH WORK									
Site clearance do all comp job									
2.8	Earth work in excavation in foundation trenches or drains(not exceeding 1.5 m in width or 10 sqm on plan) including dressing of sides and ramming of bottoms, lift upto 1.5 m. Including getting out the excavated soil and disposal of surplus excavated soil as directed, within a lead of 50 m.								
2.8.1	All kinds of soil.								
F1									
Grade Beam	55	1.800	1.800	2.250		400.950	cum		
	1	267.630	0.250	0.450		30.108	cum		
Total Qty :				Total		431.058	cum		
2.21	Earthfilling								
Room	17	3.05	3.65	0.23		42.582	cum		
stair room	1	4.42	2.44	0.23		2.427	cum		
Verandaha	1	45.33	2.44	0.23		24.886	cum		
						69.895	cum		
2.28	Supplying and Filling in plinth with local sand and under floors including, watering, ramming consolidating and dressing complete.								
Foundation	55	1.80	1.80	0.25		44.55	cum		
								386.60	27,021.24

Nitesh Kumar

J.E

ZILA PARISHAD MADHEPURA

DETAILED ESTIMATE FOR

PROPOSED COMMERCIAL BUILDING AT BUS STAND, MADHEPURA (BIHAR)

SOR-Ref BCD 2022	Item of Works	Nos	Length M	Width M	Height M	Quantity	Unit	Rate	Amount
	Grade Beam								
	UNDER floor (along length)	1	267.63	0.25	0.08	5.02	cum		
	along width	2	32.260	7.110	0.350	229.369	cum		
	paver ground	1	13.070	6.860	0.350	179.320	cum		
	outer stair	1	25.40	12.82	0.15	48.84	cum		
			41.41	1.20	0.15	7.45	cum		
	Total Qty :				Total	514.56	cum		
11.72	Providing designation 100 A one brick flat soiling joints filled with local sand including cost of watering, taxes, royalty all complete as per building specification and direction of E.I.					514.56	cum	287.30	147831.67
	Foundation								
	Grade Beam	55	1.800	1.800		178.200	sqm		
	UNDER floor (along length)	1	267.630	0.250		66.908	sqm		
	along width	2	32.260	7.110		229.369	sqm		
	outer stair	1	13.070	6.860		179.320	sqm		
			41.41	1.20		49.692	sqm		
	Total Qty :					703.49	sqm		
	CEMENT CONCRETE WORK & REINFORCED CEMENT CONCRETE WORK							283.30	1,99,298.29
	Providing and laying in position cement concrete of specified grade excluding the cost of centing and shuttering-all work upto plinth level.								
4.1.3	1:2:4(1 Cement: 2 coarse sand: 4 graded stone aggregate 20 mm nominal size) m15								
	Foundation	55	1.800	1.800	0.125	22.275	cum		
	UNDER floor (along length)	1	32.260	7.110	0.150	34.405	cum		
	along width	2	13.070	6.860	0.150	26.898	cum		
	outer stair	1	41.41	1.20	0.150	7.454	cum		

Nish Kumar
J.E

(86)

ZILA PARISHAD MADHEPURA

DETAILED ESTIMATE FOR

PROPOSED COMMERCIAL BUILDING AT BUS STAND, MADHEPURA (BIHAR)

SOR-Ref BCD 2022.	Item of Works	Nos	Length			Height	Quantity	Unit	Rate	Amount
			M	M	M					
	Total Qty :					Total	91.03	cum	3998.10	3,63,955.64
	PLINTH PROTECTION									
4.17	Making plinth protection 50 mm thick of cement concrete 1:3:6 (1 cement : 3 coarse sand : 6 graded stone aggregate 20 mm nominal size) over 75 mm thick bed of dry brick ballast 40 mm nominal size, well rammed and consolidated and grouted with fine sand, including finishing the top smooth.									
	GR. FLOOR									
	building perimeter	1.0	102.000	0.900			91.80	sqm		
	TOTAL						91.80	sqm	436,600	40,080.00
	Total Qty :									
4.11	Providing and laying damp-proof Course 50 mm thick with cement concrete 1:2:4 (1 cement : 2 coarse sand : 4 graded stone aggregate 20mm nominal size)									
	DPC									
	Grade Beam	1.00	267.63	0.25			66.91	sqm		
	Total						66.91	sqm	245,60	16,432
	Total Qty :									
5.1	Providing and laying in position specified grade of reinforced cement concrete excluding the cost of centring, shuttering, finishing and reinforcement-All work up to plinth level.									
5.1.1	1:1:2 (1 cement : 1 coarse sand : 2 graded stone aggregate 20 mm nominal size) M25									
	Foundation	55	1.800	1.800		0.600	106.920	cum		
	FT-1					Total	106.920	cum	5961.90	6,37,446.35

Nishith Kumar
J.E

J.E

ZILA PARISHAD MADHEPURA

DETAILED ESTIMATE FOR

PROPOSED COMMERCIAL BUILDING AT BUS STAND, MADHEPURA (BIHAR)

SOR+Ref BCD 2022	Item of Works	Nos	Length			Height	Quantity	Unit	Rate	Amount
			M	M	M	M				
5.2	Reinforced cement concrete work in wall (any thickness), including attached pilasters, buttresses, plinth and string courses, fillers, columns, pillars, piers, abutments, posts and struts, etc. up to floor five level excluding cost of centring, shuttering, finish and reinforcement.									
5.2.1	1:1:2(1 cement 1 coarse sand:2 graded stone aggregate 20 mm nominal size)									
	column	55	0.250	0.450	5.000		30.938	cum		
	masonry room column extend	4	0.250	0.450	2.000		0.900	cum		
	Total Qty				Total		31.838	cum	6943.50	2,21,064.00
5.3+5.33B, 1+5.33B.4	Reinforced cement concrete work in beams, suspended floors, roofs having slope upto 15%, landings, balconies, shelves, chajjas, lintels, bands, plain window sills, staircases and spiral stair cases upto floor five level excluding the cost of centring, shuttering, finishing and reinforcement with 1:2:4(1 cement:2 coarse sand:4 graded stone aggregate 20 mm nominal size). Providing M-15 grade R.C.C instead of M-20 grade R.C.C+Providing M-25 grade R.C.C instead of M-20 grade+ Providing M-20 grade R.C.C instead of M-15 grade									
	GROUND FLOOR ROOF BEAM									
	Grade Beam	1	267.630	0.250	0.450		30.108	cum		
	Lintel Beam	1	267.630	0.250	0.250		16.727	cum		
	slab Beam	1	267.630	0.250	0.450		30.108	cum		
	Plinth Band	1	267.630	0.250	0.100		6.691	cum		
	slab	1	46.900	5.420	0.125		31.775	cum		
		1	28.340	3.590	0.125		12.718	cum		
	STAIR (waist slab)	1	10.300	1.220	0.180		2.262	cum		
	masonry room slab	1	3.440	5.420	0.125		2.331	cum		
	Total Qty				Total		132.719	cum	5884.20	7,80,946.00
5.22	Reinforcement for R.C.C. work including straightening, cutting, bending, placing in position and binding as complete.									
	RCC Work		kg/cum	Vol cum	KG	16 MM	12 MM	8MM		

Nitesh Kumar
J.E

J.E

DETAILED ESTIMATE

anner



ZILA PARISHAD MADHEPURA

DETAILED ESTIMATE FOR

PROPOSED COMMERCIAL BUILDING AT BUS STAND, MADHEPURA (BIHAR)

SOR-Ref BCD 2022	Item of Works	Nos	Length M	Width M	Height M	Quantity	Unit	Rate	Amount
	STAIR (waist slab)	1	10.30	1.22		12.566	sqm		
	masonry room slab	1	3.44	5.42		18.6448	sqm		
	Total Qty. :				Total	387.149	sqm	437.50	1,69,378.00
5.9.5	Centring and shuttering including strutting, propping etc. and removal of form for. Lintels, beams, plinth beams, girders, bressumers and cantilevers.								
	Grade Beam	1	267.6		0.900	240.867			
	Lintel Beam	1	267.6		0.500	133.815			
	slab Beam	1	267.6	0.250	0.900	307.7745			
	Plinth Band	1	267.6		0.200	53.526			
	Total Qty. :				Total	735.983	sqm	404.70	2,97,852.00
5.9.6	Centring and shuttering including strutting, propping etc. and removal of form for. Columns, Piers, Piers, Abutments, Posts and Struts								
	column	55	0.25	0.45	5.00	385.000	sqm		
	masonry room column extend	4	0.25	0.45	2.00	11.200	sqm		
	Total Qty. :				Total	396.200	sqm		
5.9.7	Centring and shuttering including strutting, propping etc. and removal of form for Stairs, (excluding landings) except spiral staircases.					396.200	sqm	494.40	1,95,881.00
	ground floor stair-1								
	landing	1	1.200	2.440		2.928	sqm		
	waist slab	2	2.900	1.500		8.700	sqm		
	steps (riser)	46	1.200		0.150	8.280	sqm		
	Total Qty. :				Total	19.908	sqm	439.90	8,758.00

Nish Kumar
JE

Jen

(2)

ZILA PARISHAD MADHEPURA

DETAILED ESTIMATE FOR

PROPOSED COMMERCIAL BUILDING AT BUS STAND, MADHEPURA (BHAR)

SOR-Ref	Item of Works	Nos	Length	Width	Height	Quantity	Unit	Rate	Amount
BCD 2022.	Brick work with bricks of class designation 100A in foundations and plinth in (Fly Ash) :								
6.1A	Cement mortar 1:5 (1 cement: 6 coarse sand)								
3C		1	95.880	0.250	0.900	21.573	cum		
		1	43.890	0.250	0.900	9.875	cum		
6.1.14C+6.	Cement mortar 1:5 (1 cement: 6 coarse sand) above plinth level upto floor v								
3C		1	72.360	0.250	3.350	60.602	cum		
		4	21.900	0.250	3.350	73.365	cum		
		-17	3.050	3.350	0.125	-21.712	cum		
					Total Qty :	143.703	cum	5765.20	8,28,474.01
	DOOR								
	Supplying and fixing rolling shutters of approved make, made of required size of M.S. laths inter locked together through their entire length and jointed together at the end by end locks mounted on specially designed pipe shaft with brackets, side guides and arrangements for inside and outside locking with push and pull operation complete including the cost of providing and fixing necessary 27.5 cm long wire springs grade no. 2 and M.S. top cover of required thickness for rolling shutters.								
10.6.1									
10.6.3	80x0.90 mm thick M.S. laths with 0.90 mm thick top cover.								
	GROUND FLOOR	17	3.050		3.350	173.698	sqm	2673.70	4,64,415.01
	Shutter(RS)								
10.7	Providing and fixing ball bearing for rolling shutters								
	GROUND FLOOR	17	3.050		3.350	173.698	sqm		
	Shutter(RS)								
	TOTAL					173.698	sqm	424.20	73,692.48

Nish Kumar

J.E.

ZILA PARISHAD MADHEPURA

DETAILED ESTIMATE FOR

PROPOSED COMMERCIAL BUILDING AT BUS STAND, MADHEPURA (BIHAR)

SOR-Ref BCD 2022	Item of Works	Nos	Length M	Width M	Height M	Quantity	Unit	Rate	Amount
13.11	12 mm cement plaster								
13.11.4	1:4(1 cement :4 coarse sand)								
	Exterior wall	1	32.760	5.00		163.800	sqm		
		1	39.860	4.40		175.384	sqm		
	Interior	1	32.760	3.350		109.746	sqm		
		1	39.860	3.350		133.531	sqm		
	deduct for door area	-17	3.050	3.350		-173.698	sqm		
					TOTAL	408.764	sqm	152.90	62,499.94
	6 mm cement plaster ceiling								
	1:4(1 cement :4 coarse sand)								
	Slab	1	28.340	7.110		201.4974	sqm		
		2	12.820	6.860		175.8904	sqm		
					TOTAL	377.388	sqm	125.60	47,399.91
	FINISHING WORK								
13.80A.2	Providing and applying white cement based putty of average thickness 2 mm, of approved brand and manufacturer, over the plastered wall surface to prepare the surface even and smooth complete.								
						786.151	sqm	105.40	82,860.35
13.48	Finishing with Deluxe Multi surface paint system for interiors and exteriors using Primer as per manufacturers specifications.								
13.48.1	Two or more coats applied on walls @ 1.25 ltr/10 sqm over and including one coat of special primer applied @ 0.75 ltr/10 sqm.								
	From (13.80A.2)					786.151	sqm	117.30	92,215.55

Nishat Kumar
J.E

ZILA PARISHAD MADHEPURA

DETAILED ESTIMATE FOR

PROPOSED COMMERCIAL BUILDING AT BUS STAND, MADHEPURA (BIHAR)

SOR-Ref BCD 2022	Item of Works	Nos	Length M	Width M	Height M	Quantity	Unit	Rate	Amount
13.82.1	Painting with ready mixed paint of approved brand and manufacture in all shades to give an even shade; New steel work (two or more coats)								
	rolling shutter	two side 17	3.050			3.350 173.698	sqm sqm	83.50	14,503.74
11.41	Providing and laying vitified floor tiles in different sizes (thickness to be specified by the manufacturer) with water absorption's less than 0.08 % and conforming to IS : 15622 of approved make in all colours and shades, laid on 20 mm thick cement mortar 1:4 (1 cement: 4 coarse sand) including grouting the joint with white cement and matching pigments etc., complete.								
11.41.2	Size of Tile 60x60 cm								
	Ground Floor								
	Shop	17	3.050	3.650		189.253 189.253	sqm sqm		
	Total Qty:-					189.253	sqm	1638.80	3,10,147.00
11.79.1	Providing designation M35 grade 80mm thick c.c paver block do.. All complete with approved colour design and pattern	1	25.4	12.82		0.000	sqm	956.40	0.00
								TOTAL(A)	80,01,458.93
Calculation for material Statement									
	Item	Qty	Unit	cement	S Chips	Sand	Brick	L.Sand	steel
	Paver Block	0	sqm		cum	cum	nos	cum	
	Local sand filling	514.56	cum					514.56	
	BW250 mm 1:6	143.70	cum	179.63		38.44	70,989.00		
	BW125 mm 1:4	-	sqm	-		-	-		

Nitish Kumar
J.E

3

ZILA PARISHAD MADHEPURA

DETAILED ESTIMATE FOR

PROPOSED COMMERCIAL BUILDING AT BUS STAND, MADHEPURA (BIHAR)

SOR-Ref BCD 2022.	Item of Works	Nos	Length		Width		Height		Quantity	Unit	Rate	Amount
			M	M	M	M	M	M				
	PCC 1:2:4	91.03	cum	576.78	81.02	-	-	40.51	-	22,695.00	10.59	28,752.00
	RCC M 25	703.49	sqm	-	-	-	-	-	-	-	-	-
	Brick Flat Soling	-	sqm	-	-	-	-	-	-	-	-	-
	Stone/Tile Floor	-	sqm	-	-	-	-	-	-	-	-	-
	20 mm plaster 1:4	408.76	sqm	36.79	-	-	-	4.91	-	-	-	-
	12 mm plaster 1:4	377.39	sqm	13.21	-	-	-	2.26	-	-	-	-
	6 mm plaster 1:4	-	sqm	-	-	-	-	-	-	-	-	-
	Cement punning	Total	-	806.00	81.02	-	-	86.12	93,684.00	525.14	-	28,752.00
				40.30	ml	-	-	-	-	-	-	28.75
	Carriage of Materials											
	Bricks+ Paver (7+1 km)							93.684	Th.	886.60		83,060.00
	Stone Chips							81.019	cum	2716.91		2,20,120.00
	Coarse Sand							86.119	cum	2614.28		2,25,140.00
	Local Sand (2P+1K)							526.143	cum	264.41		1,38,853.00
	Cement(3P)							40.300	MT	126.38		5,093.00
	Steel (3P)							28.752	MT	126.38		3,634.00
	Extra cost of Material for Sharsa w.r.t Gaya							806.000	per Dag	8.93		7198.00
	Cement							93.684	Th.	468.95		43933.00
	Brick									SUM (B)		727031.00
										Total (A+B)		87,28,489.93
										SUB TOTAL (C)		91,96,336.99

Multiplying factor 1.0536 for 18% GST (instead of 12% GST as per BCD Analysis 2022)

Nish Kymmer
J.E

Bel

(3)

ZILA PARISHAD MADHEPURA

DETAILED ESTIMATE FOR

PROPOSED COMMERCIAL BUILDING AT BUS STAND, MADHEPURA (BIHAR)

SOR-Ref BCD 2022.	Item of Works	Nos	Length			Quantity	Unit	Rate	Amount
			M	M	M				
	Add seigniorage Charge								
	Bricks					95.801	Th.	526.70	50,158.00
	Stone Chips 20 mm					81.019	cum	59.54	4,824.00
	Coarse Sand					86.119	cum	17.58	1,514.00
	Local Sand					525.143	cum	14.19	7,452.00
							Total (D)		64,248.00
	Add Cost for Electrification (annexure attached)						TOTAL (C+D)		92,60,584.99
	Add signboard @ 2nos								7,19,897.00
							Sum(E)		10,000.00
							SUM(C+D+E)		99,90,481.99
							SAY(Rs.)		99,90,500.00

Nitish kumar
16-02-2026

[Signature]
16/2/26

Technical Approval for Rs. 99,90,500.00 (Rs. Ninty nine lakh Ninty thousand five hundred rupees only) payment will be made as per actual work done with approved SOR.

Nitish kumar
16-02-2026
J-E

[Signature]
16/2/26

प्रमाणित किया जाता है कि उपरोक्त कार्य का अनुमानित मूल्य रु. 99,90,500.00 है।
यह अनुमानित मूल्य वास्तविक कार्य के अनुसार बदल सकता है।
यह अनुमानित मूल्य केवल अनुमानित है।

D.D. 02/02/2026
Page 11 of 11

[Signature]
16/2/26

(3)

Page 1

ZILA PARISHAD OFFICE, MADHEPURA, BIHAR.

ABSTRACT OF COST OF ELECTRICAL WORK

INTERNAL ELECTRIFICATION OF COMMERCIAL BUILDING AT BUS STAND, MADHEPURA

Rates are based on SOR 2023 (w.e.f. 01.09.2023) for Electrical Works

Cost of B.O.Q. (In Rs.) :- 719897

Completion Period :-

WIRING

Sr. No.	SOR No.	ITEM OF WORK	UNIT	QUANTITY	RATE (In Rs.)	AMOUNT (In Rs.)
WIRING						
1	SOR 1.3.3 (C)	Wiring for light point / fan point / exhaust fan point / call bell point with 1.5 sq.mm FR PVC insulated copper conductor single core cable in surface recessed medium class PVC conduit, with modular switch, modular plate, suitable CI box and earthing the point with 1.5 sq. min. FR PVC insulated copper conductor single core cable etc as required. Group C	Point	150.00	1146.00	171900.00
2	SOR 1.24.1 1.24.4	Supplying and fixing 5 pin, 5/6 amps socket outlet and 5/6 amps Modular type switch connection etc up-on switch board, as required all complete as per instructions of Elec.Er. / Architect.	Set	15.00	194.00	2910.00
3	SOR 1.31	Supplying and fixing 1nos Modular type 6amp 5pin socket with 6amps switch, Modular Plate, suitable size PVC/G.I. box as required. all complete as per instructions of Elec.Er. / Architect.	Each	18.00	414.00	7452.00
4	SOR 1.32	Supplying and fixing 1nos Modular type 15amp 6 pin socket with 15Amps switch, Modular Plate, suitable size PVC/G.I. box as required. all complete as per instructions of Elec.Er. / Architect.	Each	18.00	531.00	9558.00
5	SOR 2.19	Supplying and fixing 20Amp 240 volts SPN MCB Industrial type, power socket with 25Amp SPN MCB and 25 Amps Top in proper size steel box and plate as required. all complete as per instructions of Elec.Er. / Architect.	Each	10.00	1513.00	15130.00

Page 1 of 5

(2)

Page 2

Sr. No.	SOR No.	ITEM OF WORK	UNIT	QUANTITY	RATE (In Rs.)	AMOUNT (In Rs.)
6	SOR 2.32	Supplying and fixing Cable end box (Loose wire box, IP43) suitable for following pole and neutral, sheet steel, MCB distribution board, 2401415 V, on surface /recess complete with testing and commissioning etc. as required.				
7	2.32.2	For 8/10 way, Double door SPN I/4CBDB	Each	12.00	798.00	9576.00
	SOR 2.12	Supplying and fixing following rating, 24A/415 volts, "C" curve, miniature circuit breaker suitable for inductive loads of following poles in the existing MCB DB complete with connections, testing and commissioning etc. as required				
i	2.12.L	6 A to 32'A, Single pole	Each	50.00	237.00	11850.00
ii	2.12.2	6 A to 32 A, SP&N	Each	12.00	606.00	7272.00
iii	2.12.5	40 A to 63 A, Single pole	Each	1.00	551.00	551.00
8	SOR 2.17.1	Supplying and fixing 25A rating, double pole, (single phase and neutral), 240 volts, residual current circuit breaker (RCCB), having a sensitivity current upto 300 milliamperes in the existing MCB DB complete with connections, testing and commissioning etc. as required.	Each	12.00	2131.00	25572.00
9	SOR 1.33	Supplying and fixing ceiling rose 2 pin gangs on existing junction box/ wooden block including connection etc. as required.	Each	10.00	064.00	640.00
10	SOR 1.34	Supplying and fixing brass/ angle holder on existing junction box/ wooden block including connection etc. as required.	Each	12.00	089.00	1068.00
11	SOR 1.23.9	Supplying and fixing stepped type electronic fan regulator on the existing modular plate/ switch box including connections but excluding modular plate etc. as required.	Each	12.00	311.00	3732.00
12	SOR 1.7	Writing for circuit/ submain wiring alongwith earth wire with the following sizes of FR PVC Insulated copper conductor, single core cable in surface/ recessed medium class PVC conduit as required.				
i	1.7.1	2x1.5 sq. Mm + 1x1.5 sq. Mm earth wire	Metre	50.00	327.00	16350.00
ii	1.7.2	2x2.5 sq. Mm + 1x2.5 sq. Mm earth wire	Metre	50.00	369.00	18450.00
iii	1.7.3	2x4sq. Mm + 1x4 sq. Mm earth wire	Metre	80.00	428.00	34240.00
iv	1.7.4	2x6sq. Mm + 1x6 sq. Mm earth wire	Metre	150.00	589.00	88350.00
		L.T. LINE CONTROL PANEL-125A TPN				

Nish Kumar

Nish

Page 2 of 5

(3)

Page 3

Sr. No.	SOR No.	ITEM OF WORK	UNIT	QUANTITY	RATE (In Rs.)	AMOUNT (In Rs.)
13	SOR 2.5.4	Providing and fixing 300amps capacity busbar chamber with 4 strips of suitable size made of copper, heavy duty, complete with all accessories including connections, earthing the body etc. as required.	Each	1.00	12883.00	12883.00
14	SOR 2.4.5	Providing and fixing 250A, rating and 36 kabreaking capacity MCCB (TPN) in made of existing 1.6mm thick sheet steel enclosure duly painted with powder coating, wall straps, cubicle panel board including drilling holes in cubicle panel, making connections etc. as required.	Each	1.00	18646.00	18646.00
15	SOR 2.7.7	Providing and fixing 250A capacity four pole ON-load panel mounted changeover switches inside the existing cubical panel board including drilling holes in cubicle panel, making connections etc. as required.	Each	1.00	21415.00	21415.00
16	SOR 2.12.2	Supplying and fixing 32A rating, 220 volts, SPN "C" curve, miniature circuit breaker suitable for inductive loads of two poles in the existing panel complete with connections, testing and commissioning etc. as required.	Each	18.00	606.00	10908.00
17	SOR 8.10.4	Supply and fixing digital voltmeter, three phase in the existing cubical panel board including drilling holes in the panel board, making connection etc as required.	Each	1.00	1337.00	1337.00
18	SOR 8.1.3	Supply and fixing panel mounted digital multimeter (Voltmeter & ammeter) including CT coil and RYB pilot indicator in the existing cubical panel board including drilling holes in the panel board making connections etc as required.	Each	1.00	6536.00	6536.00
19	SOR 2319	Providing and fixing selector switch for analog ammeter as per require load in amps on front side in excluding cubical panel as required.	Each	3.00	091.00	273.00
20	SOR 2318	Providing and fixing Pilot lamp for indicator on front side in excluding cubical panel as required.	Each	1.00	0.214.00	214.00
21	SOR 2.20	Providing and fixing M.V danger notice plate of 200mmx150mm made of mild steel at least 2mm thick vitreous enamel white on both side and with inscription in singleread colour on front side in excluding cubical panel as required.	Each	1.00	0.214.00	214.00

Which Kumar

Hsu

Page 3 of 5

(3)

Page 4

Sl. No.	SOR No.	ITEM OF WORK	UNIT	QUANTITY	RATE (In Rs.)	AMOUNT (In Rs.)
22	SOR 2.20	Providing and fixing wall mounting iron sheet cubical panel board, fabricated with 16 SWG gauge iron sheet, suitable size for panel mounted disconnector, including, busbar chamber, insulator, nut-bolt and painting etc. as per require. size made 5' 0" x 4' 0" x 12" = 20 SQ. FT. X 1 No.	SQ. FT	10.00	2,261.00	22610.00
23	S.O.R 3.13	SUPPLY & MAKING OF EARTHPIITS Providing chemical/mineral maintenance free earthing system comprising of copper coated earth electrode 3 metre length and 17.2 mm outer dia along with 25 kg earth conductivity enhancing back fill mineral compound for earth inspection pit etc. as required. OR Supply, Fixing & Hole cutting in earth as per drawing of (CU) (600mm X 300mm X 3mm) plate electrode earth, all complete as per specifications and drawings attached (1No. EARTH for UPS Main neutral only.) -The rate shall be inclusive of submission of TEST REPORT (2 Ohm) of each earth pit. -Caution Note -The rate shall be inclusive of submission of TEST REPORT (2 Ohm) of each earth pit and TESTING shall be carried out in front of Officials / Consultant	Each	2.00	16675.00	33350.00
24	SOR 3.17	Supplying and fixing 4.00 mm dia copper wire on surface or in recess for loop earthing etc. as required.		33.00	144.00	4752.00
25	8.15 SOR	SUPPLY OF FIXTURES & FANS Supply and installation of regular/standard model A.C. ceiling fan of 1200 mm sweep with service value (CM/MM) minimum 4.00, Air delivery minimum 270 cum/min including wiring the down rods of standard length (upto 30 cm) with 1.5 sq. mm FRLS PVC insulated copper conductor etc as required.	Each	18.00	2482.00	44676.00
26	6.1.4 SOR	Supplying and fixing of 9/10 watt LED lamp types lamp in the existing electrical fitting/ fixtures etc. as required	Each	18.00	3670.00	66060.00
		SUPPLY & LAYING MAIN & SUBMAIN OF CABLE)				

Atish Kumar

KS

Page 4 of 5

(23)

Page 5

Sr. No.	SOR No.	ITEM OF WORK	UNIT	QUANTITY	RATE (In Rs.)	AMOUNT (In Rs.)
27	SOR 7.7	Supply of following sizes and core PVC/XLPE insulated, PVC sheathed (heavy duty) armoured electrical power cable with aluminium conductor for working voltage upto 1.1 KV as required.	Metre	40.00	950.00	38000.00
28	7.7.11	95 sq. mm, 3.5 core				
	SOR 7.1	Laying of one number PVC insulated and PVC sheathed / XLPE power cable of 1.1 KV grade of following size direct in ground including excavation, sand cushioning, protective covering and refilling the trench etc. as required.				
	7.1.2	Above 35 sq. mm and upto 95 sq. mm	Metre	40.00	326.00	13040.00
				Total (A) =		719897.00

Mish Kumar
3.E

8/11